

RECEIVED

MAR 13 1951
STATE ENGINEER
SALEM, OREGON

REGISTRATION NO. GR-399
CERTIFICATE NO. 513

Registration Statement

OF CLAIMANT OF RIGHT TO APPROPRIATE GROUND WATER

(Under Chapter 708, Oregon Laws 1955.)

TO THE STATE ENGINEER OF OREGON:

I, Lloyd O. Edmiston
of Hillsboro County of Washington
State of Oregon, do hereby make application for a certificate of registration as evidence of a right to appropriate ground water.

- 1. Source from which water is withdrawn is Pump Well
- 2. Location is: 3 mi. South 1/4 East Hillsboro Oregon
(Approximate distance and direction from nearest city or town)

and is more particularly described as follows:

(a) 17 chains 40 ft East from N.E. Corner N.C. Richardson
(Give distance and bearing to corner of section or other legal subdivision) D.L.C. #63
being within NW 1/4 of SE 1/4 of Sec. 18, Twp. 15, Rge. 2 W.
(Smallest legal subdivision) (N. or S.) (E. or W.)
or (b), within limits of recorded platted property, town or city: C

in Lot _____, Block _____ of _____
(Name of plat or addition)
County of _____
(If within city or town, give name)

- 3. Construction Work was begun on Aug 1951; was completed on Aug 31 1951
(Date) (Date)

and the ground water claimed was first used for the purposes set out below on April 1952
(Date)
since which time the water has been used Continuously
(Continuously or Intermittently)
from April 1952 to March 1955
(Date) (Date)

- 4. Quantity of water claimed and used is _____ gallons per minute; _____ acre feet per year.
- 5. Purpose or Purposes for which water is used irrigation farm
(Domestic, irrigation, municipal, manufacturing, industrial, etc.) water for Orchard

6. Description of Well: Depth 52 feet. Type Drilled
(Dug or drilled)
diameter 6 inches. Elevation of ground at well site 178 feet, mean sea level.
(As near as known)
Depth to water table _____ feet.

- 7. Capacity of Well: 51 g.p.m. with 24 feet drawdown,
_____ g.p.m. with _____ feet drawdown.

Date of test _____
If Flowing Well: Measured discharge _____ g.p.m. on _____ (Date)
Shut-in pressure at ground surface _____ lbs. per sq. in. on _____ (Date)
Water is controlled by _____
(Cap, valve, etc.)

8. Casing: (Give diameter, commercial specifications and depth below ground surface of each casing size.)

8 inch diameter from 0 to 5.2 feet
..... inch diameter from to feet
..... inch diameter from to feet
..... inch diameter from to feet

Describe and show depth of shoe, plug, adapter, liner or other details: ○

9. Perforated Casings or Screens:

2 - 4 x 10 in every 4 ft from 20 to 50
(Number per foot and size of perforations, or describe screen)
..... from to
..... from to
..... from to

10. Log of Well: (Describe each stratum or formation clearly, indicate if water bearing, and give thickness and depth as indicated.)

MATERIAL	Thickness (Feet)	Depth to Bottom (Feet)
light-colored loam <u>1/6</u>	<u>20 ft</u>	<u>52</u>
Sand at 20 ft		
Blue clay 22 to 50 ft		
than Sand (black)		
Blue turns white when dry <u>○</u>		

If log of well is not available, give name and address of driller.

Banks Oregon

Perkins (incl. V. Chas)

11. Infiltration Trench: Covered or open

Dimensions: Length ft. Minimum depth ft. Maximum depth ft.

Bottom width ft. Discharge g.p.m. Date of test

12. Tunnel: Type of lining

Dimensions:
(Length, course, and cross sectional size)

Position of water bearing stratum with reference to portal of tunnel

Log of tunnel: (Preceding table for log of well may be used, if desired. Give footage from portal and character of materials, as pertinent.)

13. Pumping Equipment:

(a) Pump *3 H. Flow Banks Morse Jet Pump* Capacity *50* g.p.m.
(Make, type and size)

(b) Motor *3 Horse Single Phase*
(Type and horsepower)

14. Location of area irrigated or to be irrigated, or place of use if for purposes other than irrigation.

Township, North or South	Range E. or W. of Willamette Meridian	Section	Forty-acre Tract	Number Acres To Be Irrigated	Date of Reclamation
<i>18, 1 S.</i>	<i>2 W.</i>	<i>18</i>	<i>[Redacted]</i>	<i>[Redacted]</i>	<i>1952</i>
<i>1 S</i>	<i>2 W</i>	<i>18</i>	<i>NW 1/4 of SE 1/4</i>	<i>7</i>	<i>"</i>
<i>"</i>	<i>"</i>	<i>18</i>	<i>NE 1/4 of SW 1/4</i>	<i>6</i>	<i>"</i>
<i>"</i>	<i>"</i>	<i>18</i>	<i>SE 1/4 of SW 1/4</i>	<i>3</i>	<i>"</i>
<i>"</i>	<i>"</i>	<i>18</i>	<i>SW 1/4 of SE 1/4</i>	<i>2.3</i>	<i>"</i>
				<i>18.3 Total</i>	
			<i>5 acres sold</i>		

15. If the ground water supply is supplemental to an existing water supply, identification of any application for a permit, permit, certificate or adjudicated right to appropriate water made or held by the registrant.

See 18

Township 1 S Range 2 W W.M. North

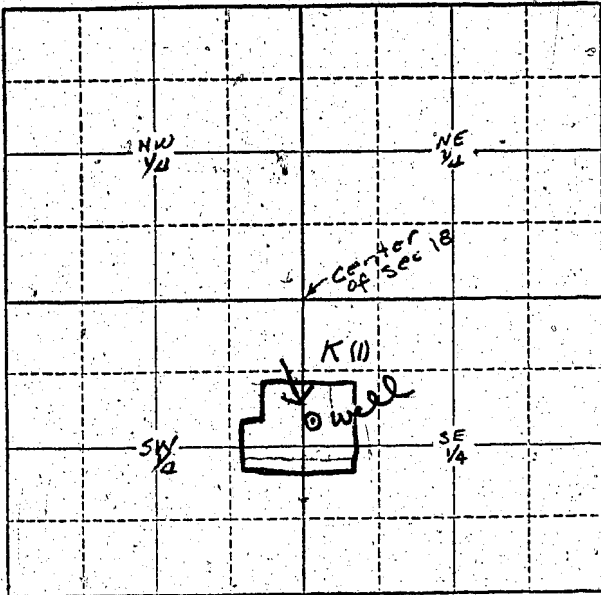

Co Engineer made these notations 18.3 acre is in part of 4 different quarters Ammonium in each 1/4 pretty hard to figure out

Locate well and acreage of irrigated land on plat.
 Scale: 2" = 1 Mile

STATE OF OREGON }
 County of Washington } ss.

I, Floyd O. Edmister, being first duly sworn, do hereby certify that I have read the foregoing Registration Statement and that all of the items therein contained are true to the best of my knowledge and belief.

Floyd O. Edmister
 (Signature of Registrant)

Subscribed and sworn to before me this 15th day of June, 1957

My commission expires 10/7/60
Howard Davis
 (Notary Public)

(SEAL)

CERTIFICATE OF REGISTRATION

STATE OF OREGON }
 County of Marion } ss.

This is to certify that the foregoing Registration Statement was received in the office of the State Engineer on the 18th day of March, 1957, at 8:00 o'clock A. M. and has been duly recorded in said office in Book No. 3 of Registration Statements on page GR-513 C

~~Construction shall be completed by X-X-X-X-X-X-X-X-X-X-X-X and the water completely applied to the land by X-X-X-X-X-X-X-X-X-X-X-X~~

Witness my hand this 24th day of July, 1957

Lewis A. Stanley
 (State Engineer)

\$15.00

By _____ (Deputy)