

Registration Statement

OF CLAIMANT OF RIGHT TO APPROPRIATE GROUND WATER

TO THE STATE ENGINEER OF OREGON:

I, The United States National Bank of Portland, Trustee
of Trust Dept., P. O. Box 4410, Portland 8, Oregon County of Multnomah
(Mailing address)
State of Oregon, do hereby make application for a certificate of registration as evidence of a right to appropriate ground water.

1. Source from which water is withdrawn is pump well
(Flowing well, pump well, infiltration trench, or tunnel)
2. Location is: Approximately 4 miles West of Beaverton, Oregon
(Approximate distance and direction from nearest city or town)

and is more particularly described as follows:

(a) Approximately 950' W and 720' S of Sec. corner Common to Sec. 23, 24, 25 & 26 in
(Give distance and bearing to corner of section or other legal subdivision)
being within NE 1/4 of NE 1/4 of Sec. 26, Twp. 1 S, Rge. 2 W W.M.
(Smallest legal subdivision) (N. or S.) (E. or W.)

or (b) within limits of recorded platted property, town or city: _____
in Lot _____, Block _____ of _____
(Name of plat or addition)
County of Washington
(If within city or town, give name)

3. Construction Work was begun on unknown; was completed on unknown
(Date) (Date)
and the ground water claimed was first used for the purposes set out below on unknown 1918?
(Date)
since which time the water has been used continuously
reportedly 40 years or more (Continuously or intermittently)
from _____ to _____
(Date) (Date)

4. Quantity of water claimed and used is 20-25 gallons per minute; --- acre feet per year.

5. Purpose or Purposes for which water is used irrigation ~~and~~ (exempt)
(Domestic, irrigation, municipal, manufacturing, industrial, etc.)

6. Description of Well: Depth 400 feet. Type Drilled
(Dug or drilled)
diameter unknown inches. Elevation of ground at well site unknown feet, mean sea level.
(As near as known)
Depth to water table unknown feet.

7. Capacity of Well: 60-25 g.p.m. with --- feet drawdown.
--- g.p.m. with --- feet drawdown.

Date of test ---

If Flowing Well: Measured discharge --- g.p.m. on ---
(Date)

Shut-in pressure at ground surface --- lbs. per sq. in. on ---
(Date)

Water is controlled by ---
(Cap, valve, etc.)

Township 15 Range 2 W W.M.
North

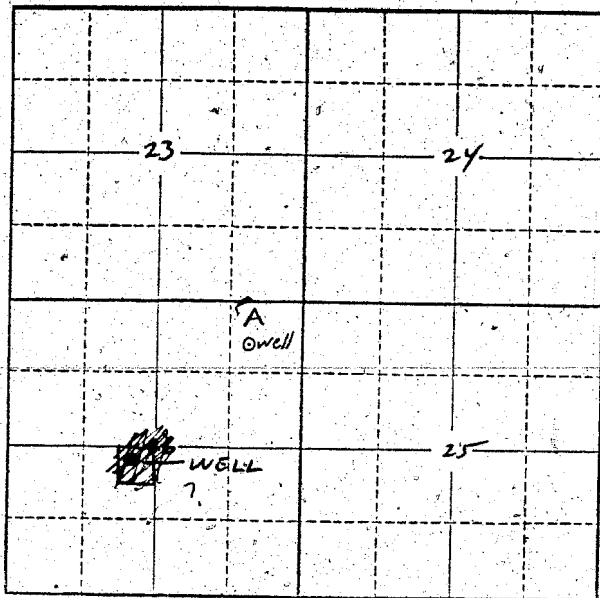

Locate well and acreage of irrigated land on plat.
Scale: 2" = 1 Mile

STATE OF OREGON

County of MULT. } ss.

I, J. A. LABROIC, being first duly sworn, do hereby certify that I have read the foregoing Registration Statement and that all of the items therein contained are true to the best of my knowledge and belief. The United States National Bank of Portland, Trustee.

[Signature]
(Signature of Registrant)

Subscribed and sworn to before me this 2ND day of SEPTEMBER, 1955

ASST. TRUST OFFICER

My commission expires Sept. 7, 1961

[Signature]
(Notary Public)

(SEAL)

CERTIFICATE OF REGISTRATION

STATE OF OREGON } ss.
County of Marion

This is to certify that the foregoing Registration Statement was received in the office of the State Engineer on the 4 day of August, 1955, at 8:00 o'clock A.M. and has been duly recorded in said office in Book No. 15 of Registration Statements on page GR-3599

Witness my hand this 15th day of September, 1959

\$15.00

[Signature]
(State Engineer)

By _____ (Deputy)

GR 3599