

Registration Statement

OF CLAIMANT OF RIGHT TO APPROPRIATE GROUND WATER

TO THE STATE ENGINEER OF OREGON:

I, C. C. LAMB

of Rt. 3, Box 344, Canby County of Clackamas

State of OREGON, do hereby make application for a certificate of registration as evidence of a right to appropriate ground water.

1. Source from which water is withdrawn is Pump Well
(Flowing well, pump well, infiltration trench, or tunnel)

2. Location is: 1 mile north of Canby
(Approximate distance and direction from nearest city or town)

and is more particularly described as follows:

(a) N 48° 15' E, 1235 feet from SW corner of Section 28
(Give distance and bearing to corner of section or other legal subdivision)

being within SW 1/4 SW 1/4 of Sec. 28, Twp. 35, Rge. 1E
(Smallest legal subdivision) (N. or S.) (E. or W.)

or (b) within limits of recorded platted property, town or city:

in Lot _____, Block _____ of _____
(Name of plat or addition)

County of _____
(If within city or town, give name)

3. Construction Work was begun on Drilled about 35 years ago by previous owner 1928
(Date) (Date)

and the ground water claimed was first used for the purposes set out below on 1928
(Date)

since which time the water has been used Continuously by present owner
(Continuously or intermittently)
from 1928 to Present
(Date) (Date)

4. Quantity of water claimed and used is 240 gals. gallons per minute; _____ acre feet per year.

5. Purpose or Purposes for which water is used Domestic (3 families) live stock irrigation
(Domestic, irrigation, municipal, manufacturing, industrial, etc.)

6. Description of Well: Depth 117 feet. Type Drilled
(Dug or drilled)
diameter 6 inches. Elevation of ground at well site 151 feet, mean sea level.
(As near as known)

Depth to water table 80 feet.

7. Capacity of Well: Unknown g.p.m. with _____ feet drawdown.
_____ g.p.m. with _____ feet drawdown.

Date of test _____

If Flowing Well: Measured discharge _____ g.p.m. on _____
(Date)

Shut-in pressure at ground surface _____ lbs. per sq. in. on _____
(Date)

Water is controlled by _____
(Cap, valve, etc.)

If log of well is not available, give name and address of driller. Unknown

11. Infiltration Trench: Covered or open _____
Dimensions: Length _____ ft. Minimum depth _____ ft. Maximum depth _____ ft.
Bottom width _____ ft. Discharge _____ g.p.m. Date of test _____

12. Tunnel: Type of lining _____
Dimensions: _____
(Length, course, and cross sectional size)
Position of water bearing stratum with reference to portal of tunnel _____

Log of tunnel: (Preceding table for log of well may be used, if desired. Give footage from portal and character of materials, as pertinent.)

13. Pumping Equipment:
(a) Pump Peerless High lift Capacity 40 g.p.m.
(Make, type and size)
(b) Motor Single Phase 2 H.P.
(Type and horsepower)

14. Location of area irrigated or to be irrigated, or place of use if for purposes other than irrigation.

Township North or South	Range E. or W. of Willamette Meridian	Section	Forty-acre Tract	Number Acres To Be Irrigated	Date of Reclamation
<u>35</u>	<u>1E</u>	<u>28</u>	<u>SW¹/₄ SW¹/₄</u>	<u>20</u>	<u>1928</u>

15. If the ground water supply is supplemental to an existing water supply, identification of any application for a permit, permit, certificate or adjudicated right to appropriate water made or held by the registrant.

Township 35 Range 15 W.M.
North

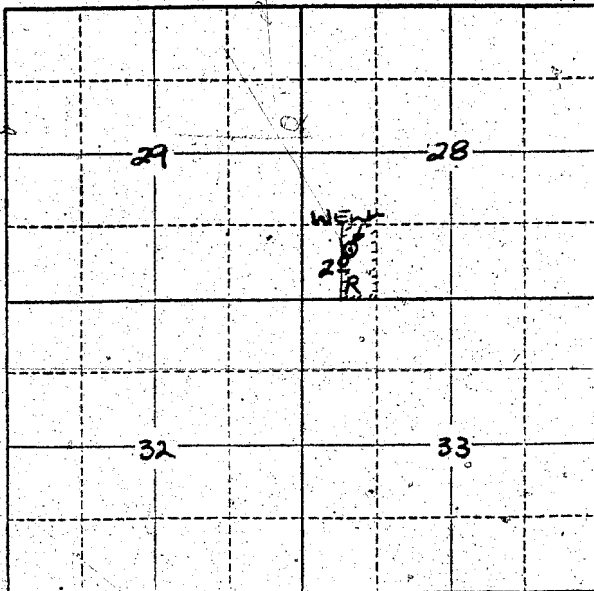

Locate well and acreage of irrigated land on plat.
Scale: 2" = 1 Mile

STATE OF OREGON

County of Clackamas

} ss.

I, C. C. Lamb, being first duly sworn, do hereby certify that I have read the foregoing Registration Statement and that all of the items therein contained are true to the best of my knowledge and belief.

C. C. Lamb
.....
(Signature of Registrant)

Subscribed and sworn to before me this 2 day of August, 1958

My commission expires July 22, 1961

[Signature]
.....
(Notary Public)

(SEAL)

CERTIFICATE OF REGISTRATION

STATE OF OREGON

County of Marion

} ss.

This is to certify that the foregoing Registration Statement was received in the office of the State Engineer on the 4 day of August, 1958, at 8:00 o'clock A.M. and has been duly recorded in said office in Book No. 15 of Registration Statements on page 3601

Witness my hand this 15th day of September, 1959

Lewis A. Standley
.....
(State Engineer)

By _____
(Deputy)

#15.00

GR. 3601