

Registration Statement

OF CLAIMANT OF RIGHT TO APPROPRIATE GROUND WATER

TO THE STATE ENGINEER OF OREGON:

I, Orlando S Arnold
of 1911 Boy 240 County of Mayion
(Mailing address)
State of Oregon do hereby make application for a certificate of registration as evidence of a right to appropriate ground water.

1. Source from which water is withdrawn is Pumped
(Flowing well, pump well, infiltration trench, or tunnel)
2. Location is: 9/10 Mile East of Hubbard Ore
(Approximate distance and direction from nearest city or town)

and is more particularly described as follows:
100 ft 50 ft East of N.W. corner of property
(a) 1690 feet east 250 feet South from Center of Section 34
(Give distance and bearing to corner of section or other legal subdivision)

being within NE 1/4 of S E 1/4 of Sec. 34 Twp. 45 Rge. 1W
(Smallest legal subdivision) (N. or S.) (E. or W.)

or (b) within limits of recorded platted property, town or city:
in Lot _____, Block _____ of _____
(Name of plat or addition)
County of _____
(If within city or town, give name)

3. Construction Work was begun on Aug 1954; was completed on Aug 1954
(Date) (Date)
and the ground water claimed was first used for the purposes set out below on Aug 1954 Home
since which time the water has been used Home, Live Stock, Garden + Irrigation
(Continuously or intermittently)
from Sept 1957 to July 5-8
(Date) (Date)

4. Quantity of water claimed and used is 25 gal gallons per minute; _____ acre feet per year.

5. Purpose or Purposes for which water is used Home, Live Stock, Garden + Berry Irrigation
(Domestic, irrigation, municipal, manufacturing, industrial, etc.)

6. Description of Well: Depth 68 feet. Type Drilled
(Dug or drilled)
diameter 6" inches. Elevation of ground at well site _____ feet, mean sea level.
(As near as known)
Depth to water table 30 feet.

7. Capacity of Well: _____ g.p.m. with _____ feet drawdown.
_____ g.p.m. with _____ feet drawdown.

Date of test _____

If Flowing Well: Measured discharge _____ g.p.m. on _____
(Date)

Shut-in pressure at ground surface _____ lbs. per sq. in. on _____
(Date)

Water is controlled by _____
(Cap, valve, etc.)

8. Casing: (Give diameter, commercial specifications and depth below ground surface of each casing size.)

6 inch diameter *steel casing* from 0 to 66 feet
 inch diameter from to feet
 inch diameter from to feet
 inch diameter from to feet

Describe and show depth of shoe, plug, adapter, liner or other details: _____

9. Perforated Casings or Screens:

40s (Number per foot and size of perforations, or describe screen) from *58* to *66*
 from to
 from to
 from to

10. Log of Well: (Describe each stratum or formation clearly, indicate if water bearing, and give thickness and depth as indicated.)

MATERIAL	Thickness (Feet)	Depth to Bottom (Feet)
0 to 6 Surface		
6-54 Sandy Clay		
54-63 54-63 Broken Clay		
63-64 Tough Blue Clay		
64-68 Gravel		

If log of well is not available, give name and address of driller. J.T. Miller

11. Infiltration Trench: Covered or open

Dimensions: Length ft. Minimum depth ft. Maximum depth ft.

Bottom width ft. Discharge g.p.m. Date of test

12. Tunnel: Type of lining

Dimensions: (Length, course, and cross sectional size)

Position of water bearing stratum with reference to portal of tunnel

Log of tunnel: (Preceding table for log of well may be used, if desired. Give footage from portal and character of materials, as pertinent.)

13. Pumping Equipment:

(a) Pump Jet Pump Capacity 25 g.p.m.
(Make, type and size)

(b) Motor 1 1/2 HP. Electric
(Type and horsepower)

14. Location of area irrigated or to be irrigated, or place of use if for purposes other than irrigation.

Township North or South	Range E. or W. of Willamette Meridian	Section	Forty-acre Tract	Number Acres To Be Irrigated	Date of Reclamation
<u>T. 45</u>	<u>R. 1W</u>	<u>34</u>	<u>NE 1/4 of SE 1/4</u>	<u>1.25 Ac</u>	<u>1954</u>

15. If the ground water supply is supplemental to an existing water supply, identification of any application for a permit, permit, certificate or adjudicated right to appropriate water made or held by the registrant.

Township 74S Range R1W W.M.

North

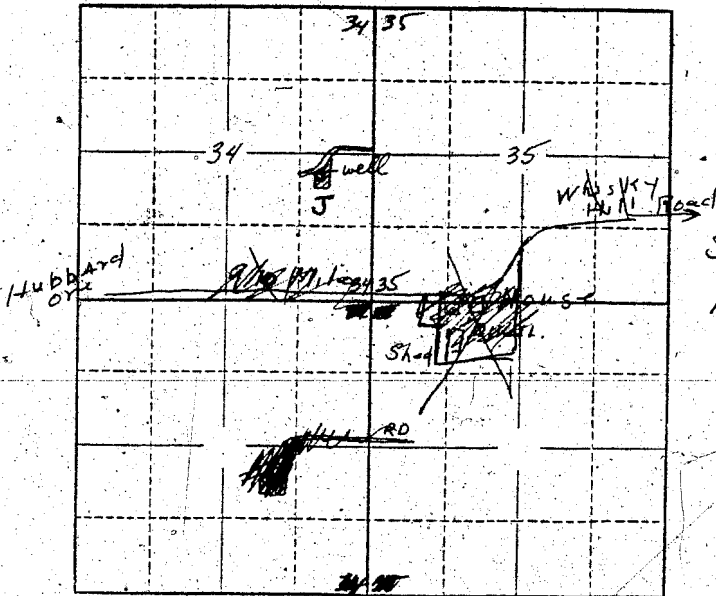

Locate well and acreage of irrigated land on plat.

Scale: 2" = 1 Mile

STATE OF OREGON

County of Marion } ss.

I, Orlando G. Arnold being first duly sworn, do hereby certify that I have read the foregoing Registration Statement and that all of the items therein contained are true to the best of my knowledge and belief.

Orlando G. Arnold
(Signature of Registrant)

Subscribed and sworn to before me this 30th day of July, 1958

My commission expires 12th June 1961 Wm. S. Bartholomew
(Notary Public)

(SEAL)

CERTIFICATE OF REGISTRATION

STATE OF OREGON } ss.
County of Marion

This is to certify that the foregoing Registration Statement was received in the office of the State Engineer on the 4th day of August, 1958 at 8:00 o'clock A. M. and has been duly recorded in said office in Book No. 15 of Registration Statements on page GR 3602

Witness my hand this 15th day of September, 1959

Levia A. D. [Signature]
(State Engineer)

By _____ (Deputy)

GR 3602

#15-22