

RECEIVED
MAY 1958

STATE ENGINEER
SALES OFFICE

REGISTRATION NO. GR-4031
CERTIFICATE NO. GR-3634

Registration Statement

OF CLAIMANT OF RIGHT TO APPROPRIATE GROUND WATER

(Under Chapter 203, Oregon Laws 1955.)

TO THE STATE ENGINEER OF OREGON:

I, RAYMOND C. PAULSON

of WOODBURN County of CLACKMAS

State of OREGON do hereby make application for a certificate of registration as evidence of a right to appropriate ground water.

1. Source from which water is withdrawn is PUMP WELL
(Flowing well, pump well, infiltration trench, or tunnel)

2. Location is: 6 MILES EAST OF WOODBURN
(Appropriate distance and direction from nearest city or town)

and is more particularly described as follows:

(a) 28 RODS EAST & 100 FEET NORTH OF THE SOUTHWEST CORNER
(Give distance and bearing to corner of section or other legal subdivision)

being within NORTHWEST QUARTER of Sec. 18 Twp. 5S Rge. 1E
(Smallest legal subdivision) (N. or S.) (E. or W.)

or (b) within limits of recorded platted property, town or city:

In Lot _____ Block _____ of _____
(Name of plat or addition)

County of _____
(If within city or town, give name)

3. Construction Work was begun IN 1943; was completed IN 1943
(Date) (Date)

and the ground water claimed was first used for the purposes set out below on DOMESTIC 1943 IRRIG 1948
(Date) (Date)

since which time the water has been used CONTINUOUSLY
(Continuously or intermittently)

from MAR. 15 to OCT. 15 FOR IRRIGATION (YEAR AROUND FOR DOMESTIC)
(Date) (Date) (except)

4. Quantity of water claimed and used is 90 gallons per minute; _____ acre feet per year

5. Purpose or Purposes for which water is used: DOMESTIC & IRRIGATION
(Domestic, irrigation, municipal, manufacturing, industrial, etc.)

6. Description of Well: Depth 103 feet. Type DRILLED
(Dug or drilled)

diameter 6 inches. Elevation of ground at well site 100 feet, mean sea level.
(As near as known)

Depth to water table 20 feet.

7. Capacity of Well: 90 g.p.m. with 43 feet drawdown.
200 g.p.m. with 77 feet drawdown.

Date of test 1948

If Flowing Well: Measured discharge _____ g.p.m. on _____
(Date)

Shut-in pressure at ground surface _____ lbs. per sq. in. on _____
(Date)

Water is controlled by _____
(Cap, valve, etc.)

8. Casing: (Give diameter, commercial specifications and depth below ground surface of each casing size.)

6 inch diameter WELL CASING from 0 to 103 feet
inch diameter from to feet
inch diameter from to feet
inch diameter from to feet

Describe and show depth of shoe, plug, adapter, liner or other details:

9. Perforated Casings or Screens:

NONE from to
(Number per foot and size of perforations, or describe screen)
from to
from to
from to

10. Log of Well: (Describe each stratum or formation clearly, indicate if water bearing, and give thickness and depth as indicated.)

MATERIAL	Thickness (Feet)	Depth to Bottom (Feet)

If log of well is not available, give name and address of driller. _____

BYRON BALLWEBER RT#2 WOODBURN ORE. _____

11. Infiltration Trench: Covered or open _____

Dimensions: Length _____ ft. Minimum depth _____ ft. Maximum depth _____ ft.

Bottom width _____ ft. Discharge _____ g.p.m. Date of test _____

12. Tunnel: Type of lining _____

Dimensions: _____
(Length, course, and cross sectional size)

Position of water bearing stratum with reference to portal of tunnel _____

Log of tunnel: (Preceding table for log of well may be used, if desired. Give footage from portal and character of materials, as pertinent.) _____

13. Pumping Equipment:

(a) Pump COOK 13 STAGE TURBINE 6PR34 4 inch Capacity 90 g.p.m.
(Make, type and size)

(b) Motor 5 HP SINGLE PHASE
(Type and horsepower)

14. Location of area irrigated or to be irrigated, or place of use if for purposes other than irrigation.

Township North or South	Range E. or W. of Williamsite Meridian	Section	Forty-acre Tract	Number Acres To Be Irrigated	Date of Reclamation
5S	1E	18	40	40.0	1948
5S	1E	18	40	5.0	1948
				45.0	

15. If the ground water supply is supplemental to an existing water supply, identification of any application for a permit, permit, certificate or adjudicated right to appropriate water made or held by the registrant. _____

Township 5S Range 1E W.M.
North

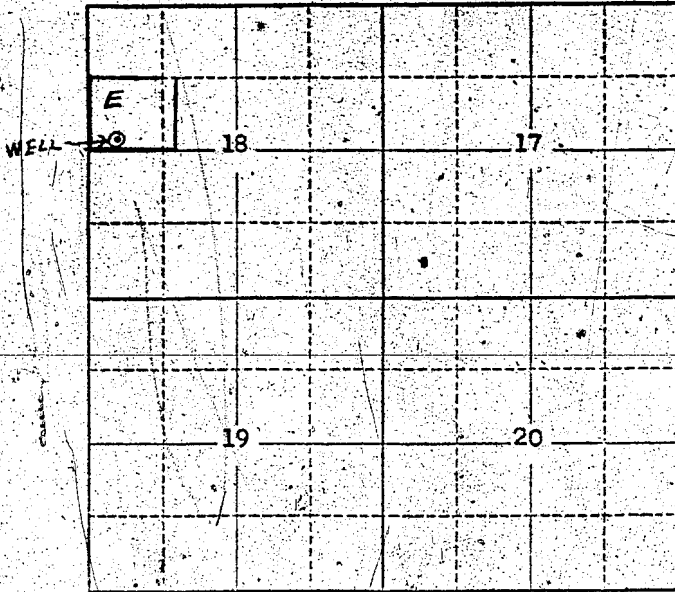

Locate well and acreage of irrigated land on plat.
Scale: $\frac{2}{3}$ " = 1 Mile

STATE OF OREGON

County of CLACKAMAS } ss.

I, RAYMOND C. PAULSON being first duly sworn, do hereby certify that I have read the foregoing Registration Statement and that all of the items therein contained are true to the best of my knowledge and belief.

Raymond C. Paulson
(Signature of Registrant)

Subscribed and sworn to before me this _____ day of August, 1959

My commission expires March 1962

[Signature]
(Notary Public)

(SEAL)

CERTIFICATE OF REGISTRATION

STATE OF OREGON

County of Marion } ss.

This is to certify that the foregoing Registration Statement was received in the office of the State Engineer on the 4th day of August, 1959, at 8:00 o'clock A. M. and has been duly recorded in said office in Book No. 15 of Registration Statements on page GR-3634

~~Construction shall be completed by _____ 19____ and the water completely applied to beneficial use by _____ 19____~~

Witness my hand this 15th day of September, 1959

[Signature]
(State Engineer)

\$ 17.25

By _____
(Deputy)

GR-3634