

Registration No. GR-4035

Certificate No. GR-3638

STATE ENGINEER
SALES, OREGON

Registration Statement

OF CLAIMANT OF RIGHT TO APPROPRIATE GROUND WATER

TO THE STATE ENGINEER OF OREGON:

I, Charles M. Fuhrer and Hazel L. Fuhrer

of Eugene Rt. 1 Box 112-T Eugene, Oregon County of Lane

State of Oregon, do hereby make application for a certificate of registration as evidence of a right to appropriate ground water.

1. Source from which water is withdrawn is Pumped Well
(Flowing well, pump well, infiltration trench, or tunnel)

2. Location is: One mile east of Goshen on the Severy Loop Road.
(Approximate distance and direction from nearest city or town)

and is more particularly described as follows:

(a) 65 Ft to well Begining at Washington L. Riggs, S1/4 S.E. Cor. D.I.C. #10 N 150 Ft. Thence E.
(Give distance and bearing to corner of section or other legal subdivision)

being within NW 1/4 of SE 1/4 of Sec. 13, Twp. 18 S, Rge. 3W WM
(Smallest legal subdivision) (N. or S.) (E. or W.)

or (b) within limits of recorded platted property, town or city:

in Lot 8-6, Block _____ of _____
(Name of plat or addition)

County of Lane

(If within city or town, give name) Oct. 1952
3. Construction Work was begun on _____; was completed on Oct. 1952
(Date) (Date)

and the ground water claimed was first used for the purposes set out below on June 1954
(Date)

since which time the water has been used Continuously for house use and irrigation
(Continuously or intermittently)

from June 1954 to July 31 1958
(Date) (Date)

4. Quantity of water claimed and used is 15 gallons per minute; _____ acre feet per year.

5. Purpose or Purposes for which water is used (exempt) House and domestic and irrigation.

(Domestic, irrigation, municipal, manufacturing, industrial, etc.)

6. Description of Well: Depth 46 feet. Type Drilled
(Dug or drilled)

diameter 5 inches. Elevation of ground at well site 500 feet, mean sea level.
(As near as known)

Depth to water table 12 feet.

7. Capacity of Well: 500 g.p.m. with 10 feet drawdown.

_____ g.p.m. with _____ feet drawdown.

Date of test June 1954

If Flowing Well: Measured discharge _____ g.p.m. on _____
(Date)

Shut-in pressure at ground surface _____ lbs. per sq. in. on _____
(Date)

Water is controlled by _____
(Cap, valve, etc.)

8. Casing: (Give diameter, commercial specifications and depth below ground surface of each casing size.)

5 inch diameter from 0 to 21 feet
 inch diameter from to feet
 inch diameter from to feet
 inch diameter from to feet

Describe and show depth of shoe, plug, adapter, liner or other details:

9. Perforated Casings or Screens:

..... from to
 (Number per foot and size of perforations, or describe screen)
 from to
 from to
 from to

10. Log of Well: (Describe each stratum or formation clearly, indicate if water bearing, and give thickness and depth as indicated.)

MATERIAL	Thickness (Feet)	Depth to Bottom (Feet)
Blue clay	19	29
Hard blue and black shale	27	27
Gravel and sand at source of water. At break through of shale, the source of the water supply.		

If log of well is not available, give name and address of driller. Curtis Miller

1100 Cal Young Road, Eugene Lane County, Oregon

11. Infiltration Trench: Covered or open _____

Dimensions: Length _____ ft. Minimum depth _____ ft. Maximum depth _____ ft.

Bottom width _____ ft. Discharge _____ g.p.m. Date of test _____

12. Tunnel: Type of lining _____

Dimensions: _____
(Length, course, and cross sectional size)

Position of water bearing stratum with reference to portal of tunnel _____

Log of tunnel: (Preceding table for log of well may be used, if desired. Give footage from portal and character of materials, as pertinent.)

13. Pumping Equipment:

(a) Pump Berkely Pump Jet type _____ Capacity 15 g.p.m.
(Make, type and size)

(b) Motor 1 HP General Electric Cap. Start _____
(Type and horsepower)

14. Location of area irrigated or to be irrigated, or place of use if for purposes other than irrigation.

Township North or South	Range E. or W. of Willamette Meridian	Section	Forty-acre Tract	Number Acres To Be Irrigated	Date of Reclamation
<u>#4 18S.</u>	<u>R 3W WM</u>	<u>13</u>	<u>NW 1/4</u> <u>SW 1/4 of SE 1</u>	<u>0.62</u>	<u>6-1-54</u>

15. If the ground water supply is supplemental to an existing water supply, identification of any application for a permit, permit, certificate or adjudicated right to appropriate water made or held by the registrant.

Township 18S Range 3W W.M.
North

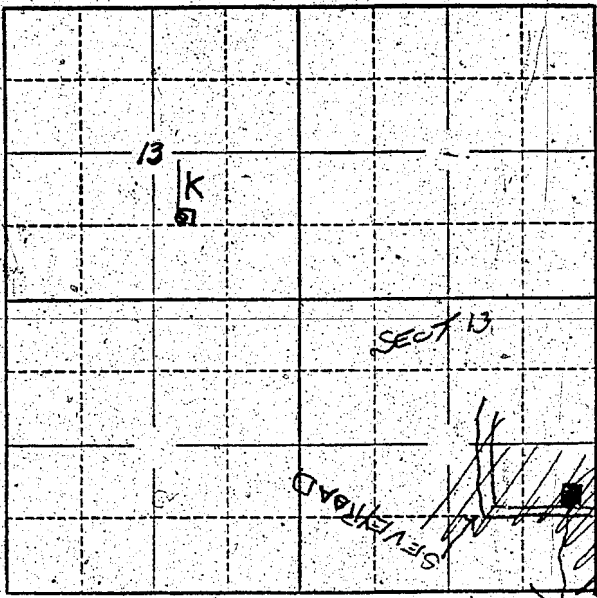

Locate well and acreage of irrigated land on plat
Scale: 2" = 1 Mile

STATE OF OREGON }
County of Lincoln } ss.

I, Harold L. Fickery
Charles W. Fisher being first duly sworn, do hereby certify that I have read the foregoing Registration Statement and that all of the items therein contained are true to the best of my knowledge and belief.

Harold L. Fickery
Charles W. Fisher
(Signature of Registrant)

Subscribed and sworn to before me this 15th day of August, 1958

My commission expires Sept 28 1958

[Signature]
(Notary Public)

(SEAL)

CERTIFICATE OF REGISTRATION

STATE OF OREGON }
County of Marion } ss.

This is to certify that the foregoing Registration Statement was received in the office of the State Engineer on the 4th day of August, 1958, at 8:00 o'clock A.M. and has been duly recorded in said office in Book No. 15 of Registration Statements on page 62-3638

Witness my hand this 15th day of September, 1959

Lewis A. Stanley
(State Engineer)

\$15.00

By _____
(Deputy)