

Registration Statement

OF CLAIMANT OF RIGHT TO APPROPRIATE GROUND WATER

TO THE STATE ENGINEER OF OREGON:

I, Frank N. Waters dba City Ice Works
of 1551 Center St, Salem County of Marion
State of Oregon, do hereby make application for a certificate of registration as evidence
of a right to appropriate ground water.

1. Source from which water is withdrawn is Pump well
(Flowing well, pump well, infiltration trench, or tunnel)

2. Location is: at above address
(Approximate distance and direction from nearest city or town)

and is more particularly described as follows: 180' S. 595' W. from N. 1/4 cor. sec 26

(a) ~~115' East and 75' North of City Monument in Intersection Center 574299~~
(Give distance and bearing to corner of section or other legal subdivision)

being within NE 1/4 of NW 1/4 of Sec. 26, Twp. 7 S, Rge. 3 W
(Smallest legal subdivision) (N. or S.) (E. or W.)

or (b) within limits of recorded platted property, town or city: in an unplatted portion

in Lot _____, Block _____ of _____
(Name of plat or addition)

Salem County of Marion
(If within city or town, give name)

3. Construction Work was begun on about 1926, was completed on _____ 1926
(Date) (Date)

and the ground water claimed was first used for the purposes set out below on _____ 1926
(Date)

since which time the water has been used Cont.
(Continuously or intermittently)

from 1926 to date
(Date) (Date)

4. Quantity of water claimed and used is 150 gallons per minute; _____ acre
feet per year.

5. Purpose or Purposes for which water is used Industrial cooling
(Domestic, irrigation, municipal, manufacturing, industrial, etc.)

6. Description of Well: Depth 125 feet. Type drilled
(Dug or drilled)

diameter 8 inches. Elevation of ground at well site _____ feet, mean sea level.
(As near as known)

Depth to water table 12 feet. static. Draw down to 90'

7. Capacity of Well: 150 g.p.m. with _____ feet drawdown.

_____ g.p.m. with _____ feet drawdown.

Date of test 1956

If Flowing Well: Measured discharge _____ g.p.m. on _____
(Date)

Shut-in pressure at ground surface _____ lbs. per sq. in. on _____
(Date)

Water is controlled by _____
(Cap, valve, etc.)

Township 7S Range 3W W.M.

North

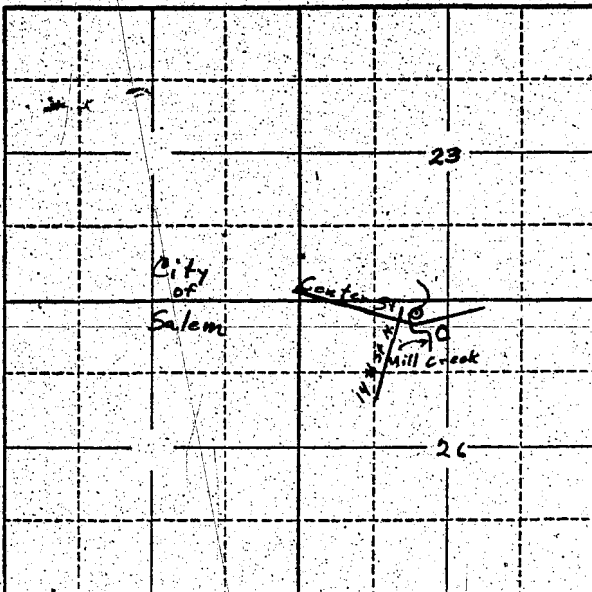

Locate well and acreage of irrigated land on plat.

Scale: 2" = 1 Mile

STATE OF OREGON

County of Marion

} ss.

I, Frank N. Waters, being first duly sworn, do hereby certify that I have read the foregoing Registration Statement and that all of the items therein contained are true to the best of my knowledge and belief.

Frank N. Waters
(Signature of Registrant)

Subscribed and sworn to before me this 4th day of August, 1958

My commission expires 12th June 1961

Wm. S. Bartholomew
(Notary Public)

(SEAL)

CERTIFICATE OF REGISTRATION

STATE OF OREGON

County of Marion

} ss.

This is to certify that the foregoing Registration Statement was received in the office of the State Engineer on the 4th day of August, 1958, at 8⁰⁰ o'clock A. M. and has been duly recorded in said office in Book No. 15 of Registration Statements on page GR-3655

Witness my hand this 20th day of October, 1959

\$ 20.00

Lewis A. Stanley
(State Engineer)

By

(Deputy)

GR. 3655