

RECEIVED  
AUG 4 1958

Registration No. GR-4070

Certificate No. GR-3667

STATE ENGINEER  
SALEM, OREGON

# Registration Statement

## OF CLAIMANT OF RIGHT TO APPROPRIATE GROUND WATER

TO THE STATE ENGINEER OF OREGON:

I, Aaron & Kathryn LaFore  
of At J. Box 304 Milton - Fremont County of W. Umatilla  
(Mailing address)

State of Oregon, do hereby make application for a certificate of registration as evidence of a right to appropriate ground water.

1. Source from which water is withdrawn is Pump Well  
(Flowing well, pump well, infiltration trench, or tunnel)
2. Location is: 3 miles NW Milton - Fremont  
(Approximate distance and direction from nearest city or town)

and is more particularly described as follows:

- (a) 1340' N & 650' E of SW corner of Sec 27  
(Give distance and bearing to corner of section or other legal subdivision)  
being within SW 4 of NW 4 of SE 4 of Sec. 27, Twp. 6 N, Rge. 35 E  
(Smallest legal subdivision) (N. or S.) (E. or W.)
- or (b) within limits of recorded platted property, town or city: \_\_\_\_\_

In Lot \_\_\_\_\_ Block \_\_\_\_\_ of \_\_\_\_\_  
(Name of plat or addition)  
County of \_\_\_\_\_  
(If within city or town, give name)

3. Construction Work was begun on Prior 1915; was completed on 1922  
(Date) (Date)  
and the ground water claimed was first used for the purposes set out below on Prior 1915  
(Date)

since which time the water has been used Continuously  
(Continuously or Intermittently)  
from Prior 1915 to 1958  
(Date) (Date)

4. Quantity of water claimed and used is 275 gallons per minute; 50 acre feet per year.

5. Purpose or Purposes for which water is used Irrigation  
(Domestic, irrigation, municipal, manufacturing, industrial, etc.)

6. Description of Well: Depth 61 feet. Type Dug 34' Drill 22'  
(Dug or drilled)  
diameter 6" Drill inches. Elevation of ground at well site 875 feet, mean sea level.  
(As near as known)  
Depth to water table 20 feet.

7. Capacity of Well: \_\_\_\_\_ g.p.m. with \_\_\_\_\_ feet drawdown.  
\_\_\_\_\_ g.p.m. with \_\_\_\_\_ feet drawdown.

Date of test No Test

If Flowing Well: Measured discharge \_\_\_\_\_ g.p.m. on \_\_\_\_\_  
(Date)

Shut-in pressure at ground surface \_\_\_\_\_ lbs. per sq. in. on \_\_\_\_\_  
(Date)

Water is controlled by \_\_\_\_\_  
(Cap. valve, etc.)

8. Casing: (Give diameter, commercial specifications and depth below ground surface of each casing size.)

7 1/2" inch diameter Concrete from 0' to 15' feet  
6 inch diameter Steel from 38' to Not known feet  
inch diameter from to feet  
inch diameter from to feet

Describe and show depth of shoe, plug, adapter, liner or other details:

9. Perforated Casings or Screens:

Not known

(Number per foot and size of perforations, or describe screen)

from to  
from to  
from to  
from to

10. Log of Well: (Describe each stratum or formation clearly, indicate if water bearing, and give thickness and depth as indicated.)

Not known

MATERIAL	Thickness (Feet)	Depth to Bottom (Feet)

If log of well is not available, give name and address of driller. Not known

11. Infiltration Trench: Covered or open \_\_\_\_\_

Dimensions: Length \_\_\_\_\_ ft. Minimum depth \_\_\_\_\_ ft. Maximum depth \_\_\_\_\_ ft.

Bottom width \_\_\_\_\_ ft. Discharge \_\_\_\_\_ g.p.m. Date of test \_\_\_\_\_

12. Tunnel: Type of lining \_\_\_\_\_

Dimensions: \_\_\_\_\_  
(Length, course, and cross sectional size)

Position of water bearing stratum with reference to portal of tunnel \_\_\_\_\_

Log of tunnel: (Preceding table for log of well may be used, if desired. Give footage from portal and character of materials, as pertinent.)

13. Pumping Equipment:

(a) Pump Centrifugal-Coop 5" Capacity 275 g.p.m.  
(Make, type and size)

(b) Motor 5 HP Elec  
(Type and horsepower)

14. Location of area irrigated or to be irrigated, or place of use if for purposes other than irrigation.

Township North or South	Range E. or W. of Willamette Meridian	Section	Forty-acre Tract	Number Acres To Be Irrigated	Date of Reclamation
<u>6N</u>	<u>35E</u>	<u>27</u>	<u>NW 4 of SE 4</u>	<u>10%</u>	<u>prior 1915</u>

15. If the ground water supply is supplemental to an existing water supply, identification of any application for a permit, permit, certificate or adjudicated right to appropriate water made or held by the registrant.

None

Township 6N Range 35E W.M.  
North

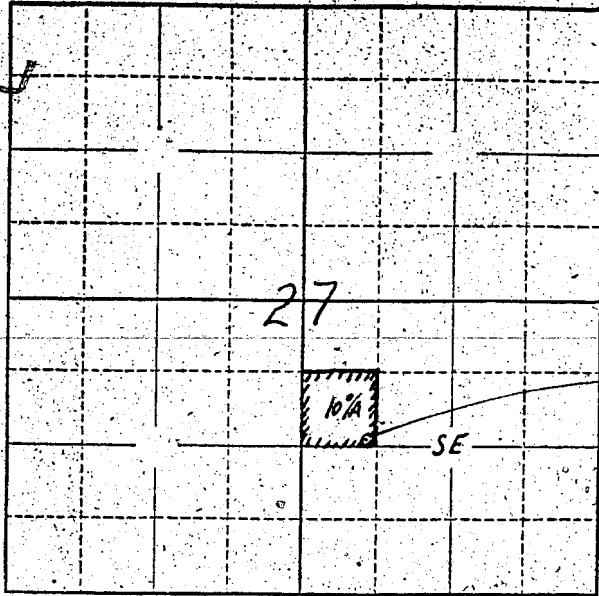

Locate well and acreage of irrigated land on plat.

Scale:  $\frac{1}{4}$  inch = 1 Mile

STATE OF OREGON

County of Umatilla } ss.

I, Kathryn LaFore, being first duly sworn, do hereby certify that I have read the foregoing Registration Statement and that all of the items therein contained are true to the best of my knowledge and belief.

X Kathryn LaFore  
(Signature of Registrant)

Subscribed and sworn to before me this 2nd day of August, 19 58.

My commission expires October 6th, 1960.

D. H. Dadd  
(Notary Public) for Oregon

(SEAL)

CERTIFICATE OF REGISTRATION

STATE OF OREGON

County of Marion } ss.

This is to certify that the foregoing Registration Statement was received in the office of the State Engineer on the 4th day of August, 19 58, at 2:00 o'clock A. M. and has been duly recorded in said office in Book No. 15 of Registration Statements on page GR-3667.

Witness my hand this 20th day of October, 19 59.

Henry A. Stanley  
(State Engineer)

\$15.00

By \_\_\_\_\_ (Deputy)

GR. 3667