

RECEIVED
AUG 4 1958

Registration No. GR-4076

Certificate No. GR-3672

STATE ENGINEER
SALEM, OREGON

Registration Statement

OF CLAIMANT OF RIGHT TO APPROPRIATE GROUND WATER

TO THE STATE ENGINEER OF OREGON:

I, Mrs Robert Pears
of Box 364 Milton Freewater County of Umatilla
(Mailing address)
State of Oregon, do hereby make application for a certificate of registration as evidence
of a right to appropriate ground water.

1. Source from which water is withdrawn is Pump Well
(Flowing well, pump well, infiltration trench, or tunnel)
2. Location is: 1 Mile NW Milton Freewater
(Approximate distance and direction from nearest city or town)

and is more particularly described as follows:

(a) 980' S 20' W NE Cor SW 1/4 SW 1/4
(Distance and bearing to corner of section or other legal subdivision)
being within SW 1/4 SW 1/4 of Sec. 35, Twp. 6N, Rge. 35E
(Smallest legal subdivision) (N. or S.) (E. or W.)
or (b) within limits of recorded platted property, town or city:
in Lot _____, Block _____ of _____
(Name of plat or addition)

County of _____
(If within city or town, give name)

3. Construction Work was begun on Prior 1908; was completed on Prior 1908
(Date) (Date)
and the ground water claimed was first used for the purposes set out below on Prior 1908
(Date)
since which time the water has been used intermittently
(Continuously or intermittently)
from Prior 1908 to July 1958
(Date) (Date)

4. Quantity of water claimed and used is 200 gallons per minute; 20 acre feet per year.

5. Purpose or Purposes for which water is used irrigation

(Domestic, irrigation, municipal, manufacturing, industrial, etc.)

6. Description of Well: Depth 30 feet; Type Dug
(Dug or drilled)
diameter 60x60 inches. Elevation of ground at well site 900 feet, mean sea level.
(As near as known)
Depth to water table 20 feet. May 1

7. Capacity of Well: 200 g.p.m. with 5'-9" feet drawdown.
_____ g.p.m. with _____ feet drawdown.

Date of test None

If Flowing Well: Measured discharge _____ g.p.m. on _____
(Date)

Shut-in pressure at ground surface _____ lbs. per sq. in. on _____
(Date)

Water is controlled by _____
(Cap, valve, etc.)

SW 1/4 Sec 35

Township 6N Range 35E W.M.

North

35

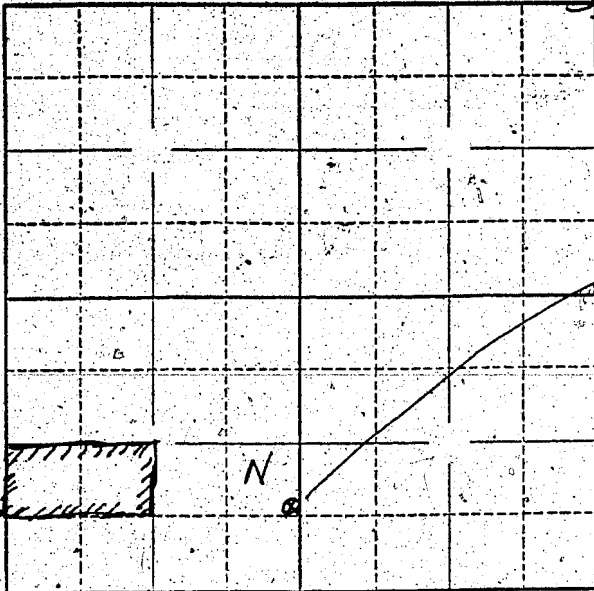

Well
 location
 980' S 20' W.
 of NE Corner
 SW 1/4 SW 1/4
 Sec 35 T 6 N
 R. 35 E

Locate well and acreage of irrigated land on plat.

Scale: 2" = 1 Mile

STATE OF OREGON

County of Wmatilla } ss.

I, Mrs Robert Pears, being first duly sworn, do hereby certify that I have read the foregoing Registration Statement and that all of the items therein contained are true to the best of my knowledge and belief.

Mrs Robert Pears
(Signature of Registrant)

Subscribed and sworn to before me this 21 day of Aug, 1958

My commission expires Jan-26, 1962 Ed Bishop
(Notary Public)

(SEAL)

CERTIFICATE OF REGISTRATION

STATE OF OREGON } ss.
County of Marion

This is to certify that the foregoing Registration Statement was received in the office of the State Engineer on the 4th day of August, 1958, at 1:00 o'clock P. M. and has been duly recorded in said office in Book No. 15 of Registration Statements on page 3672

Witness my hand this 20th day of October, 19 59

Stuart A. Stanley
(State Engineer)

#15.00

By _____ (Deputy)