

RECEIVED

AUG 4 1958

STATE ENGINEER  
SALEM, OREGON

Registration No. GR-4078

Certificate No. GR-3674

Registration Statement

OF CLAIMANT OF RIGHT TO APPROPRIATE GROUND WATER

TO THE STATE ENGINEER OF OREGON:

I, E.E. Cone (Cone Lumber Co.)

of Goshan, Oregon County of Lane

State of Oregon, do hereby make application for a certificate of registration as evidence of a right to appropriate ground water.

1. Source from which water is withdrawn is Pump well #2  
(Flowing well, pump well, infiltration trench, or tunnel)

2. Location is: 1/4 mile South of Goshan  
(Approximate distance and direction from nearest city or town)

and is more particularly described as follows:

(a) 1000 feet south & 1390 feet west from NE corner of Section 23,  
(Give distance and bearing to corner of section or other legal subdivision)

being within W 1/2 - NE 1/4 of Sec. 23, Twp. 18S, Rge. 3W  
(Smallest legal subdivision) (N. or S.) (E. or W.)

or (b) within limits of recorded platted property, town or city:

in Lot \_\_\_\_\_, Block \_\_\_\_\_ of \_\_\_\_\_  
(Name of plat or addition)

County of \_\_\_\_\_  
(If within city or town, give name)

3. Construction Work was begun on Aug 1948 (approx) was completed on same 1948  
(Date) (Date)

and the ground water claimed was first used for the purposes set out below on same 1948  
(Date)

since which time the water has been used continuously  
(Continuously or Intermittently)

from January to January  
(Date) (Date)

4. Quantity of water claimed and used is 25 gallons per minute; \_\_\_\_\_ acre feet per year.

5. Purpose or Purposes for which water is used industrial

(Domestic, irrigation, municipal, manufacturing, industrial, etc.)

6. Description of Well: Depth 20 feet. Type drilled

(Dug or drilled)

diameter 5 inches. Elevation of ground at well site 350 feet, mean sea level.  
(As near as known)

Depth to water table unknown feet.

7. Capacity of Well: unknown g.p.m. with \_\_\_\_\_ feet drawdown.

\_\_\_\_\_ g.p.m. with \_\_\_\_\_ feet drawdown.

Date of test \_\_\_\_\_

If Flowing Well: Measured discharge \_\_\_\_\_ g.p.m. on \_\_\_\_\_

(Date)

Shut-in pressure at ground surface \_\_\_\_\_ lbs. per sq. in. on \_\_\_\_\_

(Date)

Water is controlled by \_\_\_\_\_

(Cap, valve, etc.)

8. **Casing:** (Give diameter, commercial specifications and depth below ground surface of each casing size.)

5 inch diameter ..... from 0 to 20 feet  
..... inch diameter ..... from ..... to ..... feet  
..... inch diameter ..... from ..... to ..... feet  
..... inch diameter ..... from ..... to ..... feet

Describe and show depth of shoe, plug, adapter, liner or other details:  
.....  
.....

9. **Perforated Casings or Screens:**

none ..... from ..... to .....  
(Number per foot and size of perforations, or describe screen)  
..... from ..... to .....  
..... from ..... to .....  
..... from ..... to .....

10. **Log of Well:** (Describe each stratum or formation clearly, indicate if water bearing, and give thickness and depth as indicated.)

MATERIAL	Thickness (Feet)	Depth to Bottom (Feet)
none		

If log of well is not available, give name and address of driller, deceased

11. Infiltration Trench: Covered or open

Dimensions: Length \_\_\_\_\_ ft. Minimum depth \_\_\_\_\_ ft. Maximum depth \_\_\_\_\_ ft.

Bottom width \_\_\_\_\_ ft. Discharge \_\_\_\_\_ g.p.m. Date of test \_\_\_\_\_

12. Tunnel: Type of lining

Dimensions: \_\_\_\_\_  
(Length, course, and cross sectional size)

Position of water bearing stratum with reference to portal of tunnel

Log of tunnel: (Preceding table for log of well may be used, if desired. Give footage from portal and character of materials, as pertinent.)

13. Pumping Equipment:

(a) Pump Barkley 1HP Capacity 25 g.p.m.  
(Make, type and size)

(b) Motor \_\_\_\_\_  
(Type and horsepower)

14. Location of area irrigated or to be irrigated, or place of use if for purposes other than irrigation.

Township North or South	Range N. or W. of Williams Meridian	Section	Forty-acre Tract	Number Acres To Be Irrigated	Date of Reclamation
18S	3W	29	W $\frac{1}{2}$ NE $\frac{1}{4}$	Industrial use on 15 Acres	Aug. 1948

15. If the ground water supply is supplemental to an existing water supply, identification of any application for a permit, permit, certificate or adjudicated right to appropriate water made or held by the registrant.

Township 18S Range 5W W.M.  
North

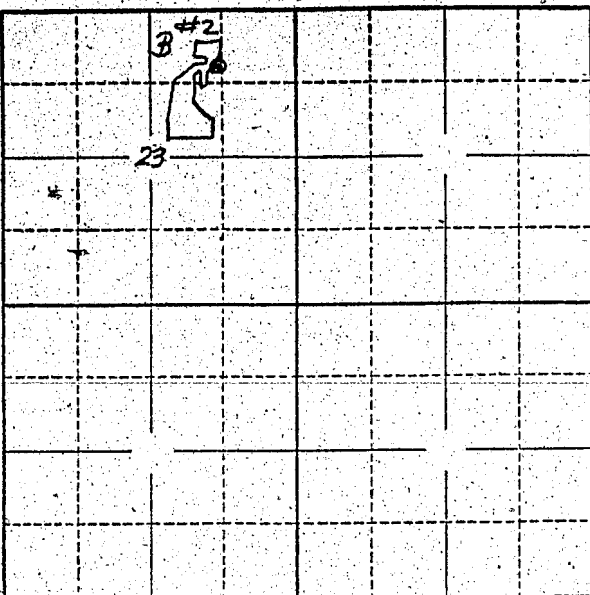

We 11.

Locate well and acreage of irrigated land on plat.  
Scale: 2" = 1 Mile

STATE OF OREGON

County of Lane

} ss.

I, E. E. Cone, being first duly sworn, do hereby certify that I have read the foregoing Registration Statement and that all of the items therein contained are true to the best of my knowledge and belief.

E. E. Cone

(Signature of Registrant)

Subscribed and sworn to before me this 1st day of August, 19 58

My commission expires 2/16/62

Roberta D. Robertson

(Notary Public)

(SEAL)

**CERTIFICATE OF REGISTRATION**

STATE OF OREGON

County of Marion

} ss.

This is to certify that the foregoing Registration Statement was received in the office of the State Engineer on the 4th day of August, 19 58, at 8:00 o'clock A. M. and has been duly recorded in said office in Book No. 15 of Registration Statements on page GR-3674

Witness my hand this 20th day of October, 19 59

Lewis A. Stanley

(State Engineer)

By \_\_\_\_\_

(Deputy)

\$ 20.00

GR. 3674