

RECEIVED
AUG 4 1958

STATE ENGINEER
SALEM, OREGON

RECEIVED
APR 12 1960

STATE ENGINEER
SALEM, OREGON

Registration No. GR - 4084

Certificate No. GR - 4059

Registration Statement

OF CLAIMANT OF RIGHT TO APPROPRIATE GROUND WATER

TO THE STATE ENGINEER OF OREGON:

I, Mrs Lois Pope

of 145 Fair Acres Drive Eugene County of Lane
(Mailing address)

State of Oregon, do hereby make application for a certificate of registration as evidence of a right to appropriate ground water.

1. Source from which water is withdrawn is Pump well
(Flowing well, pump well, infiltration trench, or tunnel)

2. Location is: two miles north of Eugene
(Approximate distance and direction from nearest city or town)

and is more particularly described as follows: 570 feet east & 900 feet north from Center of Section 19

(a) 240 ft east of Fair Acres Drive 110 ft South of Bond Lane
(Give guidance and bearing to corner of section or other legal subdivision)

being within SW 1/4 of NE 1/4 of Sec. 19, Twp. 17 S, Rge. 3 W
(Smallest legal subdivision) (S. or S.) (E. or W.)

or (b) within limits of recorded platted property, town or city:

in Lot _____, Block _____ of Chesapeake
(Name of plat or addition)

County of _____
(If within city or town, give name)

3. Construction Work was begun on May 1 - 1954, was completed on May 3 - 1954
(Date) (Date)

and the ground water claimed was first used for the purposes set out below on May 3 - 1954
(Date)

since which time the water has been used Continuously
(Continuously or intermittently)

from May 1 - to Oct.
(Date) (Date)

4. Quantity of water claimed and used is 160 gallons per minute; 2 acre feet per year.

5. Purpose or Purposes for which water is used Irrigation
(Domestic, irrigation, municipal, manufacturing, industrial, etc.)

6. Description of Well: Depth 40 feet. Type Drilled
(Dug or drilled)

diameter 6 inches. Elevation of ground at well site 150 feet, mean sea level.
(As near as known)

Depth to water table 15 feet.

7. Capacity of Well: 180 g.p.m. with _____ feet drawdown.

_____ g.p.m. with _____ feet drawdown.

Date of test May 3 - 1954

If Flowing Well: Measured discharge _____ g.p.m. on _____
(Date)

Shut-in pressure at ground surface _____ lbs. per sq. in. on _____
(Date)

Water is controlled by _____
(Cap, valve, etc.)

8. Casing: (Give diameter, commercial specifications and depth below ground surface of each casing size.)

..... inch diameter from to feet

..... inch diameter from to feet

..... inch diameter from to feet

..... inch diameter from to feet

Describe and show depth of shoe, plug, adapter, liner or other details:

.....

.....

9. Perforated Casings or Screens:

(Number per foot and size of perforations, or describe screen) from to

..... from to

..... from to

..... from to

10. Log of Well: (Describe each stratum or formation clearly, indicate if water bearing, and give thickness and depth as indicated.)

Wagner Slugs

MATERIAL	Thickness (Feet)	Depth to Bottom (Feet)

If log of well is not available, give name and address of driller. Wayne Hayes
535 Coburg Road. Eugene

11. Infiltration Trench: Covered or open
 Dimensions: Length ft. Minimum depth ft. Maximum depth ft.

Bottom width ft. Discharge g.p.m. Date of test

12. Tunnel: Type of lining

Dimensions:
(Length, course, and cross sectional size)

Position of water bearing stratum with reference to portal of tunnel

Log of tunnel: (Preceding table for log of well may be used, if desired. Give footage from portal and character of materials, as pertinent.)

13. Pumping Equipment:

(a) Pump 2" Pacific Capacity 180 g.p.m.
(Make, type and size)

(b) Motor 5 HP single phase
(Type and horsepower)

14. Location of area irrigated or to be irrigated, or place of use if for purposes other than irrigation.

Township North or South	Range E. or W. of Willamette Meridian	Section	Forty-acre Tract	Number Acres To Be Irrigated	Date of Reclamation
T17 S	R3W	19	SW ¹ / ₄ of NE ¹ / ₄	2.0	1954

15. If the ground water supply is supplemental to an existing water supply, identification of any application for a permit, permit, certificate or adjudicated right to appropriate water made or held by the registrant.

Township 17S Range 3W W.M.

North

300 ME. north of here

*107 ft from
2nd Lane
190 ft
57 1/2 ft*

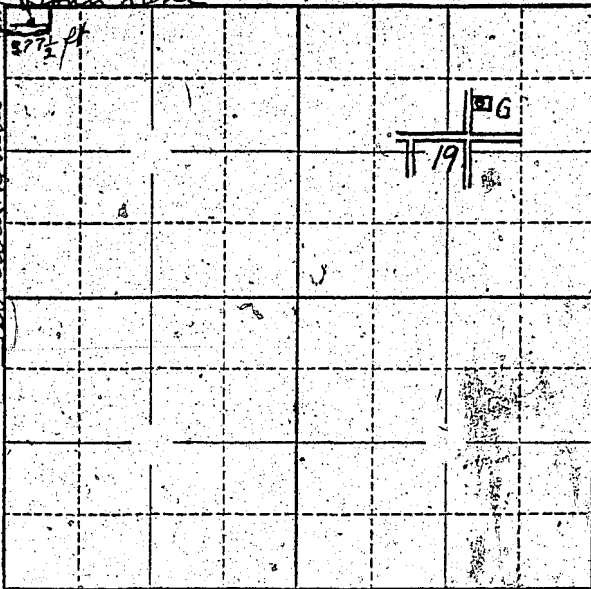

Locate well and acreage of irrigated land on plat.

Scale: 2" = 1 Mile

STATE OF OREGON

County of Lane } ss.

I, Louis Pope, being first duly sworn, do hereby certify that I have read the foregoing Registration Statement and that all of the items therein contained are true to the best of my knowledge and belief.

Mrs. Louis Pope
(Signature of Registrant)

Subscribed and sworn to before me this 2 day of August, 1958

My commission expires Oct-29-1960 Marvin Laverne
(Notary Public)

(SEAL)

CERTIFICATE OF REGISTRATION

STATE OF OREGON

County of Marion } ss.

This is to certify that the foregoing Registration Statement was received in the office of the State Engineer on the 4 day of August, 1958, at 8:00 o'clock A. M. and has been duly recorded in said office in Book No. 17 of Registration Statements on page GR-4059

Witness my hand this 16th day of May, 1960

Laura A. Stanley
(State Engineer)

By _____ (Deputy)

\$15.00

GR 4059