

### Registration Statement

**RECEIVED**  
AUG 4 1950  
STATE ENGINEER  
SALEM, OREGON

#### CLAIMANT OF RIGHT TO APPROPRIATE GROUND WATER

TO THE STATE ENGINEER OF OREGON:

I, Howard Delahaye

of Box 1032 Milton-Freewater County of Umatilla

State of Oregon, do hereby make application for a certificate of registration as evidence of a right to appropriate ground water.

1. Source from which water is withdrawn is pump well  
(Flowing well, pump well, infiltration trench, or tunnel)

2. Location is: 3 miles NW Milton-Freewater  
(Approximate distance and direction from nearest city or town)

and is more particularly described as follows:

(a) 640' N & 1300' East of W<sup>4</sup> Corner of Sec 34  
(Give distance and bearing to corner of section or other legal subdivision)

being within NE<sup>4</sup> of SW<sup>4</sup> of NW<sup>4</sup> of Sec. 34 Twp. 6N Rge. 35E  
(Smallest legal subdivision) (N. or S.) (E. or W.)

or (b) within limits of recorded platted property, town or city:

in Lot \_\_\_\_\_, Block \_\_\_\_\_ of \_\_\_\_\_  
(Name of plat or addition)

County of \_\_\_\_\_  
(If within city or town, give name)

3. Construction Work was begun on 1898; was completed on 1898  
(Date) (Date)

and the ground water claimed was first used for the purposes set out below on 1898  
(Date)

since which time the water has been used Continuously  
(Continuously or Intermittently)

from 1898 to 1958 possibly one or two years not used for Irrigation  
(Date) (Date)

4. Quantity of water claimed and used is 40 gallons per minute; 15 acre feet per year.

5. Purpose or Purposes for which water is used Irrigation & Domestic

(Domestic, irrigation, municipal, manufacturing, industrial, etc.)

6. Description of Well: Depth 90 feet. Type 45' dug 45' drilled  
(Dug or drilled)

diameter 72" dug 6" drill inches. Elevation of ground at well site 950 feet, mean sea level.  
(As near as known)

Depth to water table 10 feet.

7. Capacity of Well: \_\_\_\_\_ g.p.m. with \_\_\_\_\_ feet drawdown.

\_\_\_\_\_ g.p.m. with \_\_\_\_\_ feet drawdown.

Date of test No test

If Flowing Well: Measured discharge \_\_\_\_\_ g.p.m. on \_\_\_\_\_  
(Date)

Shut-in pressure at ground surface \_\_\_\_\_ lbs. per sq. in. on \_\_\_\_\_  
(Date)

Water is controlled by \_\_\_\_\_  
(Cap. valve, etc.)





Township 6N Range 35E, W.M.  
North

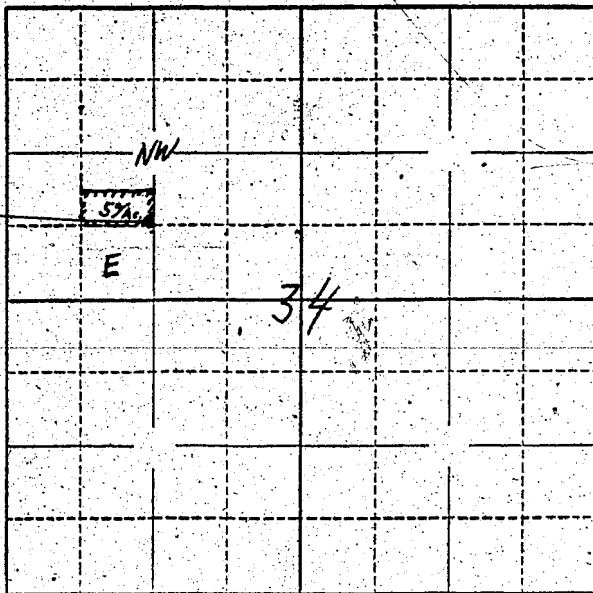

Well location  
1300 feet East +  
640 feet North  
of W. corner of  
Sec 34

Locate well and acreage of irrigated land on plat.  
Scale: 2" = 1 Mile

STATE OF OREGON

County of UMATILLA } ss.

I, HOWARD DELAHAY, being first duly sworn, do hereby certify that I have read the foregoing Registration Statement and that all of the items therein contained are true to the best of my knowledge and belief.

Howard Delahay  
(Signature of Registrant)

Subscribed and sworn to before me this 31<sup>ST</sup> day of SEPT, 1958

My commission expires AUG 19, 1959  
(Notary Public)

(SEAL)

**CERTIFICATE OF REGISTRATION**

STATE OF OREGON } ss.  
County of Marion

This is to certify that the foregoing Registration Statement was received in the office of the State Engineer on the 4 day of August, 1958, at 8:00 o'clock A. M. and has been duly recorded in said office in Book No. 15 of Registration Statements on page GR-3685

Witness my hand this 20<sup>th</sup> day of October, 1959

Lewis A. Stanley  
(State Engineer)

\$15.00

By \_\_\_\_\_  
(Deputy)

GR 3685