

RECEIVED
AUG 4 1958
STATE ENGINEER
SALEM, OREGON

Registration No. GR. - 4102

Certificate No. GR. - 4054

Registration Statement

OF CLAIMANT OF RIGHT TO APPROPRIATE GROUND WATER

TO THE STATE ENGINEER OF OREGON:

I, Leon Jerome Bryson
of 102 Lingo Lane Junction city County of Lane
(Mailing address)

State of Oregon, do hereby make application for a certificate of registration as evidence of a right to appropriate ground water.

1. Source from which water is withdrawn is pump well
(Flowing well, pump well, infiltration trench, tunnel)

2. Location is: 1 mile west of Harrisburg
(Approximate distance and direction from nearest city or town)

and is more particularly described as follows:

(a) 1800' N + 500' E of southwest corner Sec # 9
(Give distance and bearing to corner of section or other legal subdivision)

being within NW 1/4 - SW 1/4 of Sec. 9, Twp. 15 S, Rge. 4 W
(Smallest legal subdivision) (S. or S.) (E. or W.)

or (b) within limits of recorded platted property, town or city:

in Lot _____, Block _____ of _____
(Name of plat or addition)
County of _____
(If within city or town, give name)

3. Construction Work was begun on 6/53, was completed on 7/53
(Date) (Date)

and the ground water claimed was first used for the purposes set out below on 7/53
(Date)

since which time the water has been used CONTINUOUSLY
(Continuous or intermittently)

from June to September
(Date) (Date)

4. Quantity of water claimed and used is 384 gallons per minute; _____ acre feet per year.

5. Purpose or Purposes for which water is used: Irrigation
(Domestic, irrigation, municipal, manufacturing, industrial, etc.)

6. Description of Well: Depth 20 feet. Type drilled
(Dug or drilled)

diameter 10 inches. Elevation of ground at well site 300 feet, mean sea level.
(As near as known)

Depth to water table 16 feet.

7. Capacity of Well: 384 g.p.m. with 1 feet drawdown.
_____ g.p.m. with _____ feet drawdown.

Date of test _____

If Flowing Well: Measured discharge _____ g.p.m. on _____
(Date)

Shut-in pressure at ground surface _____ lbs. per sq. in. on _____
(Date)

Water is controlled by _____
(Cap. valve, etc.)

8. Casing: (Give diameter, commercial specifications and depth below ground surface of each casing size.)

..... inch diameter from to feet

..... inch diameter from to feet

..... inch diameter from to feet

..... inch diameter from to feet

Describe and show depth of shoe, plug, adapter, liner or other details:

.....

9. Perforated Casings or Screens:

..... from to

(Number per foot and size of perforations, or describe screen)

..... from to

..... from to

..... from to

10. Log of Well: (Describe each stratum or formation clearly, indicate if water bearing, and give thickness and depth as indicated.)

MATERIAL	Thickness (Feet)	Depth to Bottom (Feet)

If log of well is not available, give name and address of driller. Raymond K. Baker

Albany, Oregon

11. Infiltration Trench: Covered or open

Dimensions: Length _____ ft. Minimum depth _____ ft. Maximum depth _____ ft.

Bottom width _____ ft. Discharge _____ g.p.m. Date of test _____

12. Tunnel: Type of lining _____

Dimensions: _____ (Length, course, and cross sectional size)

Position of water bearing stratum with reference to portal of tunnel _____

Log of tunnel: (Preceding table for log of well may be used, if desired. Give footage from portal and character of materials, as pertinent.)

13. Pumping Equipment:

(a) Pump Rain Flow 3 in Capacity 385 g.p.m.
(Make, type and size)

(b) Motor General Electric 20 Horsepower
(Type and horsepower)

14. Location of area irrigated or to be irrigated, or place of use if for purposes other than irrigation.

Township North or South	Range E. or W. of Willamette Meridian	Section	Forty-acre Tract	Number Acres To Be Irrigated	Date of Reclamation
<u>15S</u>	<u>4W</u>	<u>9</u>	<u>NW 1/4 SW 1/4</u>	<u>26[±]</u>	<u>1953</u>
"	"	"	<u>NE 1/4 + SW 1/4</u>	<u>10[±]</u>	"
				<u>36[±] Ac</u>	"

15. If the ground water supply is supplemental to an existing water supply, identification of any application for a permit, permit, certificate or adjudicated right to appropriate water made or held by the registrant.

Township 15S Range 4W W.M.
North

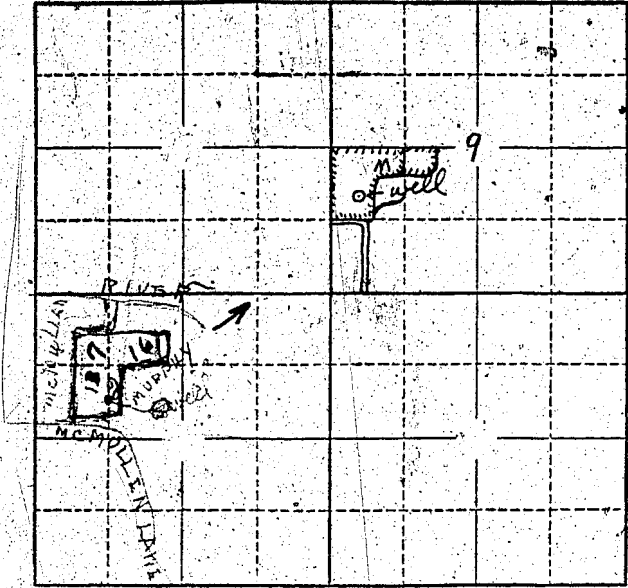

Locate well and acreage of irrigated land on plat.
Scale: 2" = 1 Mile

STATE OF OREGON }
County of Lane } ss.

I, Leon Bryson, being first duly sworn, do hereby certify that I have read the foregoing Registration Statement and that all of the items therein contained are true to the best of my knowledge and belief.

Leon Bryson
(Signature of Registrant)

Subscribed and sworn to before me this 2nd day of August, 1958.

My commission expires October 4, 1958

Thomas C. J. [Signature]
(Notary Public)

(SEAL)

CERTIFICATE OF REGISTRATION

STATE OF OREGON }
County of Marion } ss.

This is to certify that the foregoing Registration Statement was received in the office of the State Engineer on the 4 day of August, 1958, at 8:00 o'clock A. M. and has been duly recorded in said office in Book No. 17 of Registration Statements on page GR-4054

Witness my hand this 16th day of May, 1960

Lewis A. Stanley
(State Engineer)

By _____
(Deputy)

\$15.00

GR 4054