

Well #2

Registration No. GR - 4134

Certificate No. GR - 3990

Registration Statement

RECEIVED
AUG 1 1958
STATE ENGINEER
SALEM, OREGON

OF CLAIMANT OF RIGHT TO APPROPRIATE GROUND WATER

RECEIVED
AUG 1 1958
STATE ENGINEER

TO THE STATE ENGINEER OF OREGON:

I, Harley + Frankie Libby #2
of 200 S 43rd St Corvallis County of Benton
(Mailing address)

State of Oregon, do hereby make application for a certificate of registration as evidence of a right to appropriate ground water.

1. Source from which water is withdrawn is Pump Well #2
(Flowing well, pump well, infiltration trench, or tunnel)

2. Location is: 2 miles SW of Corvallis Ore
(Approximate distance and direction from nearest city or town)

and is more particularly described as follows:

(a) 760' N and 96' E of SW COR Section 4
(Give distance and bearing to corner of section or other legal subdivision)

being within SW 1/4 SW 1/4 of Sec. 4, Twp. 12S, Rge. 5W
(Smallest legal subdivision) (N. or S.) (E. or W.)

or (b) within limits of recorded platted property, town or city:

in Lot _____, Block _____ of _____
(Name of plat or addition)

County of _____
(If within city or town, give name)

3. Construction Work was begun on July 1943, was completed on July 1943
(Date) (Date)

and the ground water claimed was first used for the purposes set out below on July 1943
(Date)

since which time the water has been used R. Continuously
(Continuously or intermittently)

from 1943 to 1958
(Date) (Date)

4. Quantity of water claimed and used is 200 gallons per minute; _____ acre feet per year.

5. Purpose or Purposes for which water is used Domestic, ~~Industrial~~, Commercial

Includes (4 motel units, 2 family home - Beauty parlor and service sta)
(Domestic, irrigation, municipal, manufacturing, industrial, etc.)

6. Description of Well: Depth 129 feet. Type Drilled
(Dug or drilled)

diameter 4" inches. Elevation of ground at well site 7.35 feet, mean sea level.
(As near as known)

Depth to water table 20 feet.

7. Capacity of Well: 125 g.p.m. with 6-8 feet drawdown.

_____ g.p.m. with _____ feet drawdown.

Date of test _____

If Flowing Well: Measured discharge _____ g.p.m. on _____
(Date)

Shut-in pressure at ground surface _____ lbs. per sq. in. on _____
(Date)

Water is controlled by _____
(Cap, valve, etc.)

8. Casing: (Give diameter, commercial specifications and depth below ground surface of each casing size.)

No data available

- 4* inch diameter from to feet
- inch diameter from to feet
- inch diameter from to feet
- inch diameter from to feet

Describe and show depth of shoe, plug, adapter, liner or other details:

9. Perforated Casings or Screens:

(Number per foot and size of perforations, or describe screen)

- from to
- from to
- from to
- from to

10. Log of Well: (Describe each stratum or formation clearly, indicate if water bearing, and give thickness and depth as indicated.)

MATERIAL	Thickness (Feet)	Depth to Bottom (Feet)
<i>No data available</i>		

Township 125 Range 5W, W.M.
North

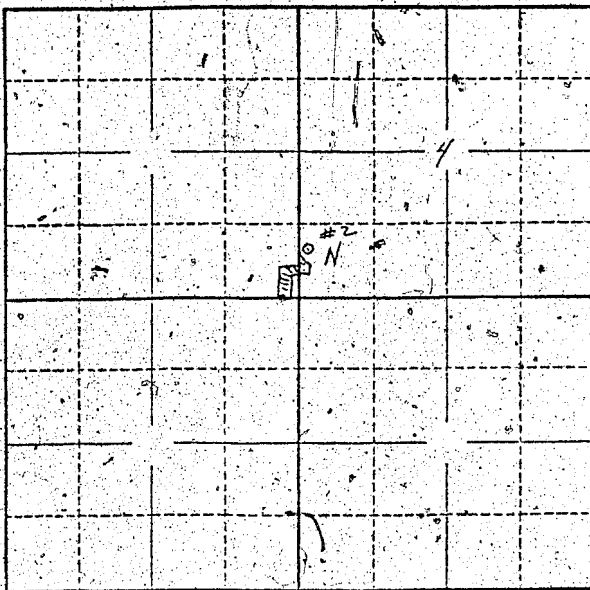

Locate well and acreage of irrigated land on plat.

Scale: 2" = 1 Mile

STATE OF OREGON

County of Lincoln } ss.

I, Franklin A. Stanley, being first duly sworn, do hereby certify that I have read the foregoing Registration Statement and that all of the items therein contained are true to the best of my knowledge and belief.

Franklin A. Stanley
(Signature of Registrant)

Subscribed and sworn to before me this 2 day of February, 1960.

My commission expires Jan 15 1961

James H. Williams
(Notary Public)

(SEAL)

CERTIFICATE OF REGISTRATION

STATE OF OREGON

County of Marion } ss.

This is to certify that the foregoing Registration Statement was received in the office of the State Engineer on the 4 day of August, 1958, at 8:00 o'clock A. M. and has been duly recorded in said office in Book No. 16 of Registration Statements on page 62-3990

Witness my hand this 15th day of February, 1960.

Lewia A. Stanley
(State Engineer)

By _____

(Deputy)

GR 3990

\$20.00