

Registration Statement

OF CLAIMANT OF RIGHT TO APPROPRIATE GROUND WATER

TO THE STATE ENGINEER OF OREGON:

I, Leonard H Zilleke
of Salem, Ore County of Marion
(Mailing address)

State of Oregon, do hereby make application for a certificate of registration as evidence of a right to appropriate ground water.

1. Source from which water is withdrawn is Pump Well
(Flowing well, pump well, infiltration trench, or tunnel)

2. Location is: approx 4 1/2 mi South West of Salem
(Approximate distance and direction from nearest city or town)

and is more particularly described as follows:

(a) 115' S. E 638' W from the N 1/4 cor. of Sec. 7
(Give distance and bearing to corner of section or other legal subdivision)

being within NE 1/4 NW 1/4 of Sec. 7, Twp. 8 S, Rge. 3 W
(Smallest legal subdivision) (N. or S.) (E. or W.)

or (b) within limits of recorded platted property, town or city:

in Lot _____, Block _____ of _____
(Name of plat or addition)

County of _____
(If within city or town, give name)

3. Construction Work was begun on 1943; was completed on 1943
(Date) (Date)

and the ground water claimed was first used for the purposes set out below on

since which time the water has been used Continuously
(Continuously or intermittently)

from 1943 to 1958
(Date) (Date)

4. Quantity of water claimed and used is 14 gallons per minute; _____ acre feet per year.
(Exempt)

5. Purpose or Purposes for which water is used Irrigation

(Domestic, irrigation, municipal, manufacturing, industrial, etc.)

6. Description of Well: Depth 135 feet. Type drilled
(Dug or drilled)

diameter 6 inches. Elevation of ground at well site 235 feet, mean sea level.
(As near as known)

Depth to water table 18 feet. 1943

7. Capacity of Well: _____ g.p.m. with _____ feet drawdown.

_____ g.p.m. with _____ feet drawdown.

Date of test _____

If Flowing Well: Measured discharge _____ g.p.m. on _____
(Date)

Shut-in pressure at ground surface _____ lbs. per sq. in. on _____
(Date)

Water is controlled by _____
(Cap, valve, etc.)

8. Casing: (Give diameter, commercial specifications and depth below ground surface of each casing size.)

6 inch diameter *Steel casing* from 0 to 40 feet
inch diameter from to feet
inch diameter from to feet
inch diameter from to feet

Describe and show depth of shoe, plug, adapter, liner or other details:
.....
.....

9. Perforated Casings or Screens:

N.D. from to
(Number per foot and size of perforations, or describe screen)
from to
from to
from to

10. Log of Well: (Describe each stratum or formation clearly, indicate if water bearing, and give thickness and depth as indicated.)

MATERIAL	Thickness (Feet)	Depth to Bottom (Feet)
<i>unknown</i>		

If log of well is not available, give name and address of driller. Marion West.

11. Infiltration Trench: Covered or open _____
 Dimensions: Length _____ ft. Minimum depth _____ ft. Maximum depth _____ ft.
 Bottom width _____ ft. Discharge _____ g.p.m. Date of test _____

12. Tunnel: Type of lining _____
 Dimensions: _____
(Length, course, and cross sectional size)
 Position of water bearing stratum with reference to portal of tunnel _____

Log of tunnel: (Preceding table for log of well may be used, if desired. Give footage from portal and character of materials, as pertinent.)

13. Pumping Equipment:
 (a) Pump Jacuzzi Jet Pulpwell Capacity 16 g.p.m.
(Make, type and size)
 (b) Motor 1 1/2 Electric
(Type and horsepower)

14. Location of area irrigated or to be irrigated, or place of use if for purposes other than irrigation.

Township North or South	Range E. or W. of Willamette Meridian	Section	Forty-acre Tract	Number Acres To Be Irrigated	Date of Reclamation
8 S	3W	6	SE 1/4 SW 1/4	10.0	1943

15. If the ground water supply is supplemental to an existing water supply, identification of any application for a permit, permit, certificate or adjudicated right to appropriate water made or held by the registrant.

Township 85 Range 3W W.M.
North

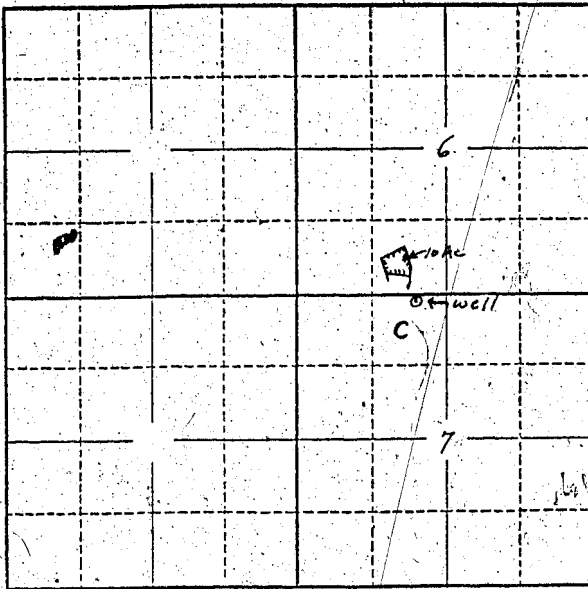

Locate well and acreage of irrigated land on plat.
Scale: 2" = 1 Mile

STATE OF OREGON

County of Marion } ss.

I, Leonard H Zielke being first duly sworn, do hereby certify that I have read the foregoing Registration Statement and that all of the items therein contained are true to the best of my knowledge and belief.

Leonard H Zielke
(Signature of Registrant)

Subscribed and sworn to before me this 4th day of August, 1958

My commission expires 12th June 1961

Wm. S. Bartholomew
(Notary Public)

(SEAL)

CERTIFICATE OF REGISTRATION

STATE OF OREGON

County of Marion } ss.

This is to certify that the foregoing Registration Statement was received in the office of the State Engineer on the 4th day of August, 1958, at 4:00 o'clock P. M. and has been duly recorded in said office in Book No. 15 of Registration Statements on page GR- 3737

Witness my hand this 20th day of October, 1959

Lewis A. Stanley
(State Engineer)

By _____
(Deputy)

\$15.00

GR. 3737