

# Registration Statement

## OF CLAIMANT OF RIGHT TO APPROPRIATE GROUND WATER

TO THE STATE ENGINEER OF OREGON:

WE 1 Wm. J. + Carolyn R. Jackson  
of Rt. 2 Box 318 Milton-Sreewater County of Umatilla  
(Mailing address)

State of Oregon, do hereby make application for a certificate of registration as evidence of a right to appropriate ground water.

1. Source from which water is withdrawn is Pumped Well  
(Flowing well, pump well, infiltration trench, or tunnel)

2. Location is: 3 miles N.W. of Milton-Sreewater  
(Approximate distance and direction from nearest city or town)

and is more particularly described as follows:

(a) 330' E + 640' S of NW cor. of NW 1/4 of NE 1/4 of Sec 34  
(Give distance and bearing to corner of section or other legal subdivision)  
being within NW 1/4 NE 1/4 NE 1/4 of Sec. 34 Twp. 6 N Rge. 35 E  
(Smallest legal subdivision) (N. or S.) (E. or W.)

or (b) within limits of recorded platted property, town or city:

in Lot \_\_\_\_\_, Block \_\_\_\_\_ of \_\_\_\_\_  
(Name of plat or addition)  
County of \_\_\_\_\_  
(If within city or town, give name)

3. Construction Work was begun on 1907; was completed on 1907  
(Date) (Date)

and the ground water claimed was first used for the purposes set out below on 1907  
(Date)

since which time the water has been used Continuously  
(Continuously or intermittently)

from April 15 to October 1  
(Date) (Date)

4. Quantity of water claimed and used is 200 gallons per minute; 120 acre  
feet per year.

5. Purpose or Purposes for which water is used Irrigation

(Domestic, irrigation, municipal, manufacturing, industrial, etc.)

6. Description of Well: Depth 63 feet. Type Dug + Drilled  
(Dug or drilled)

diameter 8" inches. Elevation of ground at well site \_\_\_\_\_ feet, mean sea level.  
(As near as known)

Depth to water table 25 feet. low of 40'

7. Capacity of Well: \_\_\_\_\_ g.p.m. with \_\_\_\_\_ feet drawdown  
\_\_\_\_\_ g.p.m. with \_\_\_\_\_ feet drawdown

Date of test \_\_\_\_\_ No Test

If Flowing Well: Measured discharge \_\_\_\_\_ g.p.m. on \_\_\_\_\_  
(Date)

Shut-in pressure at ground surface \_\_\_\_\_ lbs. per sq. in. on \_\_\_\_\_  
(Date)

Water is controlled by \_\_\_\_\_  
(Cap, valve, etc.)

8. Casing: (Give diameter, commercial specifications and depth below ground surface of each casing size.)

5' x 5' inch diameter Concrete from 0 to 12 feet  
..... inch diameter ..... from 45 to 53 feet  
..... inch diameter ..... from ..... to ..... feet  
..... inch diameter ..... from ..... to ..... feet

Describe and show depth of shoe, plug, adapter, liner or other details:  
.....  
.....

9. Perforated Casings or Screens:

..... from ..... to .....  
(Number per foot and size of perforations, or describe screen)  
..... from ..... to .....  
..... from ..... to .....  
..... from ..... to .....

10. Log of Well: (Describe each stratum or formation clearly, indicate if water bearing, and give thickness and depth as indicated.)

MATERIAL	Thickness (Feet)	Depth to Bottom (Feet)
No log		

If log of well is not available, give name and address of driller. ....

11. Infiltration Trench: Covered or open .....

Dimensions: Length ..... ft. Minimum depth ..... ft. Maximum depth ..... ft.

Bottom width ..... ft. Discharge ..... g.p.m. Date of test .....

12. Tunnel: Type of lining .....

Dimensions: .....  
(Length, course, and cross sectional size)

Position of water bearing stratum with reference to portal of tunnel .....

Log of tunnel: (Preceding table for log of well may be used, if desired. Give footage from portal and character of materials, as pertinent.)

13. Pumping Equipment:

(a) Pump Cook Turbine Capacity 200 g.p.m.  
(Make, type and size)

(b) Motor 3 H.P.  
(Type and horsepower)

14. Location of area irrigated or to be irrigated, or place of use if for purposes other than irrigation.

Township North or South	Range E. or W. of Willamette Meridian	Section	Forty-acre Tract	Number Acres To Be Irrigated	Date of Reclamation
<u>6N</u>	<u>35E</u>	<u>34</u>	<u>NE 1/4 NE 1/4</u>	<u>8</u>	<u>1907</u>

15. If the ground water supply is supplemental to an existing water supply, identification of any application for a permit, permit, certificate or adjudicated right to appropriate water made or held by the registrant.

Township 6N Range 35E, W.M.  
North

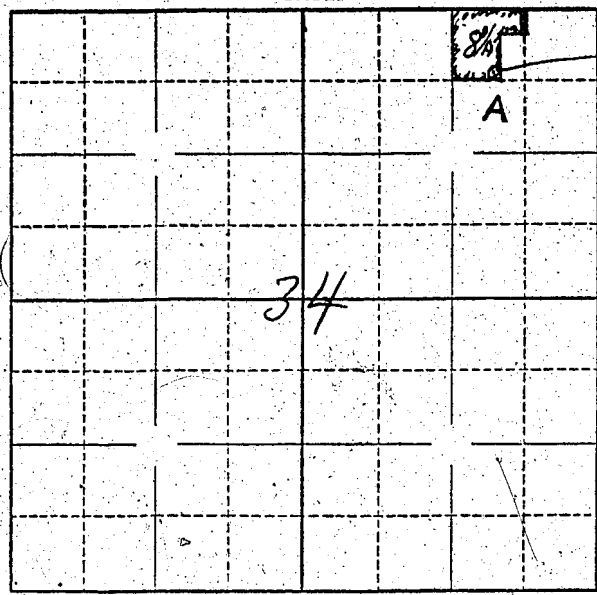

Well Location  
330 EFT 640 S of  
NW Cor of NW 4 of  
NE 4 of NE 4 of Sec 34

Locate well and acreage of irrigated land on plat.

Scale: ~~1/4"~~ 4" = 1 Mile

STATE OF OREGON

County of Umatilla } ss.

I, Mrs. H. M. Jackson, being first duly sworn, do hereby certify that I have read the foregoing Registration Statement and that all of the items therein contained are true to the best of my knowledge and belief.

Mrs. H. M. Jackson  
(Signature of Registrant)

Subscribed and sworn to before me this 3<sup>rd</sup> day of July, 1958

My commission expires October 6<sup>th</sup> 1960 J. K. Hodde  
(Notary Public)

(SEAL)

CERTIFICATE OF REGISTRATION

STATE OF OREGON

County of Marion } ss.

This is to certify that the foregoing Registration Statement was received in the office of the State Engineer on the 4<sup>th</sup> day of August, 1958, at 2:00 o'clock A. M. and has been duly recorded in said office in Book No. 15 of Registration Statements on page GR 3739

Witness my hand this 20<sup>th</sup> day of October, 1959

Laura A. Stanley  
(State Engineer)

\$15.00

By \_\_\_\_\_ (Deputy)

GR 3739