

RECEIVED
DEC 20 1961

Registration No. GR. 4311

Certificate No. GR. 412

STATE ENGINEER
OREGON

Registration Statement

OF CLAIMANT OF RIGHT TO APPROPRIATE GROUND WATER

TO THE STATE ENGINEER OF OREGON:

I, H. NIKLAS, President of Clackamas Greenhouses, Inc., an Oregon corporation,

of Clackamas County of Clackamas

(Mailing address)

State of Oregon, do hereby make application for a certificate of registration as evidence of a right to appropriate ground water.

1. Source from which water is withdrawn is pump well

(Flowing well, pump well, infiltration trench, or tunnel)

2. Location is: approximately one-half mile South of city center of Clackamas, Oregon;

(Approximate distance and direction from nearest city or town)

and is more particularly described as follows:

(a) 200 feet North and 300 feet East of the S.W. corner of Section 9, T2S, R2E, WM,

(Give distance and bearing to corner of section or other legal subdivision)

being within Tax Lot 23 SW 1/4 of Sec. 9 and 1/2 Twp. 2S, Rge. 2E

(Smallest legal subdivision)

(N. or S.)

(E. or W.)

or (b) within limits of recorded platted property, town or city:

in Lot _____, Block _____ of _____

(Name of plat or addition)

County of Clackamas

(If within city or town, give name)

3. Construction Work was begun on May, 1920, was completed on May, 1920

(Date)

(Date)

and the ground water claimed was first used for the purposes set out below on May, 1920

(Date)

since which time the water has been used continuously

(Continuously or Intermittently)

from May, 1920 to Present time.

(Date)

(Date)

4. Quantity of water claimed and used is 10,000 gallons per ~~minute~~ day. acre feet per year.

5. Purpose or Purposes for which water is used watering plants in commercial greenhouse,
approximately two acres under glass.

(Domestic, irrigation, municipal, manufacturing, industrial, etc.)

6. Description of Well: Depth 29 feet. Type drilled

(Dug or drilled)

diameter six inches. Elevation of ground at well site 150 feet, mean sea level.

(As near as known)

Depth to water table 20 feet.

7. Capacity of Well: unknown g.p.m. with _____ feet drawdown.
_____ g.p.m. with _____ feet drawdown.

Date of test _____

If Flowing Well: Measured discharge _____ g.p.m. on _____

(Date)

Shut-in pressure at ground surface _____ lbs. per sq. in. on _____

(Date)

Water is controlled by _____

(Cap, valve, etc.)

Township 2S Range 2E W.M.
North

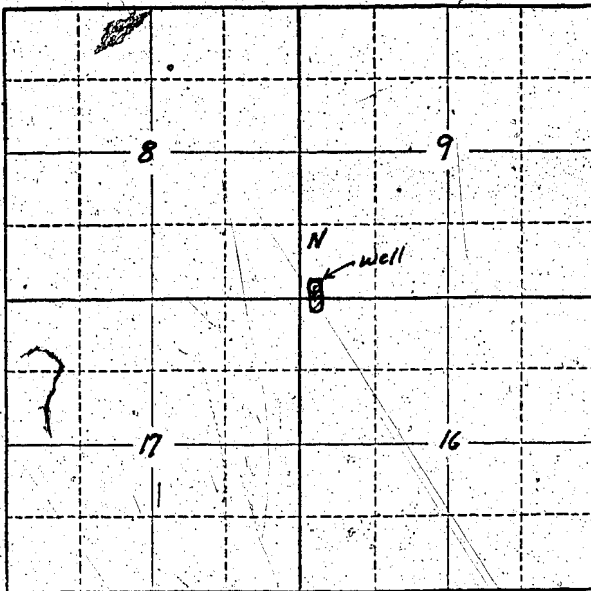

Locate well and acreage of irrigated land on plat.
Scale: 2" = 1 Mile

STATE OF OREGON

County of Multnomah

} ss.

I, H. Niklas, being first duly sworn, do hereby certify that I have read the foregoing Registration Statement and that all of the items therein contained are true to the best of my knowledge and belief.

H. Niklas
(Signature of Registrant)

President, Clackamas Greenhouses, Inc.

Subscribed and sworn to before me this 8th day of December, 1961

My commission expires March 13, 1961

Stanley J. Bauer
(Notary Public for Oregon)

(SEAL)

CERTIFICATE OF REGISTRATION

STATE OF OREGON

County of Marion

} ss.

This is to certify that the foregoing Registration Statement was received in the office of the State Engineer on the 20th day of December, 1961, at 8:20 o'clock A.M. and has been duly recorded in said office in Book No. 17 of Registration Statements on page GR-4

Witness my hand this 5th day of January, 1962

Lewis A. Stanley
(State Engineer)

By _____ (Deputy)

1/5.22

GR 4112