

Registration Statement

OF CLAIMANT OF RIGHT TO APPROPRIATE GROUND WATER

Received 9 March, 1962
W.S.B.

TO THE STATE ENGINEER OF OREGON:

I, Gordon W. Elliott

of 938 Jefferson St. Eugene County of Lane

State of Oregon do hereby make application for a certificate of registration as evidence of a right to appropriate ground water.

1. Source from which water is withdrawn is Pump well # 1
(flowing well, pump well, infiltration trench, or tunnel)

2. Location is: 6 1/2 Mi. North of Eugene, Ore.
(Approximate distance and direction from nearest city or town)

and is more particularly described as follows:

(a) 825' W & 690' S from center of Section 3
(Give distance and bearing to corner of section or other legal subdivision)

being within NE 1/4 of SW 1/4 of Sec. 3, Twp. 17 S, Rge. 4 W
(Smallest legal subdivision) (N or S) (E or W)

or (b) within limits of recorded platted property, town or city:

in Lot _____, Block _____ of _____
(Name of plat or addition)

County of _____
(If within city or town, give name)

3. Construction Work was begun on April 1952, was completed on May 1952
(Date) (Date)

and the ground water claimed was first used for the purposes set out below on JUNE 1952
(Date)

since which time the water has been used _____
(Continuously or ~~intermittently~~)

from June 1952 to Present
(Date) (Date)

4. Quantity of water claimed and used is 440 gallons per minute; _____ acre feet per year.

5. Purpose or Purposes for which water is used irrigation
(Domestic, irrigation, municipal, manufacturing, industrial, etc.)

6. Description of Well: Depth 114' feet. Type Drill
(Dug or drilled)

diameter 8 inches. Elevation of ground at well site 365 feet, mean sea level.
(As near as known)

Depth to water table 12 feet.

7. Capacity of Well: 440 g.p.m. with 92 feet drawdown.

_____ g.p.m. with _____ feet drawdown.

Date of test May 1952

If Flowing Well: Measured discharge _____ g.p.m. on _____
(Date)

Shut-in pressure at ground surface _____ lbs. per sq. in. on _____
(Date)

Water is controlled by _____
(Cap, valve, etc.)

8. Casing: (Give diameter, commercial specifications and depth below ground surface of each casing size.)

8 inch diameter *steel casing* from 0 to 110 feet
inch diameter from to feet
inch diameter from to feet
inch diameter from to feet

Describe and show depth of shoe, plug, adapter, liner or other details:

9. Perforated Casings or Screens:

100' of 8" Perforated casing from 0' to 110'
(Number per foot and size of perforations, or describe screen)
from to
from to
from to

10. Log of Well: (Describe each stratum or formation clearly, indicate if water bearing, and give thickness and depth as indicated.)

MATERIAL	Thickness (Feet)	Depth to Bottom (Feet)
<i>NONE</i>		

If log of well is not available, give name and address of driller, *unk*

11. Infiltration Trench: Covered or open

Dimensions: Length ft. Minimum depth ft. Maximum depth ft.
 Bottom width ft. Discharge g.p.m. Date of test

12. Tunnel: Type of lining

Dimensions:
(Length, course, and cross sectional size)

Position of water bearing stratum with reference to portal of tunnel

Log of tunnel: (Preceding table for log of well may be used, if desired. Give footage from portal and character of materials, as pertinent.)

13. Pumping Equipment:

(a) Pump *Jacuzzi Sirechaft turbine 5" Dia* capacity *390* g.p.m.
(Make, type and size)
 (b) Motor *3 PH 220 Volt 60 Cycle 2.5 H.P.*
(Type and horsepower)

14. Location of area irrigated or to be irrigated, or place of use if for purposes other than irrigation.

Township North or South	Range E or W of Willamette Meridian	Section	Forty-acre Tract	Number Acres To Be Irrigated	Date of Reclamation
<i>17S</i>	<i>4</i>	<i>3</i>	<i>SE 1/4 or NW 1/4</i>	<i>24.0</i>	<i>1952</i>
"	"	<i>3</i>	<i>NE 1/4 " SW 1/4</i>	<i>26.0</i>	"
"	"	<i>3</i>	<i>SE 1/4 " SW 1/4</i>	<i>3.0</i>	"
				<i>53.0 AC</i>	"

15. If the ground water supply is supplemental to an existing water supply, identification of any application for a permit, permit, certificate or adjudicated right to appropriate water made or held by the registrant.

Township 17 S Range 4 W, W.M.
North

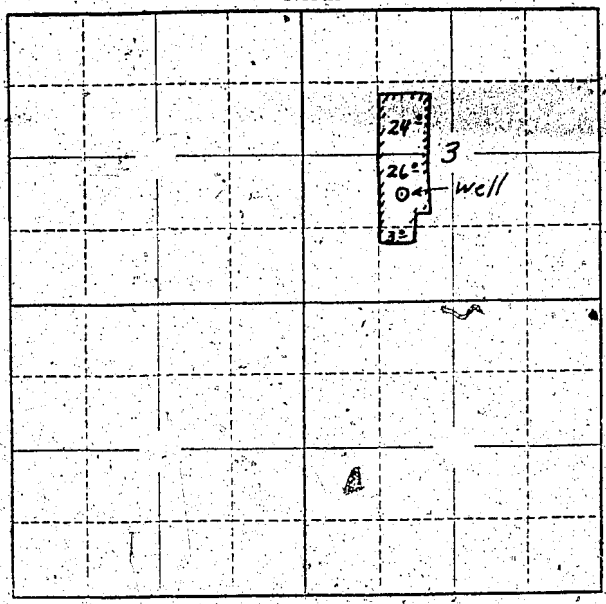

Locate well and acreage of irrigated land on plat.
Scale: 2" = 1 Mile

STATE OF OREGON
County of Lane

I, Gordon W. Elliott, being first duly sworn, do hereby certify that I have read the foregoing Registration Statement and that all of the items therein contained are true to the best of my knowledge and belief.

Gordon W. Elliott
(Signature of Registrant)

Subscribed and sworn to before me this 9 day of March, 1962.

My commission expires 2-10-64

James W. Carver
(Notary Public)

(SEAL)

CERTIFICATE OF REGISTRATION

STATE OF OREGON
County of Marion

This is to certify that the foregoing Registration Statement was received in the office of the State Engineer on the 9th day of March, 1962 at 11:30 o'clock A.M. and has been duly recorded in said office in Book No. 17 of Registration Statements on page GR-1116

Witness my hand this 12th day of March, 1962

Lewis A. Stanley
(State Engineer)

\$18.45

By _____
(Deputy)

GR 4116