

RECEIVED
STATE ENGINEER
LAND DIVISION

Registration No. GR - 4267
Certificate No. GR - 4118

Registration Statement

OF CLAIMANT OF RIGHT TO APPROPRIATE GROUND WATER

TO THE STATE ENGINEER OF OREGON:

I, Floyd T. Ellefson

of 2524 North 31st Street, Springfield County of Lane

State of Oregon, do hereby make application for a certificate of registration as evidence of a right to appropriate ground water.

1. Source from which water is withdrawn is Driven Well
(Flowing well, pump well, infiltration trench, or tunnel)

2. Location is: 3 miles N.E. of Springfield
(Approximate distance and direction from nearest city or town)

and is more particularly described as follows:

(a) 1230 feet east and 700 feet north from S.E. Corner Section 19
(Give distance and bearing to corner of section or other legal subdivision)

being within S.W. 1/4 of S.W. 1/4 of Sec. 19, Twp. 17 S., Rge. 2 W.
(Smallest legal subdivision) (S. or S.) (E. or W.)

or (b) within limits of recorded platted property, town or city:

in Lot _____, Block _____ of _____
(Name of plat or addition)

County of Lane
(If within city or town, give name)

3. Construction Work was begun on August 1, 1954; was completed on same day
(Date) (Date)

and the ground water claimed was first used for the purposes set out below on August 5, 1954
(Date)

since which time the water has been used during season
(Continuously or intermittently)

from August 1954 to March 1962
(Date) (Date)

4. Quantity of water claimed and used is 25 gallons per minute; _____ acre feet per year.

5. Purpose or Purposes for which water is used garden irrigation
(Domestic, irrigation, municipal, manufacturing, industrial, etc.)

6. Description of Well: Depth 20 feet. Type Driven Pipe
(Dug or drilled)

diameter 3 inches. Elevation of ground at well site 150 feet, mean sea level.
(As near as known)

Depth to water table 12 to 14 feet.

7. Capacity of Well: 213 g.p.m. with 2 feet drawdown.

_____ g.p.m. with _____ feet drawdown.

Date of test August 1, 1954

If Flowing Well: Measured discharge _____ g.p.m. on _____
(Date)

Shut-in pressure at ground surface _____ lbs. per sq. in. on _____
(Date)

Water is controlled by _____
(Cap, valve, etc.)

8. Casing: (Give diameter, commercial specifications and depth below ground surface of each casing size.)

3 inch diameter Pipe from 0 to 17 feet
inch diameter from to feet
inch diameter from to feet
inch diameter from to feet

Describe and show depth of shoe, plug, adapter, liner or other details:

9. Perforated Casings or Screens:

Yes Well Point from 17 to 20
(Number per foot and size of perforations, or describe screen)
from to
from to
from to

10. Log of Well: (Describe each stratum or formation clearly, indicate if water bearing, and give thickness and depth as indicated.)

MATERIAL	Thickness (Feet)	Depth to Bottom (Feet)
Loam and Gravel-some sand	20	

If log of well is not available, give name and address of driller. Meyer Well Service

11. Infiltration Trench: Covered or open

Dimensions: Length ft. Minimum depth ft. Maximum depth ft.

Bottom width ft. Discharge g.p.m. Date of test

12. Tunnel: Type of lining

Dimensions: (Length, course, and cross sectional size)

Position of water bearing stratum with reference to portal of tunnel

Log of tunnel: (Preceding table for log of well may be used, if desired. Give footage from portal and character of materials, as pertinent.)

13. Pumping Equipment:

(a) Pump Jacuzzi Centrifugal Capacity 25 g.p.m.
(Make, type and size)

(b) Motor 1 1/2 H.P. Electric
(Type and horsepower)

14. Location of area irrigated or to be irrigated, or place of use if for purposes other than irrigation.

Township North or South	Range E. or W. of Willamette Meridian	Section	Forty-acre Tract	Number Acres To Be Irrigated	Date of Reclamation
T17S	R2W	19	S.W. 1/4 of S.W. 1/4	1.67	Aug. 5, 1954

15. If the ground water supply is supplemental to an existing water supply, identification of any application for a permit, permit, certificate or adjudicated right to appropriate water made or held by the registrant.

Township 17S Range 2W, W.M.
North

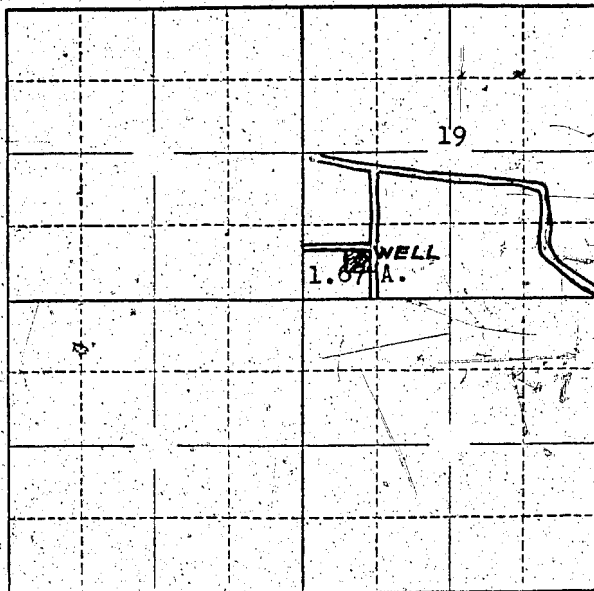

Locate well and acreage of irrigated land on plat.
Scale: 2" = 1 Mile

STATE OF OREGON

County of Clatsop

ss.

I, Alfred I. Stanley, being first duly sworn, do hereby certify that I have read the foregoing Registration Statement and that all of the items therein contained are true to the best of my knowledge and belief.

Alfred I. Stanley
(Signature of Registrant)

Subscribed and sworn to before me this 17th day of March, 1962

My commission expires My Commission Expires

W. H. [Signature]
(Notary Public)

(SEAL)

CERTIFICATE OF REGISTRATION

STATE OF OREGON

County of Marion

ss.

This is to certify that the foregoing Registration Statement was received in the office of the State Engineer on the 30th day of March, 1962, at 8:00 o'clock A.M. and has been duly recorded in said office in Book No. 17 of Registration Statements on page GR-1118

Witness my hand this 25th day of April, 1962

LEWIS A. STANLEY
(State Engineer)

By [Signature]
(Deputy)

\$15.00

GR-1118