

Registration Statement

OF CLAIMANT OF RIGHT TO APPROPRIATE GROUND WATER

TO THE STATE ENGINEER OF OREGON:

I, McCormick & Baxter Creosoting Company
of P. O. Box 3344, Portland 8, Oregon County of Multnomah
(Mailing address)
State of Oregon do hereby make application for a certificate of registration as evidence
of a right to appropriate ground water.

1. Source from which water is withdrawn is pump well
(Flowing well, pump well, infiltration trench, or tunnel)
2. Location is: In city of Portland, Oregon (St. Johns)
(Approximate distance and direction from nearest city or town)

and is more particularly described as follows:

(a) N13°38.6'W 4215.6 Ft. to NW Cor. Sec. 7 TIN RIE
(Give distance and bearing to corner of section or other legal subdivision)
being within SW1/4SW1/4 of Sec. 7, Twp. IN, Rge. IE
(Smallest legal subdivision) (N. or S.) (E. or W.)
or (b) within limits of recorded platted property, town or city: Unplatted
in Lot _____, Block _____ of _____
(Name of plat or addition)
Portland County of Multnomah
(If within city or town, give name.)

3. Construction Work was begun on September 1945; was completed on September 1945
(Date) (Date)
and the ground water claimed was first used for the purposes set out below on late September 1945,
(Date)
since which time the water has been used continuously
(Continuously or intermittently)
from late Sept. 1945 to April 1962
(Date) (Date)

4. Quantity of water claimed and used is 750 GPM - 165 ft.
1760 RPM gallons per minute; _____ acre
feet per year.

5. Purpose or Purposes for which water is used Industrial
(Domestic, irrigation, municipal, manufacturing, industrial, etc.)

6. Description of Well: Depth 130' feet. Type Drilled
(Dug or drilled)
diameter 12 inches. Elevation of ground at well site 20 feet, mean sea level.
(As near as known)
Depth to water table 23 feet.

7. Capacity of Well: 1200 g.p.m. with 0 feet drawdown.
1300 g.p.m. with 8' feet drawdown.
Date of test Approx. September 22, 1945

If Flowing Well: Measured discharge _____ g.p.m. on _____
(Date)
Shut-in pressure at ground surface _____ lbs. per sq. in. on _____
(Date)
Water is controlled by _____
(Ccp., valve, etc.)

8. Casing: (Give diameter, commercial specifications and depth below ground surface of each casing size.)

12" inch diameter from 0 to 130 feet
 inch diameter from to feet
 inch diameter from to feet
 inch diameter from to feet

Describe and show depth of shoe, plug, adapter, liner or other details:

.....

.....

9. Perforated Casings or Screens:

Casing perforated from 65' to 124'
(Number per foot and size of perforations, or describe screen)
 Size of perforations not known. from to
 from to
 from to

10. Log of Well: (Describe each stratum or formation clearly, indicate if water bearing, and give thickness and depth as indicated.)

MATERIAL	Thickness (Feet)	Depth to Bottom (Feet)
Dredged sand	12'	118'
Silt, clay and very fine sand	48'	70'
Coarse sand with water	24'	46'
Gravel with clay binder	21'	25'
Cemented gravel	13'	12'
Gravel with a little water	5'	7'
Cemented gravel	7'	0'

If log of well is not available, give name and address of driller. R. J. Strasser Drilling Co.,
Portland, Oregon

11. Infiltration Trench: Covered or open Covered
 Dimensions: Length ft. Minimum depth ft. Maximum depth ft.
 Bottom width ft. Discharge g.p.m. Date of test

12. Tunnel: Type of lining
 Dimensions:
 (Length, course, and cross sectional size)
 Position of water bearing stratum with reference to portal of tunnel

Log of tunnel: (Preceding table for log-of well may be used, if desired. Give footage from portal and character of materials, as pertinent.)

13. Pumping Equipment:
 (a) Pump Lane Bowler Deep Well Turbine Pump Capacity 750 g.p.m.
 Serial # 11843 (Make, type and size)
 (b) Motor Vertical hollow shaft electric motor - 50 HP - 1760 RPM
220 volt - 60 cycle (Type and horsepower)

14. Location of area irrigated or to be irrigated, or place of use if for purposes other than irrigation.

Township North or South	Range E. or W. of Willamette Meridian	Section	Forty-acre Tract	Number Acres To Be Irrigated	Date of Reclamation
			Industrial usage - condensers, boilers, etc.		
1N	1E	7	Industrial Use at Claimant's plant located within City of Portland, Multnomah County, being Tax Lot #62, in SW Section 7, T. 1N. R. 1E, being 58.15 Acres.		September 19...

15. If the ground water supply is supplemental to an existing water supply, identification of any application for a permit, permit, certificate or adjudicated right to appropriate water made or held by the registrant.

SECTION 7

Township IN Range 1E, W.M.
North

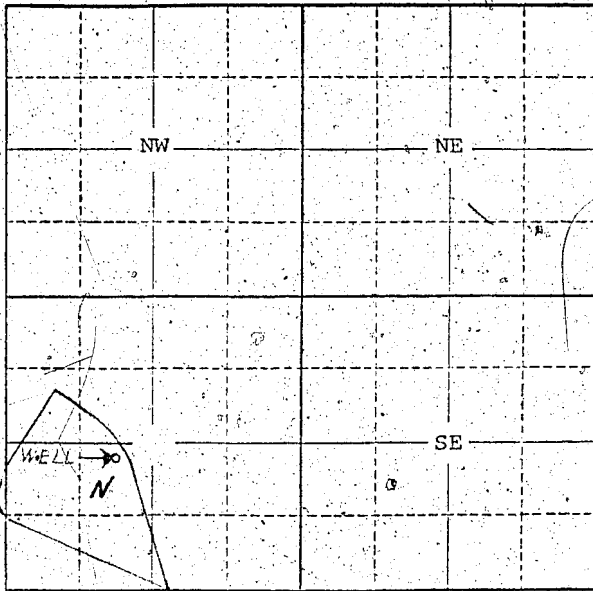

Locate well and acreage of irrigated land on plat.

Scale: $\frac{1}{4}$ " = 1 Mile Industrial Use.

STATE OF OREGON

County of Multnomah } ss.

I, Charles R. McCormick, Jr., being first duly sworn, do hereby certify that I have read the foregoing Registration Statement and that all of the items therein contained are true to the best of my knowledge and belief.

(Signature of Registrant)

President

Subscribed and sworn to before me this 10th day of April, 1962.

My commission expires

(Notary Public)

(SEAL)

CERTIFICATE OF REGISTRATION

STATE OF OREGON

County of Marion } ss.

This is to certify that the foregoing Registration Statement was received in the office of the State Engineer on the 4th day of May, 1962, at 8:00 o'clock A. M. and has been duly recorded in said office in Book No. 17 of Registration Statements on page GR-4121

Witness my hand this 4th day of May, 1962.

Max F. [Signature] Acting (State Engineer)

By _____ (Deputy)

\$ 22.00

GR-4121