

# Registration Statement

## OF CLAIMANT OF RIGHT TO APPROPRIATE GROUND WATER

TO THE STATE ENGINEER OF OREGON:

I, BLUE BELL POTATO CHIP CO. DIVISION OF SUNSHINE BISCUITS, INC.  
a corporation,  
of 100 N.E. Farragut Street, Portland 17 County of Multnomah  
(Mailing address)

State of Oregon, do hereby make application for a certificate of registration as evidence of a right to appropriate ground water.

1. Source from which water is withdrawn is pump well  
(Flowing well, pump well, infiltration trench, or tunnel)

2. Location is: at the company manufacturing plant at 100 N.E. Farragut St., Portland 17, Oregon  
(Approximate distance and direction from nearest city or town)

and is more particularly described as follows:

(a) Estimated 1030 feet east & 900 feet north from S 1/4 corner of section 10  
(Give distance and bearing to corner of section or other legal subdivision)

being within SW 1/4 of SE 1/4 of Sec. 10 Twp. 1N Rge. 1E  
(Smallest legal subdivision) (N. or S.) (E. or W.)

or (b) within limits of recorded platted property, town or city: Portland

in Lot 4 Block 1 of LOVE'S ADDITION  
(Name of plat or addition)  
Portland County of Multnomah  
(If within city or town, give name)

3. Construction Work was begun on June, 1954 was completed on August, 1954  
(Date) (Date)

and the ground water claimed was first used for the purposes set out below on August, 1954  
(Date)

since which time the water has been used continuously  
(Continuously or intermittently)

from August, 1954 to the present.  
(Date) (Date)

4. Quantity of water claimed and used is 500 gallons per minute;          acre feet per year.

5. Purpose or Purposes for which water is used cleaning purposes in manufacturing plant (not for human use).  
(Domestic, irrigation, municipal, manufacturing, industrial, etc.)

6. Description of Well: Depth 287 feet. Type drilled  
(Dug or drilled)

diameter 12 inches. Elevation of ground at well site 50 feet, mean sea level.  
(As near as known)

Depth to water table          feet.

7. Capacity of Well: 500 g.p.m. with          feet drawdown.

         g.p.m. with          feet drawdown.

Date of test         

If Flowing Well: Measured discharge          g.p.m. on           
(Date)

Shut-in pressure at ground surface          lbs. per sq. in. on           
(Date)

Water is controlled by           
(Cap, valve, etc.)



If log of well is not available, give name and address of driller. A.M. Jannsen Well Drilling Co.  
21075 S.W. Tualatin Valley Highway, Aloha, Oregon.

11. Infiltration Trench: Covered or open .....  
 Dimensions: Length ..... ft. Minimum depth ..... ft. Maximum depth ..... ft.  
 Bottom width ..... ft. Discharge ..... g.p.m. Date of test .....

12. Tunnel: Type of lining .....  
 Dimensions: .....  
(Length, course, and cross sectional size)  
 Position of water bearing stratum with reference to portal of tunnel .....

Log of tunnel: (Preceding table for log of well may be used, if desired. Give footage from portal and character of materials, as pertinent.)

13. Pumping Equipment:  
 (a) Pump Lane and Bowler, vertical turbine pump Capacity 650 g.p.m.  
(Make, type and size)  
 (b) Motor 30 H. P., U. S. motor  
(Type and horsepower)

14. Location of area irrigated or to be irrigated, or place of use if for purposes other than irrigation.

Township North or South	Range E. or W. of Willamette Meridian	Section	Forty-acre Tract	Number Acres To Be Irrigated	Date of Reclamation
<u>T1N</u>	<u>R1E</u>	<u>10</u>	<u>SW<sup>1</sup>/<sub>4</sub> of SE<sup>1</sup>/<sub>4</sub></u>	<u>manufacturing</u>	<u>1954</u>

15. If the ground water supply is supplemental to an existing water supply, identification of any application for a permit, permit, certificate or adjudicated right to appropriate water made or held by the registrant.  
 .....  
 .....

Township 1 N Range 1 E W.M.  
North

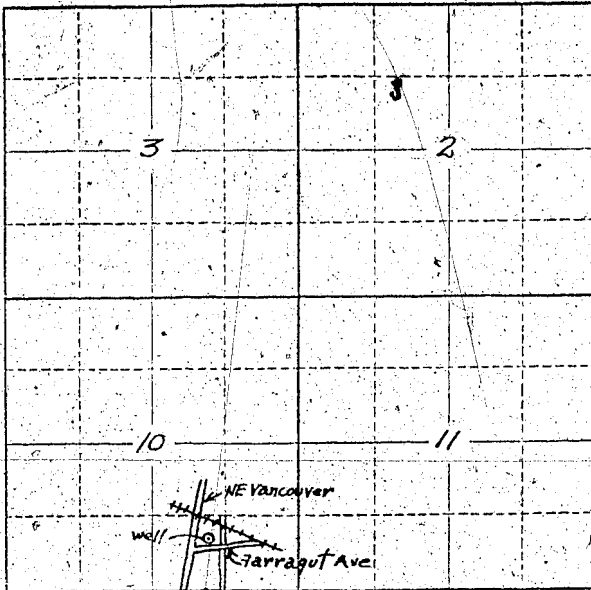

Locate well and acreage of irrigated land on plat.  
Scale: 2" = 1 Mile

STATE OF OREGON

County of Multnomah } ss.

I, Carl A. Dobler, General Manager, being first duly sworn, do hereby certify that I have read the foregoing Registration Statement and that all of the items therein contained are true to the best of my knowledge and belief.

Carl A. Dobler  
(Signature of Registrant)

Subscribed and sworn to before me this 7th day of June, 1962.

My commission expires January 8, 1965.

Allen G. Stetson  
(Notary Public)

(SEAL)

**CERTIFICATE OF REGISTRATION**

STATE OF OREGON

County of Marion } ss.

This is to certify that the foregoing Registration Statement was received in the office of the State Engineer on the 11th day of June, 1962, at 8:00 o'clock A M. and has been duly recorded in said office in Book No. 17 of Registration Statements on page GR-117.

Witness my hand this 25th day of June, 1962.

122.00

Charles L. Stetson  
(State Engineer)

By \_\_\_\_\_ (Deputy)

GR 4127