

RECEIVED
JUL 15 1962
STATE ENGINEER
SALEM, OREGON

Registration No. GR 1277
Certificate No. GR 4129

Registration Statement

OF CLAIMANT OF RIGHT TO APPROPRIATE GROUND WATER

TO THE STATE ENGINEER OF OREGON:

LAWRENCE BAILEY
of Rt. 4 Box 134 EUGENE County of LANE
(Mailing address)

State of OREGON, do hereby make application for a certificate of registration as evidence of a right to appropriate ground water.

1. Source from which water is withdrawn is PUMP WELL
(Flowing well, pump well, infiltration trench, or tunnel)
2. Location is: ONE MILE EAST COSHEN
(Approximate distance and direction from nearest city or town)

and is more particularly described as follows:

(a) 760' N x 210' E of SW cor Sec. 18
(Give distance and bearing to corner of section or other legal subdivision)
being within SW 1/4 SW 1/4 of Sec. 18, Twp. 18 S, Rge. 2 W
(Smallest legal subdivision) (N. or S.) (E. or W.)

or (b) within limits of recorded platted property, town or city:

in Lot _____, Block _____ of _____
(Name of plat or addition)
County of LANE
(If within city or town, give name)

3. Construction Work was begun on JUNE 1945; was completed on JULY 1945
(Date) (Date)

and the ground water claimed was first used for the purposes set out below on _____
(Date)

since which time the water has been used INTERMITTENTLY
(Continuously or intermittently)

from MAY to OCT.
(Date) (Date)

4. Quantity of water claimed and used is 150 gallons per minute; 50 acre feet per year.

5. Purpose or Purposes for which water is used IRRIGATION

(Domestic, irrigation, municipal, manufacturing, industrial, etc.)

6. Description of Well: Depth 19 feet. Type DRILLED
(Dug or drilled)

diameter 2 1/2 inches. Elevation of ground at well site 400 feet, mean sea level.
(As near as known)

Depth to water table 10 feet.

7. Capacity of Well: _____ g.p.m. with _____ feet drawdown.

_____ g.p.m. with _____ feet drawdown.

Date of test no test

If Flowing Well: Measured discharge _____ g.p.m. on _____
(Date)

Shut-in pressure at ground surface _____ lbs. per sq. in. on _____
(Date)

Water is controlled by _____
(Cap, valve, etc.)

Township 18 S Range 2 W, W.M.

North

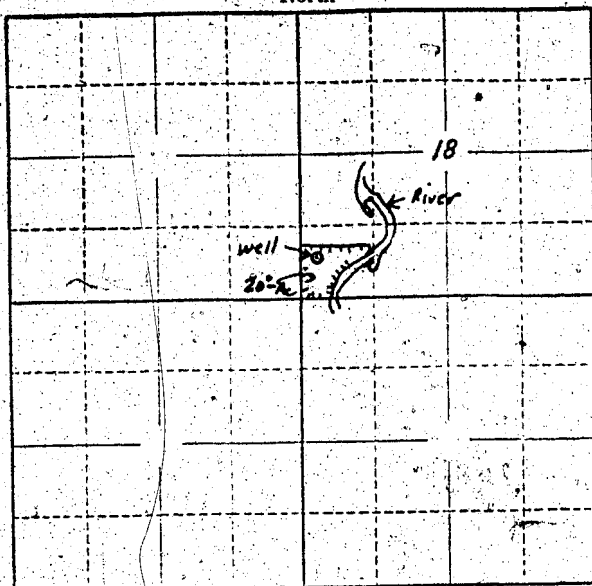

Locate well and acreage of irrigated land on plat.

Scale: 2" = 1 Mile

STATE OF OREGON

County of Lane

ss.

I, Lawrence Baley, being first duly sworn, do hereby certify that I have read the foregoing Registration Statement and that all of the items therein contained are true to the best of my knowledge and belief.

Lawrence Baley
(Signature of Registrant)

Subscribed and sworn to before me this 16th day of July, 1962.

My commission expires August 1, 1963

Charles T. Schuler
(Notary Public)

(SEAL)

CERTIFICATE OF REGISTRATION

STATE OF OREGON

County of Marion

ss.

This is to certify that the foregoing Registration Statement was received in the office of the State Engineer on the 18th day of July, 1962, at 8:00 o'clock A. M. and has been duly recorded in said office in Book No. 17 of Registration Statements on page GR-1124.

Witness my hand this 20th day of July, 1962.

Charles T. Schuler
(State Engineer)

By _____ (Deputy)

\$15.00

GR 1124