

# Registration Statement

## OF CLAIMANT OF RIGHT TO APPROPRIATE GROUND WATER

(Under Chapter 708, Oregon Laws 1955.)

TO THE STATE ENGINEER OF OREGON:

I, Kenneth Holmes

of Route 4, Box 517, Albany County of Benton

State of Oregon, do hereby make application for a certificate of registration as evidence of a right to appropriate ground water.

1. Source from which water is withdrawn is pump well #1  
(Flowing well, pump well, infiltration trench, or tunnel)

2. Location is: 6 miles north of Albany  
(Approximate distance and direction from nearest city or town)

and is more particularly described as follows:

(a) 33 1/2' S 31° 30' west of 1" iron pipe  
(Give distance and bearing to corner of section or other legal subdivision)

being within SW 1/4 of SW 1/4 of Sec. 11, Twp. 10 S, Rge. 4 W, WM  
(Smallest legal subdivision) (N. or S.) (E. or W.)

or (b) within limits of recorded platted property, town or city:

in Lot \_\_\_\_\_, Block \_\_\_\_\_ of \_\_\_\_\_  
(Name of plat or addition)

County of \_\_\_\_\_  
(If within city or town, give name)

3. Construction Work was begun on 1950; was completed on 1950  
(Date) (Date)

and the ground water claimed was first used for the purposes set out below on 1950  
(Date)

since which time the water has been used continuously  
(Continuously or Intermittently)

from 1950 to 1957  
(Date) (Date)

4. Quantity of water claimed and used is 200 gallons per minute; 65 1/2 acre feet per year.

5. Purpose or Purposes for which water is used domestic irrigation

(Domestic, irrigation, municipal, manufacturing, industrial, etc.)

6. Description of Well: Depth 20 feet. Type drilled  
(Dug or drilled)

diameter 10 inches. Elevation of ground at well site 180 feet, mean sea level.  
(As near as known)

Depth to water table 8 feet.

7. Capacity of Well: 200 g.p.m. with 10 feet drawdown.  
\_\_\_\_\_ g.p.m. with \_\_\_\_\_ feet drawdown.

Date of test August pumping level

If Flowing Well: Measured discharge \_\_\_\_\_ g.p.m. on \_\_\_\_\_  
(Date)

Shut-in pressure at ground surface \_\_\_\_\_ lbs. per sq. in. on \_\_\_\_\_  
(Date)

Water is controlled by \_\_\_\_\_  
(Cap, valve, etc.)





Township 105 Range 4W, W.M.  
North

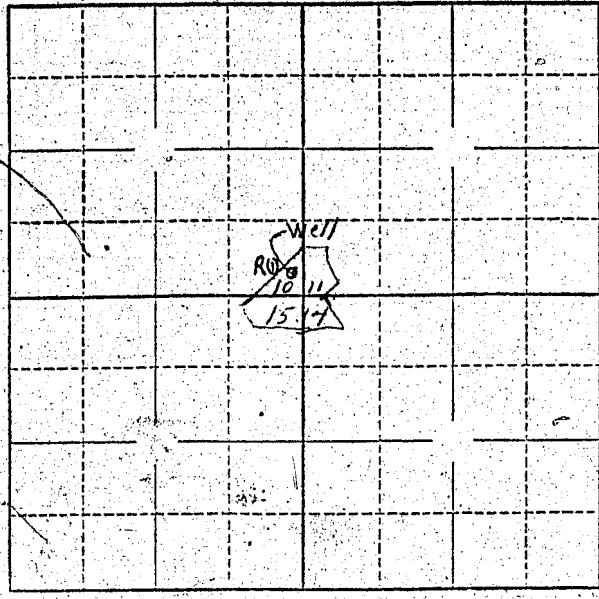

Locate well and acreage of irrigated land on plat.  
Scale: 2" = 1 Mile

STATE OF OREGON }  
County of ..... } ss.

I, \_\_\_\_\_, being first duly sworn, do hereby certify that I have read the foregoing Registration Statement and that all of the items therein contained are true to the best of my knowledge and belief.

X \_\_\_\_\_  
(Signature of Registrant)

Subscribed and sworn to before me this \_\_\_\_\_ day of \_\_\_\_\_, 19\_\_\_\_\_

My commission expires \_\_\_\_\_  
(Notary Public)

(SEAL)

See Page GR-432 K for  
**CERTIFICATE OF REGISTRATION**

STATE OF OREGON }  
County of Marion } ss.

~~This is to certify that the foregoing Registration Statement was received in the office of the State Engineer on the \_\_\_\_\_ day of \_\_\_\_\_, 19\_\_\_\_\_, and has been duly recorded in said office in Book No. \_\_\_\_\_ of Registration Statements on page \_\_\_\_\_.~~

~~Construction shall be completed by \_\_\_\_\_, 19\_\_\_\_\_, and the water completely applied to the fields by \_\_\_\_\_, 19\_\_\_\_\_.~~

Witness my hand this \_\_\_\_\_ day of \_\_\_\_\_, 19\_\_\_\_\_

\_\_\_\_\_  
(State Engineer)

By \_\_\_\_\_  
(Deputy)

# Registration Statement

REGISTRATION NO. GR-446  
CERTIFICATE NO. GR-432

## OF CLAIMANT OF RIGHT TO APPROPRIATE GROUND WATER

(Under Chapter 708, Oregon Laws 1955.)

### TO THE STATE ENGINEER OF OREGON:

I, Kenneth Holmes

of Route 4, Box 517, Albany County of Benton

State of Oregon, do hereby make application for a certificate of registration as evidence of a right to appropriate ground water.

1. Source from which water is withdrawn is pump well #2  
(Flowing well, pump well, infiltration trench, or tunnel)

2. Location is: 6 miles north of Albany  
(Approximate distance and direction from nearest city or town)

and is more particularly described as follows:

(a) 1150' S 60° E of 1" pipe  
(Give distance and bearing to corner of section or other legal subdivision)

being within SW<sup>1</sup> of SW<sup>2</sup> of Sec. 11, Twp. 10S, Rge. 1W, 2W  
(Smallest legal subdivision) (N. or S.) (E. or W.)

or (b) within limits of recorded platted property, town or city:

in Lot \_\_\_\_\_, Block \_\_\_\_\_ of \_\_\_\_\_  
(Name of plat or addition)

County of \_\_\_\_\_  
(If within city or town, give name)

3. Construction Work was begun on 1954; was completed on 1954  
(Date) (Date)

and the ground water claimed was first used for the purposes set out below on 1954  
(Date)

since which time the water has been used continuously  
(Continuously or intermittently)

from 1954 to 1957  
(Date) (Date)

4. Quantity of water claimed and used is 200 gallons per minute; 68 acre feet per year.

5. Purpose or Purposes for which water is used domestic irrigation  
(Domestic, irrigation, municipal, manufacturing, industrial, etc.)

6. Description of Well: Depth 26' feet. Type dug and drilled  
(Dug or drilled)

diameter 8 inches. Elevation of ground at well site 176 feet, mean sea level.  
(As near as known)

Depth to water table 12 feet.

7. Capacity of Well: 200 g.p.m. with 5 feet drawdown.

\_\_\_\_\_ g.p.m. with \_\_\_\_\_ feet drawdown.

Date of test August pumping level

If Flowing Well: Measured discharge \_\_\_\_\_ g.p.m. on \_\_\_\_\_  
(Date)

Shut-in pressure at ground surface \_\_\_\_\_ lbs. per sq. in. on \_\_\_\_\_  
(Date)

Water is controlled by \_\_\_\_\_  
(Cap, valve, etc.)

GR - 432 D





Township 10 Range 4, W.M.  
North

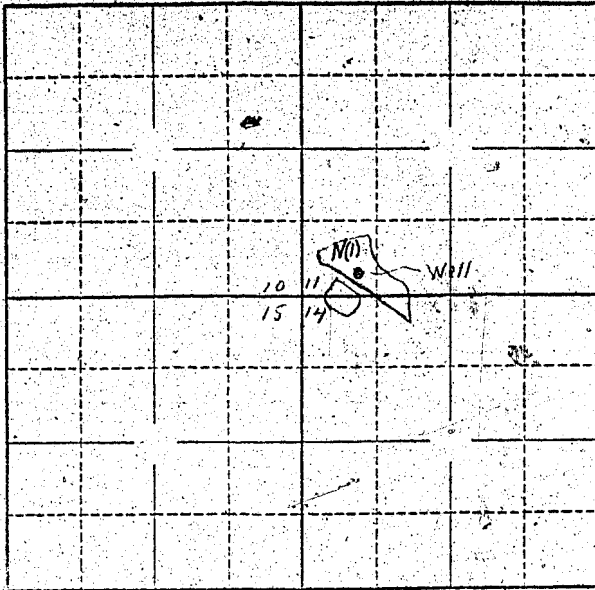

Locate well and acreage of irrigated land on plat.  
Scale: 2" = 1-Mile

STATE OF OREGON

County of \_\_\_\_\_ } ss.

I, \_\_\_\_\_, being first duly sworn, do hereby certify that I have read the foregoing Registration Statement and that all of the items therein contained are true to the best of my knowledge and belief.

\_\_\_\_\_  
(Signature of Registrant)

Subscribed and sworn to before me this \_\_\_\_\_ day of \_\_\_\_\_, 19\_\_\_\_\_

My commission expires \_\_\_\_\_  
(Notary Public)

(SEAL)

See Page GR-432 K for  
CERTIFICATE OF REGISTRATION

STATE OF OREGON

County of Marion } ss.

~~This is to certify that the foregoing Registration Statement was received in the office of the State Engineer on the \_\_\_\_\_ day of \_\_\_\_\_, 19\_\_\_\_\_, and has been duly recorded in said office in Book No. \_\_\_\_\_ Registration Statements on page \_\_\_\_\_.~~  
~~Construction shall be completed by \_\_\_\_\_ and the water completely applied to beneficial use by \_\_\_\_\_.~~

Witness my hand this \_\_\_\_\_ day of \_\_\_\_\_, 19\_\_\_\_\_

\_\_\_\_\_  
(State Engineer)

By \_\_\_\_\_  
(Deputy)









