

RECEIVED

APR 16 1957  
STATE ENGINEER  
SALEM, OREGON

REGISTRATION NO. GR-448  
CERTIFICATE NO. GR-3818

### Registration Statement

#### OF CLAIMANT OF RIGHT TO APPROPRIATE GROUND WATER

(Under Chapter 708, Oregon Laws 1955.)

TO THE STATE ENGINEER OF OREGON:

I, ERNA BATCHELLER - R. 1.2 Box 412 - Boring  
of Clackamas County of Oregon  
State of Oregon, do hereby make application for a certificate of registration as evidence of a right to appropriate ground water.

1. Source from which water is withdrawn is Pump Well  
(Flowing well, pump well, infiltration trench, or tunnel)
2. Location is: 1/2 mile north of Danvers  
(Approximate distance and direction from nearest city or town)

and is more particularly described as follows:

(a) N 36° W, 2477 feet from SE corner of Section 5  
(Give distance and bearing to corner of section or other legal subdivision)  
being within NE 1/4 NW 1/4 SE 1/4 of Sec. 5, Twp. 2 S, Rge. 3 E  
(Smallest legal subdivision) (N. or S.) (E. or W.)

or (b) within limits of recorded platted property, town or city:  
in Lot \_\_\_\_\_, Block \_\_\_\_\_ of \_\_\_\_\_  
(Name of plat or addition)

County of \_\_\_\_\_  
(If within city or town, give name)

3. Construction Work was begun on Sept. 1949; was completed on Oct. 1, 1949  
(Date) (Date)

and the ground water claimed was first used for the purposes set out below on May - 1950  
(Date)

since which time the water has been used continuously  
(Continuously or intermittently)  
from May 1950 to Oct. 1955  
(Date) (Date)

4. Quantity of water claimed and used is 150 gallons per minute; 6.9 acre feet per year.

5. Purpose or Purposes for which water is used Domestic and irrigation  
(Domestic, irrigation, municipal, manufacturing, industrial, etc.)

6. Description of Well: Depth 240 feet. Type Drilled  
(Dug or drilled)

diameter 8 inches. Elevation of ground at well site 580 feet, mean sea level.  
(As near as known)

Depth to water table 162 feet. static.

7. Capacity of Well: 190 g.p.m. with 40 feet drawdown.

115 g.p.m. with 30 feet drawdown.

Date of test Oct. 1, 1949

If Flowing Well: Measured discharge \_\_\_\_\_ g.p.m. on \_\_\_\_\_  
(Date)

Shut-in pressure at ground surface \_\_\_\_\_ lbs. per sq. in. on \_\_\_\_\_  
(Date)

Water is controlled by \_\_\_\_\_  
(Cap, valve, etc.)



If log of well is not available, give name and address of driller.

11. Infiltration Trench: Covered or open

Dimensions: Length \_\_\_\_\_ ft. Minimum depth \_\_\_\_\_ ft. Maximum depth \_\_\_\_\_ ft.  
 Bottom width \_\_\_\_\_ ft. Discharge \_\_\_\_\_ g.p.m. Date of test \_\_\_\_\_

12. Tunnel: Type of lining

Dimensions: \_\_\_\_\_  
(Length, course, and cross sectional size)

Position of water bearing stratum with reference to portal of tunnel

Log of tunnel: (Preceding table for log of well may be used, if desired. Give footage from portal and character of materials, as pertinent.)

13. Pumping Equipment:

(a) Pump 15 H.P. Cook Turbine Capacity 190 g.p.m.  
(Make, type and size)  
 (b) Motor 15 H.P. Vertical Hollow shaft  
(Type and horsepower)

14. Location of area irrigated or to be irrigated, or place of use if for purposes other than irrigation.

Township North or South	Range E. or W. of Williams Meridian	Section	Forty-acre Tract	Number Acres To Be Irrigated	Date of Reclamation
25	R.3E	5		69	IN USE NOW
25	3E	5	NW $\frac{1}{4}$ SE $\frac{1}{4}$	22.0	May 1950
25	3E	5	SW $\frac{1}{4}$ NE $\frac{1}{4}$	12.5	" "
25	3E	5	NE $\frac{1}{4}$ SE $\frac{1}{4}$	2.5	" "
25	3E	5	NE $\frac{1}{4}$ SW $\frac{1}{4}$	21.0	" "
25	3E	5	SE $\frac{1}{4}$ NW $\frac{1}{4}$	11.0	" "
				<u>69.0</u>	

15. If the ground water supply is supplemental to an existing water supply, identification of any application for a permit, permit, certificate or adjudicated right to appropriate water made or held by the registrant.

Township 2 S Range R3 E, W.M.  
North

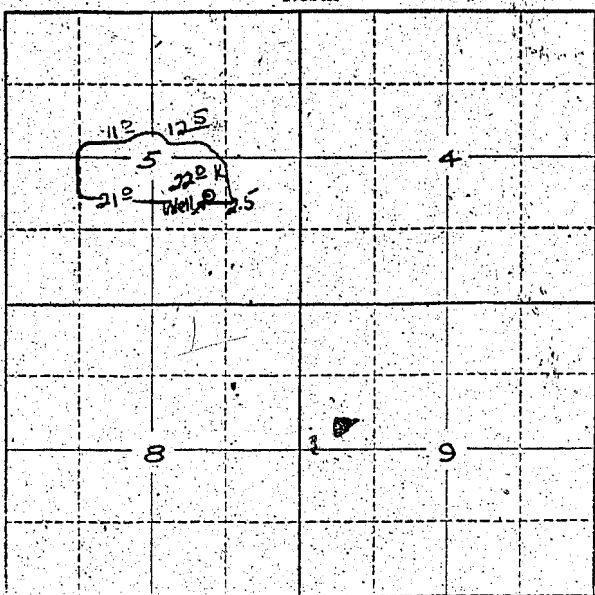

Locate well and acreage of irrigated land on plat.  
Scale: 2" = 1 Mile

STATE OF OREGON }  
County of CLACKAMAS } ss.

I, ERNA BACHMELER, being first duly sworn, do hereby certify that I have read the foregoing Registration Statement and that all of the items therein contained are true to the best of my knowledge and belief.

Erna Bachmeler  
(Signature of Registrant)

Subscribed and sworn to before me this 12 day of October, 1957

My commission expires 3-9-58

Clifford Beckett  
(Notary Public) for Oregon

(SEAL)

**CERTIFICATE OF REGISTRATION**

STATE OF OREGON }  
County of Marion } ss.

This is to certify that the foregoing Registration Statement was received in the office of the State Engineer on the 16th day of April, 1957, at 1:00 o'clock P.M. and has been duly recorded in said office in Book No. 16 of Registration Statements on page GR-3818

~~Construction shall be completed by xxxxxxxxxxxxxxxxxx and the water completely applied to beneficial use by xxxxxxxxxxxxxxxxxx.~~

Witness my hand this 4th day of December, 1957

Lewis A. Stearns  
(State Engineer)

# 20.85

By \_\_\_\_\_  
(Deputy)

GR-3818