

RECEIVED
APR 23 1937
STATE ENGINEER

REGISTRATION NO. GR-450
GR-435

Registration Statement CERTIFICATE NO. _____

OF CLAIMANT OF RIGHT TO APPROPRIATE GROUND WATER

(Under Chapter 708, Oregon Laws 1935.)

TO THE STATE ENGINEER OF OREGON:

I, Edith Hurd

of Harrisburg County of Linn

State of Oregon, do hereby make application for a certificate of registration as evidence of a right to appropriate ground water.

1. Source from which water is withdrawn is Pump Well #1
(Flowing well, pump well, infiltration trench, or tunnel)

2. Location is: 1/2 Mile South of Coburg, Oregon
(Approximate distance and direction from nearest city or town)

and is more particularly described as follows:

(a) 1537 ft. S. 15 degrees 28' E. from the NW Corner of the Jacob Spores DLC
(Give distance and bearing to corner of section or other legal subdivision)

being within S.E. 1/4 of S.W. 1/4 of Sec. 33, Twp. 16 S Rge. 3 W
(Smallest legal subdivision) (N. or S.) (E. or W.)

or (b) within limits of recorded platted property, town or city:

in Lot _____, Block _____ of _____
(Name of plat or addition)

County of _____
(If within city or town, give name)

3. Construction Work was begun on 1932; was completed on 1932
(Date) (Date)

and the ground water claimed was first used for the purposes set out below on 1932
(Date)

since which time the water has been used Intermittently
(Continuously or Intermittently)

from 1932 to 1957
(Date) (Date)

4. Quantity of water claimed and used is 250 gallons per minute; 5 acre feet per year.

5. Purpose or Purposes for which water is used Irrigation

(Domestic, irrigation, municipal, manufacturing, industrial, etc.)

6. Description of Well: Depth 20 feet. Type Driven
(Dug or drilled)

diameter 3.2" Pipes inches. Elevation of ground at well site 407 feet, mean sea level.
(As near as known)

Depth to water table 16 feet.

7. Capacity of Well: Unknown g.p.m. with _____ feet drawdown.

_____ g.p.m. with _____ feet drawdown.

Date of test _____

If Flowing Well: Measured discharge _____ g.p.m. on _____
(Date)

Shut-in pressure at ground surface _____ lbs. per sq. in. on _____
(Date)

Water is controlled by _____
(Cap, valve, etc.)

8. Casing: (Give diameter, commercial specifications and depth below ground surface of each casing size.)

..... inch diameter **Three Two inch Pipes** from to feet
..... inch diameter **Connected in Series** from to feet
..... inch diameter from to feet
..... inch diameter from to feet

Describe and show depth of shoe, plug, adapter, liner or other details:

9. Perforated Casings or Screens:

..... from to
(Number per foot and size of perforations, or describe screen)
..... from to
..... from to
..... from to

10. Log of Well: (Describe each stratum or formation clearly, indicate if water bearing, and give thickness and depth as indicated.)

MATERIAL	Thickness (Feet)	Depth to Bottom (Feet)
Unknown		

If log of well is not available, give name and address of driller.

11. Infiltration Trench: Covered or open

Dimensions: Length ft. Minimum depth ft. Maximum depth ft.

Bottom width ft. Discharge g.p.m. Date of test

12. Tunnel: Type of lining

Dimensions:
(Length, course, and cross sectional size)

Position of water bearing stratum with reference to portal of tunnel

Log of tunnel: (Preceding table for log of well may be used, if desired. Give footage from portal and character of materials, as pertinent.)

13. Pumping Equipment:

(a) Pump Fairbanks Morse 3" X 2 1/2" Capacity 300 g.p.m.
(Make, type and size)

(b) Motor 15 H. P. 3 Phase Electric
(Type and horsepower)

14. Location of area irrigated or to be irrigated, or place of use if for purposes other than irrigation.

Township North or South	Range E. or W. of Willamette Meridian	Section	Forty-acre Tract	Number Acres To Be Irrigated	Date of Reclamation
16 S	3 W	33	S.E. 1/4 of S.W. 1/4	6.2	1932
17 S	3 W	4	N.E. 1/4 of N.W. 1/4	4.8	"
				<u>11.0</u>	

15. If the ground water supply is supplemental to an existing water supply, identification of any application for a permit, permit, certificate or adjudicated right to appropriate water made or held by the registrant.

RECEIVED

APR 23 1957
STATE ENGINEER
SALEM, OREGON

REGISTRATION NO. CR-435
CERTIFICATE NO. GR-435

Registration Statement

OF CLAIMANT OF RIGHT TO APPROPRIATE GROUND WATER

(Under Chapter 703, Oregon Laws 1955.)

TO THE STATE ENGINEER OF OREGON:

I, Edith Eurd

of Harrisburg County of Linn

State of Oregon, do hereby make application for a certificate of registration as evidence of a right to appropriate ground water.

1. Source from which water is withdrawn is Pump Well #2
(Flowing well, pump well, infiltration trench, or tunnel)

2. Location is: 1/4 Mile South of the City of Coburg, Oregon
(Approximate distance and direction from nearest city or town)

and is more particularly described as follows:

(a) 1,142 ft. S 39 Degrees 04' E from the NW Corner of the Jacob Spores
(Give distance and bearing to corner of section or other legal subdivision)

being within SW1/SW4 of Sec. 33, Twp. 16 S, Rge. 1 W
(Smallest legal subdivision) (N. or S.) (E. or W.)

or (b) within limits of recorded platted property, town or city:

in Lot _____, Block _____ of _____
(Name of plat or addition)

County of _____
(If within city or town, give name)

3. Construction Work was begun on 1948; was completed on 1948
(Date) (Date)

and the ground water claimed was first used for the purposes set out below on 1948
(Date)

since which time the water has been used Constantly
(Continuously or intermittently)

from 1948 to 1957
(Date) (Date)

4. Quantity of water claimed and used is 400 gallons per minute; .5 acre feet per year.

5. Purpose or Purposes for which water is used Irrigation

(Domestic, irrigation, municipal, manufacturing, industrial, etc.)

6. Description of Well: Depth 20 feet. Type Dug
(Dug or drilled)

diameter 14 1/2 inches. Elevation of ground at well site 375 feet, mean sea level.
(As near as known)

Depth to water table 16 feet.

7. Capacity of Well: 400 g.p.m. with No feet drawdown.

_____ g.p.m. with _____ feet drawdown.

Date of test 1956

If Flowing Well: Measured discharge _____ g.p.m. on _____
(Date)

Shut-in pressure at ground surface _____ lbs. per sq. in. on _____
(Date)

Water is controlled by _____
(Cap, valve, etc.)

CR - 435 D

8. Casing: (Give diameter, commercial specifications and depth below ground surface of each casing size.)

inch diameter 4.4" Concrete Intire from to feet
inch diameter Depth of well from to feet
inch diameter from to feet
inch diameter from to feet

Describe and show depth of shoe, plug, adapter, liner or other details: 6" Suction Pipe
with Foot Valve

9. Perforated Casings or Screens:

..... from to
(Number per foot and size of perforations, or describe screen)
..... from to
..... from to
..... from to

10. Log of Well: (Describe each stratum or formation clearly, indicate if water bearing, and give thickness and depth as indicated.)

MATERIAL	Thickness (Feet)	Depth to Bottom (Feet)
<u>Chehallis Loam</u>	<u>12 ft.</u>	<u>12 ft</u>
<u>Water Bearing Gravel</u>	<u>8 ft.</u>	<u>Unknown</u>

If log of well is not available, give name and address of driller.

11. Infiltration Trench: Covered or open

Dimensions: Length ft. Minimum depth ft. Maximum depth ft.

Bottom width ft. Discharge g.p.m. Date of test

12. Tunnel: Type of lining

Dimensions:
(Length, course, and cross sectional size)

Position of water bearing stratum with reference to portal of tunnel

Log of tunnel: (Preceding table for log of well may be used, if desired. Give footage from portal and character of materials, as pertinent.)

13. Pumping Equipment:

(a) Pump Fairbanks Morse 4" X 3" Capacity 400 g.p.m.
(Make, type and size)

(b) Motor 20 H. P. 3 phase Electric
(Type and horsepower)

14. Location of area irrigated or to be irrigated, or place of use if for purposes other than irrigation.

Township North or South	Range E. or W. of Willamette Meridian	Section	Forty-acre Tract	Number Acres To Be Irrigated	Date of Reclamation
16S	R 3	33	S.W. $\frac{1}{4}$ of S.W. $\frac{1}{4}$	21	1948
16S	R 3	32	S.E. $\frac{1}{4}$ of S.E. $\frac{1}{4}$	1	
17 S	R 3	5	N.E. $\frac{1}{4}$ of N.E. $\frac{1}{4}$.4	
17 S	R 3	4	N.W. $\frac{1}{4}$ of N.W. $\frac{1}{4}$	9.6	
				32.0	

15. If the ground water supply is supplemental to an existing water supply, identification of any application for a permit, permit, certificate or adjudicated right to appropriate water made or held by the registrant.

Township 16S Range 3W, W.M.
17S North 3W

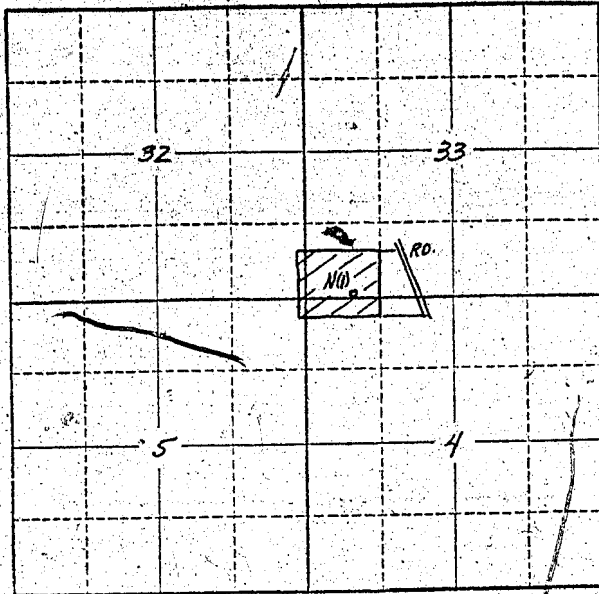

Locate well and acreage of irrigated land on plat.

Scale: 2" = 1 Mile

STATE OF OREGON

County of Linn } ss.

I, Edith Hurd, being first duly sworn, do hereby certify that I have read the foregoing Registration Statement and that all of the items therein contained are true to the best of my knowledge and belief.

Edith Hurd

(Signature of Registrant)

Subscribed and sworn to before me this 20th day of April, 1957.

My commission expires August 13, 1958

Wm. J. ...

(Notary Public) for Oregon

(SEAL)

CERTIFICATE OF REGISTRATION

STATE OF OREGON

County of Marion } ss.

This is to certify that the foregoing Registration Statement was received in the office of the State Engineer on the 22nd day of April, 1957, at 8:00 o'clock A. M. and has been duly recorded in said office in Book No. 3 of Registration Statements on page GR-135 G.

~~Construction shall be completed by -x-x-x-x-x-x-x-x-12-x-x- and the water completely applied to beneficial use by -x-x-x-x-x-x-x-x-18-x-x-~~

Witness my hand this 26th day of June, 1957.

Lewis A. Stanley

(State Engineer)

By _____ (Deputy)

GR - 435 G