

RECEIVED

APR 26 1957
STATE ENGINEER
SALVAGE OFFICE

REGISTRATION NO. GR-452
CERTIFICATE NO. GR 441

Registration Statement

OF CLAIMANT OF RIGHT TO APPROPRIATE GROUND WATER

(Under Chapter 708, Oregon Laws 1955.)

TO THE STATE ENGINEER OF OREGON:

I, O. L. HOGAN
725 Union Avenue, Grants Pass,
of S. H. & W. LUMBER COMPANY County of JOSEPHINE

State of OREGON, do hereby make application for a certificate of registration as evidence of a right to appropriate ground water.

1. Source from which water is withdrawn is DUMP WELL
(Flowing well, pump well, infiltration trench, or tunnel)
2. Location is: 1 mile S.W. of Grants Pass
(Approximate distance and direction from nearest city or town)

and is more particularly described as follows:

(a) 711' N and 418' E from S.W. corner Sec. 19, T. 36S R. 5 W.
s 30°20' W 830' to S.W. corner of Sec. 19. (Give distance and bearing to corner of section or other legal subdivision)
being within 1/4 S.W. 1/4 of Sec. 19, Twp. 36 S, Rge. 5 W
(Smallest legal subdivision) (N. or S.) (E. or W.)

or (b) within limits of recorded platted property, town or city:

in Lot _____, Block _____ of _____
(Name of plat or addition)
County of _____
(If within city or town, give name)

3. Construction Work was begun on 10/20/54; was completed on 10/27/54
(Date) (Date)

and the ground water claimed was first used for the purposes set out below on 10/27/54
(Date)

since which time the water has been used continuously
(Continuously or intermittently)

from 10/20/54 to 4/20/57
(Date) (Date)

4. Quantity of water claimed and used is 450 gallons per minute; _____ acre feet per year.

5. Purpose or Purposes for which water is used industrial purposes including mill and mill pond
(Domestic, irrigation, municipal, manufacturing, industrial, etc.)

6. Description of Well: Depth 141 feet. Type drilled
(Dug or drilled)

diameter 8 inches. Elevation of ground at well site 940 feet, mean sea level.
(As near as known)

Depth to water table 20 feet.

7. Capacity of Well: 330 g.p.m. with 40 feet drawdown.
450 g.p.m. with 100 feet drawdown.

Date of test 10/27/54

If Flowing Well: Measured discharge _____ g.p.m. on _____
(Date)

Shut-in pressure at ground surface _____ lbs. per sq. in. on _____
(Date)

Water is controlled by _____
(Cap. valve, etc.)

If log of well is not available, give name and address of driller. Paquin & Story, Grants Pass, Oregon

11. Infiltration Trench: Covered or open

Dimensions: Length ft. Minimum depth ft. Maximum depth ft.

Bottom width ft. Discharge g.p.m. Date of test

12. Tunnel: Type of lining

Dimensions:
(Length, course, and cross sectional size)

Position of water bearing stratum with reference to portal of tunnel

Log of tunnel: (Preceding table for log of well may be used, if desired. Give footage from portal and character of materials, as pertinent.)

13. Pumping Equipment:

(a) Pump 5" pump Layne & Bowler Capacity 450 g.p.m.
(Make, type and size)

(b) Motor 25 Hp
(Type and horsepower)

14. Location of area irrigated or to be irrigated, or place of use if for purposes other than irrigation.

Township North or South	Range E. or W. of Willamette Meridian	Section	Forty-acre Tract	Number Acres To Be Irrigated	Date of Reclamation
36 S	5 W	19	SW 1/4 SW 1/4	Industrial	10/27-1954
Description of Property:					
Beginning at a point 660 feet East of the Northwest corner of the Southwest quarter of the Southwest quarter of Section 19, Township 36 South, Range 5 West of the Willamette Meridian, Josephine County, Oregon, and run thence South 1320 feet to the South line of said Section 19; thence West 330 feet; thence North 1320 feet to a point due West of the point of beginning; thence East 330 feet to the point of beginning.					
Less and excepting that portion contained within the right of way of the California and Oregon Coast Railroad and excepting the right of way of the South canal of the Grants Pass Irrigation District.					
The West half of the Northwest quarter of the Southwest quarter of the Southwest quarter of Section 19, Township 36 South, Range 5 West of the Willamette Meridian, South of the California Oregon Coast Railroad right of way, all being in Josephine County Oregon.					

15. If the ground water supply is supplemental to an existing water supply, identification of any application for a permit, permit, certificate or adjudicated right to appropriate water made or held by the registrant.

Township 36 S Range 5 W, W.M.
North

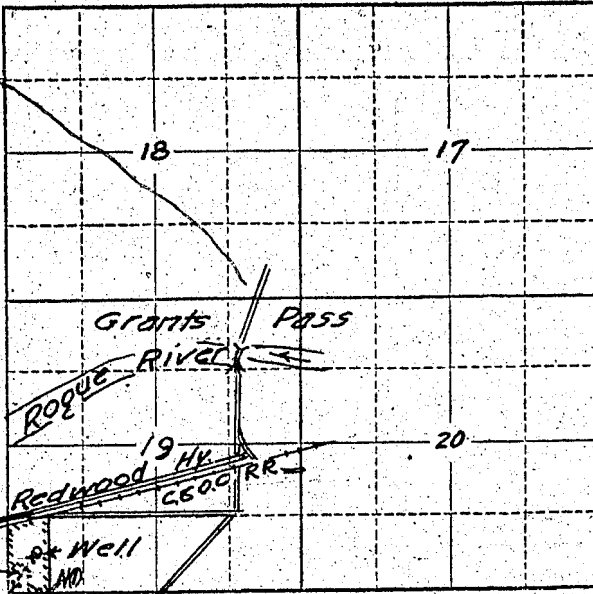

Locate well and acreage of irrigated land on plat.
Scale: 2" = 1 Mile

STATE OF OREGON

County of Josephine

} ss.

I, O. L. Hogan being first duly sworn, do hereby certify that I have read the foregoing Registration Statement and that all of the items therein contained are true to the best of my knowledge and belief.

S. H. W. Hunter Co. Inc.
O. L. Hogan
(Signature of Registrant)

Subscribed and sworn to before me this 22nd day of April, 1957.

My commission expires 4/17/59

Notary Public
(Notary Public) for Oregon

(SEAL)

CERTIFICATE OF REGISTRATION

STATE OF OREGON

County of Marion

} ss.

This is to certify that the foregoing Registration Statement was received in the office of the State Engineer on the 23rd day of April, 1957, at 8:00 o'clock A. M. and has been duly recorded in said office in Book No. 3 of Registration Statements on page GR-441 C.

~~Construction shall be completed by 1959 and the water completely applied to beneficial use by 1959~~

Witness my hand this 26th day of June, 1957

Lewis A. Stanley
(State Engineer)

20.00

By _____ (Deputy)

GR-441 C