

# Registration Statement

## OF CLAIMANT OF RIGHT TO APPROPRIATE GROUND WATER

TO THE STATE ENGINEER OF OREGON:

I, James E. Gott  
 of Route 1, Box 606, Port Orchard, Wash. County of Kitsap  
 State of Washington, do hereby make application for a certificate of registration as evidence of a right to appropriate ground water.

1. Source from which water is withdrawn is pump well  
(Flowing well, pump well, infiltration trench, or tunnel)  
 2. Location is: Two miles and direction North from Canby  
(Approximate distance and direction from nearest city or town)

and is more particularly described as follows:  
 (a) Beginning point 83.7 South, 1317.78 East, and 294.6 feet South from  
the N.W. corner of the S.W. 1/4 of the N.W. 1/4 of section 28  
(Give distance and bearing to corner of section or other legal subdivision)  
 being within Lot 4-1 of Sec. 35 Twp. 3S Rge. 1E of W. M.  
(Smallest legal subdivision) Part of S.E. 1/4 of N.E. 1/4 of section 28 (E. or W.)  
 or (b) within limits of recorded platted property, town or city:  
 in Lot \_\_\_\_\_, Block \_\_\_\_\_ of \_\_\_\_\_  
(Name of plat or addition)  
 \_\_\_\_\_ County of \_\_\_\_\_  
(If within city or town, give name)

3. Construction Work was begun on Feb. 22, 1950; was completed on March 11, 1950  
(Date) (Date)  
 and the ground water claimed was first used for the purposes set out below on May 20, 1950 (approx)  
(Date)  
 since which time the water has been used Intermittently  
(Continuously or Intermittently)  
 from May 20, 1950 to May 31, 1957  
(Date) (Date)

4. Quantity of water claimed and used is 50 gallons per minute; 18 acre feet per year.

5. Purpose or Purposes for which water is used IRRIGATION (mainly), also domestic  
(Domestic, irrigation, municipal, manufacturing, industrial, etc.)

6. Description of Well: Depth 144 feet. Type Drilled  
(Dug or drilled)  
 diameter 6" I.D. inches. Elevation of ground at well site 133 feet, mean sea level.  
(As near as known)  
 Depth to water table 46 feet.

7. Capacity of Well: 200 g.p.m. with 80 feet drawdown.  
300 g.p.m. with 120 feet drawdown.  
 Date of test March 13, 1950  
 If Flowing Well: Measured discharge \_\_\_\_\_ g.p.m. on \_\_\_\_\_  
(Date)  
 Shut-in pressure at ground surface \_\_\_\_\_ lbs. per sq. in. on \_\_\_\_\_  
(Date)  
 Water is controlled by \_\_\_\_\_  
(Cap, valve, etc.)

8. Casing: (Give diameter, commercial specifications and depth below ground surface of each casing size.)

6 inch diameter *steel casing* from 0 to 144 feet  
 inch diameter from to feet  
 inch diameter from to feet  
 inch diameter from to feet

Describe and show depth of shoe, plug, adapter, liner or other details:

9. Perforated Casings or Screens:

*Number per foot or size (Not KNOWN)* from 55' to 95'  
(Number per foot and size of perforations, or describe screen)  
 " from to 122'  
 " from 140' to 144'  
 " from to

10. Log of Well: (Describe each stratum or formation clearly, indicate if water bearing, and give thickness and depth as indicated.)

MATERIAL	Thickness (Feet)	Depth to Bottom (Feet)
Sand	22'	22'
Small Gravel	10'	32'
Boulders and Gravel	22'	54'
Loose gravel	13'	67'
Blue clay	20'	87'
Fine sand (Depth or Thickness Not Known)		87'
Blue clay	" "	122'
Fine sand	" "	122'
Blue clay	" "	140'
Sand and gravel	4'	144'

If log of well is not available, give name and address of driller. ....

11. Infiltration Trench: Covered or open .....

Dimensions: Length ..... ft. Minimum depth ..... ft. Maximum depth ..... ft.  
 Bottom width ..... ft. Discharge ..... g.p.m. Date of test .....

12. Tunnel: Type of lining .....

Dimensions: .....  
 (Length, course, and cross sectional size)  
 Position of water bearing stratum with reference to portal of tunnel .....

Log of tunnel: (Preceding table for log of well may be used, if desired. Give footage from portal and character of materials, as pertinent.)

13. Pumping Equipment:

(a) Pump Peerless Champion Turbine pump Capacity 50 (Approx) g.p.m.  
 (Make, type and size) B6  
 (b) Motor General Electric Single phase, 3 H.p. 3500 RPM  
 (Type and horsepower) .115/230 Volts 60 cyc

14. Location of area irrigated or to be irrigated, or place of use if for purposes other than irrigation.

Township North or South	Range E. or W. of Willamette Meridian	Section	Forty-acre Tract	Number Acres To Be Irrigated	Date of Reclamation
3S	1W	29	SE 1/4 of NE 1/4	8	5/20/50
"	"	28	SW 1/4 of NW 1/4	5	"
				13	

15. If the ground water supply is supplemental to an existing water supply, identification of any application for a permit, permit, certificate or adjudicated right to appropriate water made or held by the registrant.

Township 35 Range 1E W.M.  
North

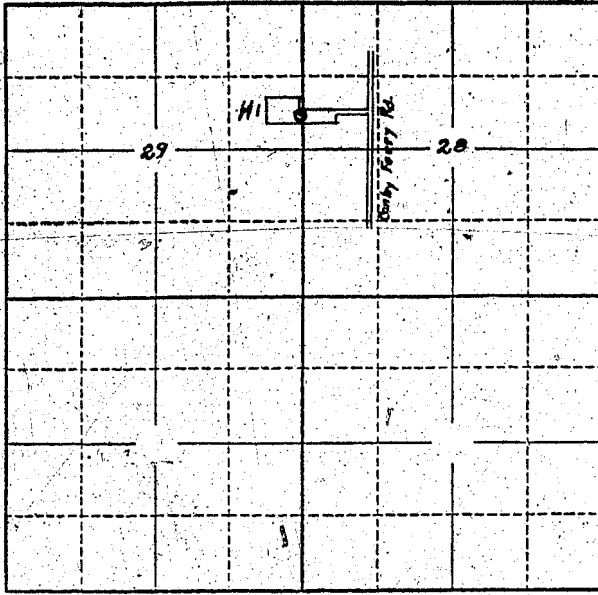

Locate well and acreage of irrigated land on plat.  
Scale: 2" = 1 Mile

STATE OF OREGON

County of \_\_\_\_\_ } ss.

I, James E. Gott, being first duly sworn, do hereby certify that I have read the foregoing Registration Statement and that all of the items therein contained are true to the best of my knowledge and belief.

James E. Gott  
(Signature of Registrant)

Subscribed and sworn to before me this 31st day of May, 1957.

My commission expires Sept. 8, 1960 }  
Chas. J. ...  
(Notary Public)

(SEAL)

**CERTIFICATE OF REGISTRATION**

STATE OF OREGON }  
County of Marion } ss.

This is to certify that the foregoing Registration Statement was received in the office of the State Engineer on the 31st day of May, 1957, at 8:00 o'clock A. M. and has been duly recorded in said office in Book No. 3 of Registration Statements on page GR-484 C.

Witness my hand this 24th day of July, 1957.

Lewis A. Stanley  
(State Engineer)

By \_\_\_\_\_  
(Deputy)

GR - 484 C

#15.00