

RECEIVED JUN 7 1957 STATE ENGINEER SALEM OREGON

Registration Statement

OF CLAIMANT OF RIGHT TO APPROPRIATE GROUND WATER

TO THE STATE ENGINEER OF OREGON:

I, WILLIAM BRYAN TERPENING
of EUGENE, 2300 River Road County of LANE

State of OREGON, do hereby make application for a certificate of registration as evidence of a right to appropriate ground water.

1. Source from which water is withdrawn is PUMP WELL
(Flowing well, pump well, infiltration trench, or tunnel)

2. Location is: 4 mi NORTH OF EUGENE
(Approximate distance and direction from nearest city or town)

and is more particularly described as follows: 600 ft west and 570 ft South from NE corner of section 14 beginning at center of Hwy. Road 32, 7 1/2 chains S. 1010 East from a point on center of Road 4.02 2 chains East of the Southeast corner of A. Beck Donation
(a) (Give distance and bearing to corner of section or other legal subdivision)

being within NE 1/4 of NE 1/4 of Sec. 14, Twp. 17, Rge. 4 W. 1/4 W. 1/4
(Smallest legal subdivision) (N. or S.) (E. or W.)

or (b) within limits of recorded platted property, town or city:

in Lot _____, Block _____ of _____
(Name of plat or addition)

County of _____
(If within city or town, give name)

3. Construction Work was begun on APRIL 1, 1945; was completed on APRIL 30, 1945
(Date) (Date)

and the ground water claimed was first used for the purposes set out below on MAY 1, 1945
(Date)

since which time the water has been used INTERMITTENTLY
(Continuously or intermittently)

from MAY 1, 1945 to MAY 1, 1957
(Date) (Date)

4. Quantity of water claimed and used is _____ gallons per minute; _____ acre feet per year.

5. Purpose or Purposes for which water is used IRRIGATION
(Domestic, irrigation, municipal, manufacturing, industrial, etc.)

6. Description of Well: Depth 20 feet. Type DRIVEN
(Dug or drilled)

diameter 2 inches. Elevation of ground at well site 385 feet, mean sea level.
(As near as known)

Depth to water table 8 feet.

7. Capacity of Well: 120 g.p.m. with 2 ft feet drawdown.

_____ g.p.m. with _____ feet drawdown.

Date of test APRIL 30, 1957

If Flowing Well: Measured discharge _____ g.p.m. on _____
(Date)

Shut-in pressure at ground surface _____ lbs. per sq. in. on _____
(Date)

Water is controlled by _____
(Cap, valve, etc.)

8. Casing: (Give diameter, commercial specifications and depth below ground surface of each casing size.)

driven
 inch diameter from to feet
 inch diameter from to feet
 inch diameter from to feet
 inch diameter from to feet

Describe and show depth of shoe, plug, adapter, liner or other details:

9. Perforated Casings or Screens:

..... from to
 (Number per foot and size of perforations, or describe screen)
 from to
 from to
 from to

10. Log of Well: (Describe each stratum or formation clearly, indicate if water bearing, and give thickness and depth as indicated.)

MATERIAL	Thickness (Feet)	Depth to Bottom (Feet)
<i>Loam</i>	<i>8</i>	<i>8</i>
<i>Coarse gravel</i>	<i>12</i>	<i>20</i>

Beginning at a point in the center of the County Road known as the River Road 32.73 chains South 17 degrees 10' East from a point in the center of said road, 4.02 chains East from the Southeast corner of the A. Peek and wife Donation Land Claim No. 51 in township Seventeen South Range Four West of Willamette Meridian and running thence South 86 degrees 30' West 25.00 chains, thence North 4.10 chains, thence North 86 degrees 30' East 23.73 chains to the center of said road and thence South 17 degrees 10' East along said center 4.30 chains to the place of beginning, containing 10.00 acres more or less of land, all being part of the Joseph Davis and wife Donation Land Claim No. 48, Notification No. 2081 in Lane County, State of Oregon.

Legal description

Township 17S Range 4W WEST 1/4 W. 11.4 M. E T T E R M E R I D I A N
W.M.

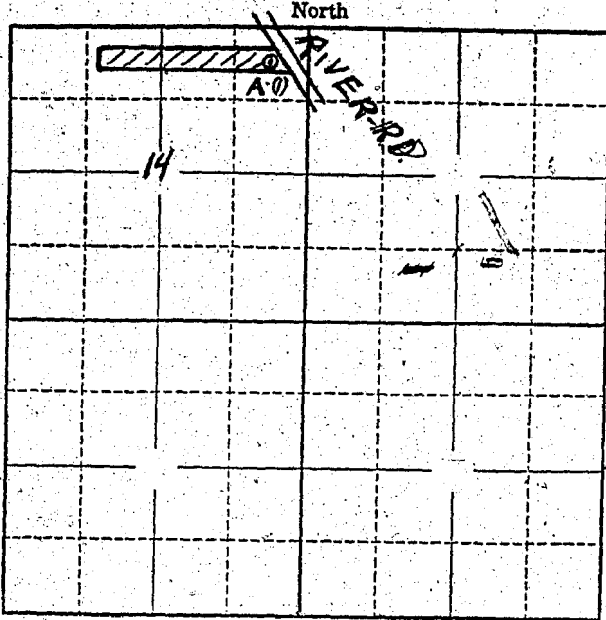

Place in Section 1
Well at slot 150 FT
from River Road &
65' from So. line

Locate well and acreage of irrigated land on plat.

Scale: $\frac{1}{4}$ " = 1 Mile
4" = 1 mile

STATE OF OREGON

County of Linn } ss.

I, William D. Terpening, being first duly sworn, do hereby certify that I have read the foregoing Registration Statement and that all of the items therein contained are true to the best of my knowledge and belief.

William D. Terpening
(Signature of Registrant)

Subscribed and sworn to before me this 31st day of May, 1957

My commission expires April 11, 1960
John Steubath
(Notary Public)

(SEAL)

CERTIFICATE OF REGISTRATION

STATE OF OREGON

County of Marion } ss.

This is to certify that the foregoing Registration Statement was received in the office of the State Engineer on the 7th day of June, 1957, at 8:00 o'clock A. M. and has been duly recorded in said office in Book No. 3 of Registration Statements on page GR-487 C.

Witness my hand this 21st day of July, 1957.

Levio A. Stanley
(State Engineer)

\$15.00

By _____ (Deputy)

GR - 487 C