

RECEIVED
JUN 17 1957
STATE ENGINEER
SALEM, OREGON

Registration No. GR 522

Certificate No. GR 500

Registration Statement

OF CLAIMANT OF RIGHT TO APPROPRIATE GROUND WATER

TO THE STATE ENGINEER OF OREGON:

I, Elijah Rayes

of Rt. 2, Box 198, Albany County of Linn
(Mailing address)

State of Oregon, do hereby make application for a certificate of registration as evidence of a right to appropriate ground water.

1. Source from which water is withdrawn is pump well
(Flowing well, pump well, infiltration trench, or tunnel)

2. Location is: 9 miles east of Albany, Oregon
(Approximate distance and direction from nearest city or town)

and is more particularly described as follows:

(a) N. 53° 30' 45 chains from the SW corner of S. 29, T. 10 S, R. 2 W.
(Give distance and bearing to corner of section or other legal subdivision)

being within NE 1/4 of SW 1/4 of Sec. 29, Twp. 10 S, Rge. 2W
(Smallest legal subdivision) (N. or S.) (E. or W.)

or (b) within limits of recorded platted property, town or city:

in Lot _____, Block _____ of _____
(Name of plat or addition)

County of Linn
(If within city or town, give name)

3. Construction Work was begun on July, 1937; was completed on July, 1937
(Date) (Date)

and the ground water claimed was first used for the purposes set out below on August, 1937
(Date)

since which time the water has been used continuously
(Continuously or Intermittently)

from August, 1937 to present time
(Date) (Date)

4. Quantity of water claimed and used is 170 gallons per minute; 54.75 acre feet per year.

5. Purpose or Purposes for which water is used Irrigation

(Domestic, irrigation, municipal, manufacturing, industrial, etc.)

6. Description of Well: Depth 13 feet. Type Dug
(Dug or drilled)

diameter 4 inches. Elevation of ground at well site 245 feet, mean sea level.
(As near as known)

Depth to water table 3 feet.

7. Capacity of Well: 300 g.p.m. with 12 feet drawdown.

_____ g.p.m. with _____ feet drawdown.

Date of test Not tested - estimated

If Flowing Well: Measured discharge _____ g.p.m. on _____
(Date)

Shut-in pressure at ground surface _____ lbs. per sq. in. on _____
(Date)

Water is controlled by _____
(Cap, valve, etc.)

8. Casing: (Give diameter, commercial specifications and depth below ground surface of each casing size.)

4 inch diameter steel from 0 to 13 feet
 inch diameter from to feet
 inch diameter from to feet
 inch diameter from to feet

Describe and show depth of shoe, plug, adapter, liner or other details:

9. Perforated Casings or Screens:

slot perforations from 2 to 13
 (Number per foot and size of perforations, or describe screen)
 from to
 from to
 from to

10. Log of Well: (Describe each stratum or formation clearly, indicate if water bearing, and give thickness and depth as indicated.)

MATERIAL	Thickness (Feet)	Depth to Bottom (Feet)
Not available		

If log of well is not available, give name and address of driller, Elijah Hayes, Rt. 2, Box 498,
Albany, Oregon

11. Infiltration Trench: Covered or open _____
 Dimensions: Length _____ ft. Minimum depth _____ ft. Maximum depth _____ ft.
 Bottom width _____ ft. Discharge _____ g.p.m. Date of test _____

12. Tunnel: Type of lining _____
 Dimensions: _____
(Length, course, and cross sectional size)
 Position of water bearing stratum with reference to portal of tunnel _____

Log of tunnel: (Preceding table for log of well may be used, if desired. Give footage from portal and character of materials, as pertinent.)

13. Pumping Equipment:
 (a) Pump Westinghouse 2" centrifugal Capacity 320 g.p.m.
(Make, type and size)
 (b) Motor 15 H.P.
(Type and horsepower)

14. Location of area irrigated or to be irrigated, or place of use if for purposes other than irrigation.

Township North or South	Range E. or W. of Willamette Meridian	Section	Forty-acre Tract	Number Acres To Be Irrigated	Date of Reclamation
10 S	2 W	29	SE $\frac{1}{4}$ of NW $\frac{1}{4}$	0.2	August 1937
10 S	2 W	29	NW $\frac{1}{4}$ of SE $\frac{1}{4}$	3.2	" "
10 S	2 W	29	SW $\frac{1}{4}$ of SE $\frac{1}{4}$	0.2	" "
10 S	2 W	29	NE $\frac{1}{4}$ of SW $\frac{1}{4}$	17.2	" "
10 S	2 W	29	SE $\frac{1}{4}$ of SW $\frac{1}{4}$	1.1	
				21.9	

205-620

Beginning at an iron rod on the South line of and East 36.44 chains distant from the Southwest corner of the North half of the D.L.C. of Lewis Cox, et ux, same being Not. No. 1626 and Claim 44, in T. 10 S., R. 2 W. of the Will. Mer. in Linn County, Oregon, thence South 97 links to the North line of the right of way of the Southern Pacific Railroad Company; thence N. 65 3/4° E. along the North line of said right of way 11.06 chains to a stone marked "CS"; thence North 8.90 chains; thence East 90 links; thence North to the North line of said Claim 44, thence westerly along the North line of said Claim to a point due North of the place of beginning; thence South of the place of beginning, containing 46 acres, more or less, all lying in Linn County, Oregon.

15. If the ground water supply is supplemental to an existing water supply, identification of any application for a permit, permit, certificate or adjudicated right to appropriate water made or held by the registrant.

Township 10 S Range 2 W, W.M.
North

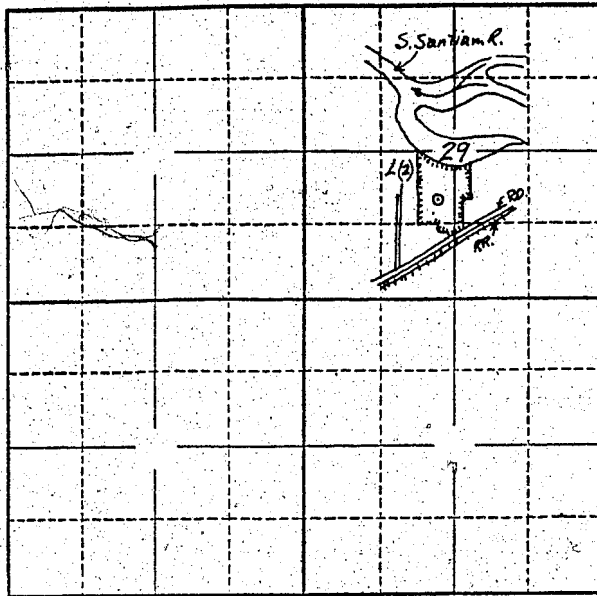

Locate well and acreage of irrigated land on plat.
Scale: 2" = 1 Mile

STATE OF OREGON }
County of Linn } ss.

I, Elijah Hayes, being first duly sworn, do hereby certify that I have read the foregoing Registration Statement and that all of the items therein contained are true to the best of my knowledge and belief.

Elijah Hayes
(Signature of Registrant)

Subscribed and sworn to before me this 13th day of June, 1957

My commission expires _____ R. M. RUSSELL, COUNTY CLERK

(Notary Public)

(SEAL)

By

Gladis J. Russell
Deputy

CERTIFICATE OF REGISTRATION

STATE OF OREGON }
County of Marion } ss.

This is to certify that the foregoing Registration Statement was received in the office of the State Engineer on the 18th day of June, 1957 at 8:00 o'clock A. M. and has been duly recorded in said office in Book No. 3 of Registration Statements on page GR-500 C

Witness my hand this 24th day of July, 1957

Leuro J. Stanley
(State Engineer)

\$15.00

By _____ (Deputy)