

RECEIVED  
JUN 18 1957

STATE ENGINEER  
SALEM, OREGON

Registration No. GR. 526

Certificate No. GR. 503

# Registration Statement

## OF CLAIMANT OF RIGHT TO APPROPRIATE GROUND WATER

TO THE STATE ENGINEER OF OREGON:

I, Leo J. and Raita Lu Metcalf  
of Rt. 3, Box 85 A, Scio County of Linn  
(Mailing address)  
State of Oregon, do hereby make application for a certificate of registration as evidence of a right to appropriate ground water.

1. Source from which water is withdrawn is Pump Well No. 2  
(Flowing well, pump well, infiltration trench, or tunnel)

2. Location is: 3 miles NW of Crabtree, Oregon  
(Approximate distance and direction from nearest city or town)

and is more particularly described as follows:

(a) S 44° 15' W. 19.75 chains from NE cor. of SE 1/4 of S. 28, T. 10 S., R. 2 W.  
(Give distance and bearing to corner of section or other legal subdivision)

being within NE 1/4 of SE 1/4 of Sec. 28, Twp. 10 S., Rge. 2 W.  
(Smallest legal subdivision) (N. or S.) (E. or W.)

or (b) within limits of recorded platted property, town or city:

in Lot \_\_\_\_\_, Block \_\_\_\_\_ of \_\_\_\_\_  
(Name of plat or addition)  
County of Linn  
(If within city or town, give name)

3. Construction Work was begun on April 10, 1949; was completed on April 17, 1949  
(Date) (Date)

and the ground water claimed was first used for the purposes set out below on May 15, 1949  
(Date)

since which time the water has been used continuously  
(Continuously or intermittently)

from May 15, 1949 to present time  
(Date) (Date)

4. Quantity of water claimed and used is 90 gallons per minute; 41.5 acre feet per year.

5. Purpose or Purposes for which water is used Irrigation

(Domestic, irrigation, municipal, manufacturing, industrial, etc.)

6. Description of Well: Depth 27 feet. Type Drilled  
(Dug or drilled)

diameter 10 inches. Elevation of ground at well site 225 feet, mean sea level.  
(As near as known)

Depth to water table 12 feet.

7. Capacity of Well: 90 g.p.m. with 12 feet drawdown.

\_\_\_\_\_ g.p.m. with \_\_\_\_\_ feet drawdown.

Date of test Not tested - estimated

If Flowing Well: Measured discharge \_\_\_\_\_ g.p.m. on \_\_\_\_\_  
(Date)

Shut-in pressure at ground surface \_\_\_\_\_ lbs. per sq. in. on \_\_\_\_\_  
(Date)

Water is controlled by \_\_\_\_\_  
(Cap, valve, etc.)

8. Casing: (Give diameter, commercial specifications and depth below ground surface of each casing size.)

10 inch diameter ..... from 0 to 27 feet  
..... inch diameter ..... from ..... to ..... feet  
..... inch diameter ..... from ..... to ..... feet  
..... inch diameter ..... from ..... to ..... feet

Describe and show depth of shoe, plug, adapter, liner or other details: .....

9. Perforated Casings or Screens:

slot perforations ..... from 12 to 27  
(Number per foot and size of perforations, or describe screen)  
..... from ..... to .....  
..... from ..... to .....  
..... from ..... to .....

10. Log of Well: (Describe each stratum or formation clearly, indicate if water bearing, and give thickness and depth as indicated.)

MATERIAL	Thickness (Feet)	Depth to Bottom (Feet)
Not available		

If log of well is not available, give name and address of driller. Nicklas Klaus, Rt. 1, Albany, Oregon

11. Infiltration Trench: Covered or open .....

Dimensions: Length ..... ft. Minimum depth ..... ft. Maximum depth ..... ft.

Bottom width ..... ft. Discharge ..... g.p.m. Date of test .....

12. Tunnel: Type of lining .....

Dimensions: .....  
(Length, course, and cross sectional size)

Position of water bearing stratum with reference to portal of tunnel .....

Log of tunnel: (Preceding table for log of well may be used, if desired: Give footage from portal and character of materials, as pertinent.)

13. Pumping Equipment:

(a) Pump 2" Pacific Centrifugal ..... Capacity 180 ..... g.p.m.  
(Make, type and size)

(b) Motor 10 H. P. electric .....  
(Type and horsepower)

14. Location of area irrigated or to be irrigated, or place of use if for purposes other than irrigation.

Township North or South	Range E. or W. of Willamette Meridian	Section	Forty-acre Tract	Number Acres To Be Irrigated	Date of Reclamation
10 S	2 W	28	NE $\frac{1}{4}$ of SE $\frac{1}{4}$	11.2	May 15, 1949
10 S	2 W	28	SE $\frac{1}{4}$ of SE $\frac{1}{4}$	5.4	" "
				16.6	

222-828

Beginning 20 chains East of the Northwest corner of the Southeast quarter of the Section 28, T. 10 S., R. 2 W. of the Will. Mer. in Linn County, Oregon, thence East 14.545 chains; thence South 27.50 chains, thence West 14.545 chains; thence north 27.50 chains to the place of beginning, it being the intention of the grantors herein right of way, release, quitclaim and convey all right, title and interest of whatsoever nature, the parts dated July 31, 1947 and recorded August 5, 1947 in Deed Records 194, page 541.

15. If the ground water supply is supplemental to an existing water supply, identification of any application for a permit, permit, certificate or adjudicated right to appropriate water made or held by the registrant.

Township 10 S Range 2 W, W.M.  
North

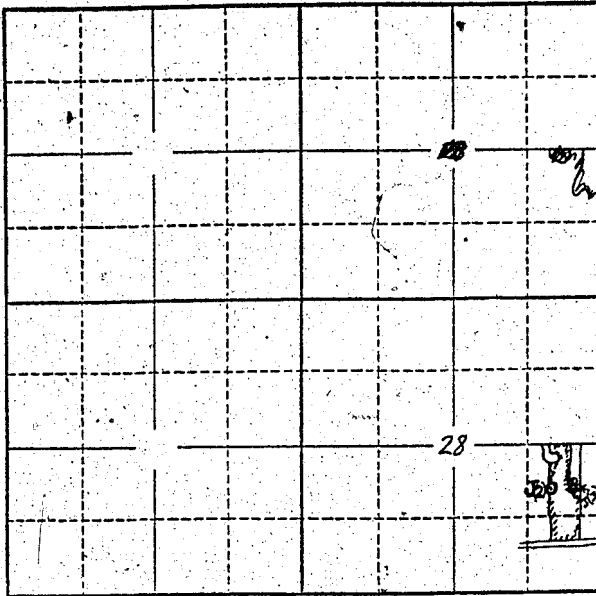

Locate well and acreage of irrigated land on plat.

Scale: 2" = 1 Mile

STATE OF OREGON

County of Linn

} ss.

I, Leo J. and Retta Lu Metcalf, being first duly sworn, do hereby certify that I have read the foregoing Registration Statement and that all of the items therein contained are true to the best of my knowledge and belief.

Leo J. Metcalf  
Retta Lu Metcalf  
(Signature of Registrant)

Subscribed and sworn to before me this 14th day of June, 1957.

My commission expires 3/19/60.

SE Drushella  
(Notary Public)

(SEAL)

### CERTIFICATE OF REGISTRATION

STATE OF OREGON

County of Marion

} ss.

This is to certify that the foregoing Registration Statement was received in the office of the State Engineer on the 18th day of June, 1957 at 8:00 o'clock A. M. and has been duly recorded in said office in Book No. 3 of Registration Statements on page GR-503 C.

Witness my hand this 24th day of July, 1957.

Lewis A. Stanley  
(State Engineer)

By \_\_\_\_\_

(Deputy)

GR - 503 C