

RECEIVED
DEC 6 1955
STATE ENGINEER
SALEM, OREGON

REGISTRATION NO. GR-55
CERTIFICATE NO. GR-47

Registration Statement

OF CLAIMANT OF RIGHT TO APPROPRIATE GROUND WATER

(Under Chapter 708, Oregon Laws 1955.)

TO THE STATE ENGINEER OF OREGON:

I, Glen M. Looney
of RB 9238 County of Marion

State of Oregon, do hereby make application for a certificate of registration as evidence of a right to appropriate ground water.

1. Source from which water is withdrawn is Pump Well
(Flowing well, pump well, infiltration trench, or tunnel)

2. Location is: 8 1/2 mi. NE of Salem Oregon
(Approximate distance and direction from nearest city or town)

and is more particularly described as follows:

(a) 10.2 chs E. 5 Chms S from Center Sec. 28
(Give distance and bearing to corner of section or other legal subdivision)

being within North West 1/4 SE 1/4 of Sec. 28, Twp. 6S, Rge. 2W
(Smallest legal subdivision) (N, or S.) (E, or W.)

or (b) within limits of recorded platted property, town or city:

in Lot _____ Block _____ of _____
(Name of plat or addition)
County of _____
(If within city or town, give name)

3. Construction Work was begun on 5-20-39; was completed on 5-23-39
(Date) (Date)

and the ground water claimed was first used for the purposes set out below on July 3-1939
(Date)

since which time the water has been used continuously during irrigation
(Continuously or intermittently) (Date)

from July 3 1939 to Sept-1955
(Date) (Date)

4. Quantity of water claimed and used is 240 gallons per minute; _____ acre feet per year.

5. Purpose or Purposes for which water is used Irrigation
(Domestic, irrigation, municipal, manufacturing, industrial, etc.)

6. Description of Well: Depth 116.8 feet. Type Drilled
(Dug or drilled)

diameter 8 inches. Elevation of ground at well site 186 feet, mean sea level.
(As near as known)

Depth to water table 40 feet.

7. Capacity of Well: 350 g.p.m. with 108 feet drawdown.

240 g.p.m. with 96 feet drawdown.

Date of test May 24 1957 1939

If Flowing Well: Measured discharge _____ g.p.m. on _____
(Date)

Shut-in pressure at ground surface _____ lbs. per sq. in. on _____
(Date)

Water is controlled by _____
(Cap, valve, etc.)

8. Casing: (Give diameter, commercial specifications and depth below ground surface of each casing size.)

8 inch diameter from 0 to 116.8 feet
 inch diameter from to feet
 inch diameter from to feet
 inch diameter from to feet

Describe and show depth of shoe, plug, adapter, liner or other details:

Well Casing 8" I.D. Threaded - 32' 8" Steel
 Driving Shoe, Screw type

9. Perforated Casings or Screens:

Ripper type Perforator { 18 Perforations from 60' to 63'
 (Number per foot and size of perforations, or describe screen)
 6 Rows Per Ft. 3" x 8" { 12 Perforations from 84' to 86'
 from to
 from to

10. Log of Well: (Describe each stratum or formation clearly, indicate if water bearing, and give thickness and depth as indicated.)

MATERIAL	Thickness (Feet)	Depth to Bottom (Feet)
Top Soil		
Yellow Clay		
Mucky Silt Blue		
Red Sand	May	
Water Gravel & Sand		
Water Gravel		
Cemented Gravel		
Water Gravel		
Cemented Gravel		
Water Gravel		

If log of well is not available, give name and address of driller:

J.A. Sneed & Sons
2505 Bank St. Salem Oregon

11. Infiltration Trench: Covered or open

Dimensions: Length ft. Minimum depth ft. Maximum depth ft.

Bottom width ft. Discharge g.p.m. Date of test

12. Tunnel: Type of lining

Dimensions:
(Length, course, and cross sectional size)

Position of water bearing stratum with reference to portal of tunnel

Log of tunnel: (Preceding table for log of well may be used, if desired. Give footage from portal and character of materials, as pertinent.)

13. Pumping Equipment:

(a) Pump Berkley Capacity 240 g.p.m.
(Make, type and size)

(b) Motor 15 H. 3 Phase General Electric
(Type and horsepower)

14. Location of area irrigated or to be irrigated, or place of use if for purposes other than irrigation.

Township North or South	Range E. or W. of Willamette Meridian	Section	Forty-acre Tract	Number Acres To Be Irrigated	Date of Reclamation
T6S	2W	28	NW $\frac{1}{4}$ & SE $\frac{1}{4}$	40	July 1939
"	"	"	SW $\frac{1}{4}$ & NE $\frac{1}{4}$	20	" 1939
"	"	"	SE $\frac{1}{4}$ & NW $\frac{1}{4}$	13.8	" 1950

15. If the ground water supply is supplemental to an existing water supply, identification of any application for a permit, permit, certificate or adjudicated right to appropriate water made or held by the registrant:

Township 65 Range 2W, W.M.
North

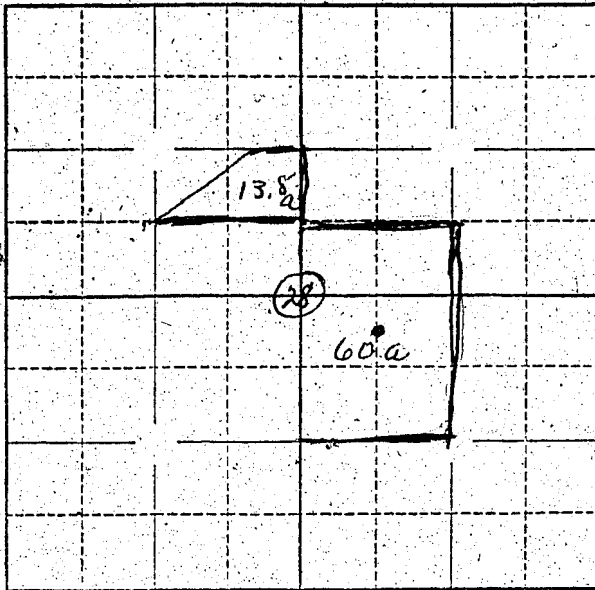

Locate well and acreage of irrigated land on plat.

Scale: 3" = 1 Mile
4"

STATE OF OREGON

County of Marion } ss.

I, Glen M. Looney, being first duly sworn, do hereby certify that I have read the foregoing Registration Statement and that all of the items therein contained are true to the best of my knowledge and belief.

Glen M. Looney
(Signature of Registrant)

Subscribed and sworn to before me this 6th day of December, 1955.

My commission expires 7/27/58
Jeanie Baxter
(Notary Public)

(SEAL)

CERTIFICATE OF REGISTRATION

STATE OF OREGON } ss.
County of Marion

This is to certify that the foregoing Registration Statement was received in the office of the State Engineer on the 6th day of December, 1955, at 8:00 o'clock P. M. and has been duly recorded in said office in Book No. 1 of Registration Statements on page 47.

Construction shall be completed by 15 1955, and the water is completely applied to beneficial use by 10 1955.

Witness my hand this 24th day of February, 1956.

Lewis A. Glavin
(State Engineer)

By _____
(Deputy)