

STATE ENGINEER
SKILLMAN COUNTY

Registration No. GR - 557
Certificate No. GR 570

Registration Statement

OF CLAIMANT OF RIGHT TO APPROPRIATE GROUND WATER

TO THE STATE ENGINEER OF OREGON:

I, C. M. Hubbard & Son
of Junction City County of Benton
State of Oregon, do hereby make application for a certificate of registration as evidence of a right to appropriate ground water.

1. Source from which water is withdrawn is Well #1
(Flowing well, pump well, infiltration trench, or tunnel)
2. Location is: Two miles East of Monroe
(Approximate distance and direction from nearest city or town)

and is more particularly described as follows: From the S.E. corner of section 27 - north
(a) 1090 ft. from well 820 ft. monument, established well site.
(Give distance and bearing to corner of section or other legal subdivision)

being within S.E. 1/4 of S.E. 1/4 of Sec. 27 Twp. 14 S Rge. 5 W
(Smallest legal subdivision) (N. or S.) (E. or W.)

or (b) within limits of recorded platted property, town or city:
in Lot U, Block U of U
(Name of plat or addition)
County of Benton
(If within city or town, give name)

3. Construction Work was begun on September 27-52 was completed on September 29-52
(Date) (Date)

and the ground water claimed was first used for the purposes set out below on above fall
since which time the water has been used Intermittently, according to type of crop,
and soil moisture, early spg. & summer
(Continuously or intermittently)
from late May to early September
(Date) (Date)

4. Quantity of water claimed and used is 400-500 gallons per minute; _____ acre feet per year.

5. Purpose or Purposes for which water is used Irrigation
(Domestic, irrigation, municipal, manufacturing, industrial, etc.)

6. Description of Well: Depth 22 feet. Type Driven
(Dug or drilled)
diameter four inches. Elevation of ground at well site 285 ft. above feet, mean sea level.
(As near as known)
Depth to water table 10-11 (estimated) feet.

7. Capacity of Well: 400-500 g.p.m. with ? feet drawdown.
_____ g.p.m. with _____ feet drawdown.

Date of test May 26th, 1957

If Flowing Well: Measured discharge _____ g.p.m. on _____ (Date)

Shut-in pressure at ground surface _____ lbs. per sq. in. on _____ (Date)

Water is controlled by _____
(Cap, valve, etc.)

8. Casing: (Give diameter, commercial specifications and depth below ground surface of each casing size.)

4 inch diameter *total length* from 0 to 22 feet
 inch diameter from to feet
 inch diameter from to feet
 inch diameter from to feet

Describe and show depth of shoe, plug, adapter, liner or other details:

9. Perforated Casings or Screens:

unknown from to
 (Number per-foot and size of perforations, or describe screen)
 from to
 from to
 from to

10. Log of Well: (Describe each stratum or formation clearly, indicate if water bearing, and give thickness and depth as indicated.)

MATERIAL	Thickness (Feet)	Depth to Bottom (Feet)

If log of well is not available, give name and address of driller. H. O. Paeschke, Jct. City, Ore.

11. Infiltration Trench: Covered or open covered open
 Dimensions: Length ft. Minimum depth ft. Maximum depth ft.
 Bottom width ft. Discharge g.p.m. Date of test

12. Tunnel: Type of lining
 Dimensions:
 (Length, course, and cross sectional size)
 Position of water bearing stratum with reference to portal of tunnel

Log of tunnel: (Preceding table for log of well may be used, if desired. Give footage from portal and character of materials, as pertinent.)

13. Pumping Equipment:

(a) Pump Fairbanks-Morse 20 horse power Capacity 400-500 g.p.m.
 (Make, type and size)
 (b) Motor Electric
 (Type and horsepower)

14. Location of area irrigated or to be irrigated, or place of use if for purposes other than irrigation.

Township North or South	Range E. or W. of Willamette Meridian	Section	Forty-acre Tract	Number Acres To Be Irrigated	Date of Reclamation
I ⁸ S	5 W	27	SE 1/4 of SE 1/4	20 A	9-29-52
I ⁸ S	5 1/2 W	26	SW 1/4 of SW 1/4 of S. W. 1/4	10	"
I ⁸ S	5 W	27	NE 1/4 of S. E. 1/4	20 A	"
				60 A	

15. If the ground water supply is supplemental to an existing water supply, identification of any application for a permit, permit, certificate or adjudicated right to appropriate water made or held by the registrant.

Township 145 Range 5W, W.M.
North

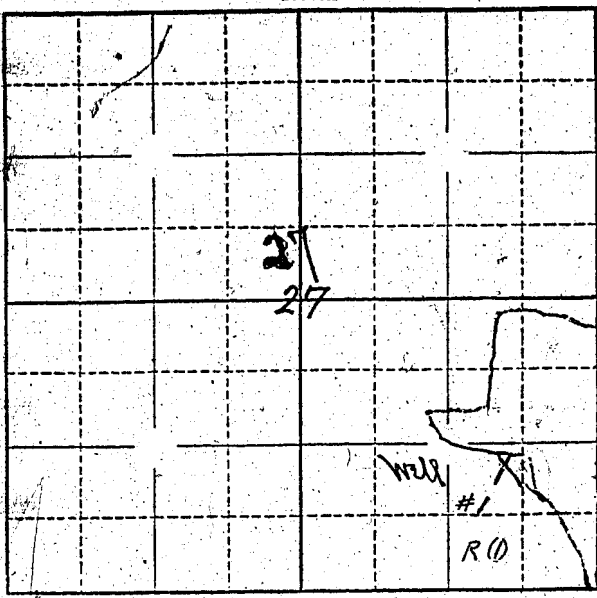

Locate well and acreage of irrigated land on plat.
Scale: 2" = 1 Mile

STATE OF OREGON }
County of Benton } ss.

I, C. M. Hubbard, being first duly sworn, do hereby certify that I have read the foregoing Registration Statement and that all of the items therein contained are true to the best of my knowledge and belief.

C. M. Hubbard & Son,
by: [Signature]
(Signature of Registrant)

Subscribed and sworn to before me this 12 day of July, 1957

My commission expires July 25, 1958

[Signature]
(Notary Public)

(SEAL)

CERTIFICATE OF REGISTRATION

STATE OF OREGON }
County of Marion } ss.

This is to certify that the foregoing Registration Statement was received in the office of the State Engineer on the 23rd day of July, 1957, at 1 o'clock A. M. and has been duly recorded in said office in Book No. 4 of Registration Statements on page GR-570 C.

Witness my hand this 16th day of October, 1957

[Signature]
(State Engineer)

By _____
(Deputy)