

Registration Statement

OF CLAIMANT OF RIGHT TO APPROPRIATE GROUND WATER

(Under Chapter 708, Oregon Laws 1955.)

TO THE STATE ENGINEER OF OREGON:

I, James C. Barnes and Betty A. Barnes
of Halsey County of Linn

State of Oregon, do hereby make application for a certificate of registration as evidence of a right to appropriate ground water.

1. Source from which water is withdrawn is pump well
(Flowing well, pump well, infiltration trench, or tunnel)

2. Location is: 2 1/4 miles west of Brownsville
(Approximate distance and direction from nearest city or town)

and is more particularly described as follows:

(a) 25 chains E. South West corner of Land Claim of Charles Rice
(Give distance and bearing to corner of section or other legal subdivision)

being within SW 1/4 SE 1/4 of Sec. 34 Twp. 13 S Rge. 3 W
(Smallest legal subdivision) (N. or S.) (E. or W.)

or (b) within limits of recorded platted property, town or city:

in Lot _____ Block _____ of _____
(Name of plat or addition)

County of _____
(If within city or town, give name)

3. Construction Work was begun on July 23, 1954 was completed on July 27, 1954
(Date) (Date)

and the ground water claimed was first used for the purposes set out below on May 15, 1955
(Date)

since which time the water has been used Continuously during summer months
(Continuously or intermittently)

from May 15, 1955 to Oct. 1, 1955
(Date) (Date)

4. Quantity of water claimed and used is 180 gallons per minute; _____ acre feet per year.

5. Purpose or Purposes for which water is used irrigation
(Domestic, irrigation, municipal, manufacturing, industrial, etc.)

6. Description of Well: Depth 77 feet. Type drilled
(Dug or drilled)

diameter 8 inches. Elevation of ground at well site Valley level 270' feet, mean sea level.
(As near as known)

Depth to water table 12' (6.0) feet.

7. Capacity of Well: 200 g.p.m. with 45 feet drawdown.

200 g.p.m. with 60 feet drawdown.

Date of test July 27, 1954

If Flowing Well: Measured discharge _____ g.p.m. on _____
(Date)

Shut-in pressure at ground surface _____ lbs. per sq. in. on _____
(Date)

Water is controlled by _____
(Cap, valve, etc.)

8. Casing: (Give diameter, commercial specifications and depth below ground surface of each casing size.)

8 inch diameter *plain end welded pipe* from *18 in. above surface* to *74* feet
drive shoe welded on end of casing
 inch diameter from to feet
 inch diameter from to feet
 inch diameter from to feet

Describe and show depth of shoe, plug, adapter, liner or other details:

shoe welded on casing at 74 ft. depth

9. Perforated Casings or Screens:

casing perforated with acetylene torch from *6.4 ft.* to *74 ft.*
(Number per foot and size of perforations, or describe screen)
 from to
 from to
 from to

10. Log of Well: (Describe each stratum or formation clearly, indicate if water bearing, and give thickness and depth as indicated.)

MATERIAL	Thickness (Feet)	Depth to Bottom (Feet)
<i>top soil</i>	<i>0-10</i>	<i>10-</i>
<i>rock</i>	<i>10-</i>	<i>28-</i>
<i>pea gravel</i>	<i>28-</i>	<i>35-</i>
<i>clay</i>	<i>35-</i>	<i>60'</i>
<i>pea gravel</i>	<i>60-</i>	<i>70-</i>
<i>pea gravel & black sand</i>	<i>70-</i>	<i>75-</i>
<i>black sand</i>	<i>75-</i>	<i>77-</i>

If log of well is not available, give name and address of driller. _____

11. Infiltration Trench: Covered or open _____

Dimensions: Length _____ ft. Minimum depth _____ ft. Maximum depth _____ ft.

Bottom width _____ ft. Discharge _____ g.p.m. Date of test _____

12. Tunnel: Type of lining _____

Dimensions: _____
(Length, course, and cross sectional size)

Position of water bearing stratum with reference to portal of tunnel _____

Log of tunnel: (Preceding table for log of well may be used, if desired. Give footage from portal and character of materials, as pertinent.) _____

13. Pumping Equipment:

(a) Pump Fairbanks Morse turbine, 10 horse Capacity 180 g.p.m.
(Make, type and size)

(b) Motor Fairbanks Morse, 10 h.p.
(Type and horsepower)

14. Location of area irrigated or to be irrigated, or place of use if for purposes other than irrigation.

Township North or South	Range E. or W. of Willamette Meridian	Section	Forty-acre Tract	Number Acres To Be Irrigated	Date of Reclamation
<u>13-S</u>	<u>3W</u>	<u>34</u>		52	<u>May 15-1955</u>
"	"	"	<u>NW 1/4 of SE 1/4</u>	<u>40</u>	" " "
"	"	"	<u>SW 1/4 of SE 1/4</u>	<u>12</u>	" " "
				<u>52 acres</u>	

15. If the ground water supply is supplemental to an existing water supply, identification of any application for a permit, permit, certificate or adjudicated right to appropriate water made or held by the registrant. _____

Township 13 S Range 3 W, W.M.
North

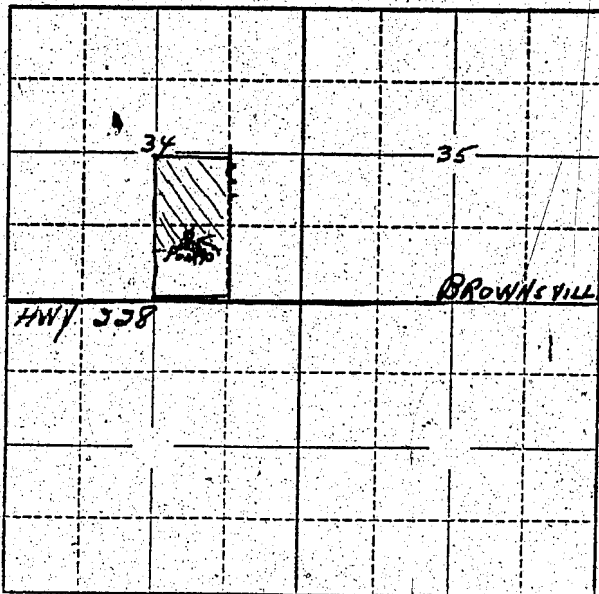

Locate well and acreage of irrigated land on plat.

Scale: 2" = 1 Mile

STATE OF OREGON

County of LINN

} ss.

I, James C. Barnes, being first duly sworn, do hereby certify that I have read the foregoing Registration Statement and that all of the items therein contained are true to the best of my knowledge and belief.

James C. Barnes
(Signature of Registrant)

Subscribed and sworn to before me this 7th day of December, 1955.

My commission expires June 30, 1957

[Signature]
(Notary Public)

(SEAL)

CERTIFICATE OF REGISTRATION

STATE OF OREGON

County of Marion

} ss.

This is to certify that the foregoing Registration Statement was received in the office of the State Engineer on the 8th day of December, 1955, at 9:00 o'clock A. M. and has been duly recorded in said office in Book No. 1 of Registration Statements on page 50.

Construction shall be completed by 1955, and the water completely applied to beneficial use by 1955.

Witness my hand this 24th day of February, 1956.

[Signature]
(State Engineer)

By _____
(Deputy)