

# Registration Statement

## OF CLAIMANT OF RIGHT TO APPROPRIATE GROUND WATER

TO THE STATE ENGINEER OF OREGON:

I, Finis H. Smith

of Route 4, Box 523, Grants Pass, County of Jackson  
(Mailing address)

State of Oregon, do hereby make application for a certificate of registration as evidence of a right to appropriate ground water.

1. Source from which water is withdrawn is infiltration trench  
(Flowing well, pump-well, infiltration trench, or tunnel)

2. Location is: approximately 4 miles North and west of Applegate, Oregon  
(Approximate distance and direction from nearest city or town)

and is more particularly described as follows:

(a) 2550' S. and 680' E. from the NW corner Section 6  
(Give distance and bearing to corner of section or other legal subdivision)

being within SW 1/4 - NW 1/4 of Sec. 6, Twp. 38 S., Rge. 4 W.  
(Smallest legal subdivision) (N. or S.) (E. or W.)

or (b) within limits of recorded platted property, town or city:

in Lot \_\_\_\_\_, Block \_\_\_\_\_ of \_\_\_\_\_  
(Name of plat or addition)

County of \_\_\_\_\_  
(If within city or town, give name)

3. Construction Work was begun on April 1946; was completed on May 1948  
(Date) (Date)

and the ground water claimed was first used for the purposes set out below on May 1946  
(Date)

since which time the water has been used continuously  
(Continuously or intermittently)

from 1946 to 1957  
(Date) (Date)

4. Quantity of water claimed and used is 510 gallons per minute; 207 acre feet per year.

5. Purpose or Purposes for which water is used irrigation and supplemental irrigation

See Item 11 (Domestic, irrigation, municipal, manufacturing, industrial, etc.)

6. Description of Well: Depth 13 feet. Type CNE  
(Dug or drilled)

diameter 180' x 50' ~~inches~~ Elevation of ground at well site 1190 feet, mean sea level.  
(As near as known)

Depth to water table 4.0 feet.

7. Capacity of Well: 510 g.p.m. with 2.5 feet drawdown.

\_\_\_\_\_ g.p.m. with \_\_\_\_\_ feet drawdown.

Date of test 1948

If Flowing Well: Measured discharge \_\_\_\_\_ g.p.m. on \_\_\_\_\_  
(Date)

Shut-in pressure at ground surface \_\_\_\_\_ lbs. per sq. in. on \_\_\_\_\_  
(Date)

Water is controlled by \_\_\_\_\_  
(Cap, valve, etc.)





Township 38 S. Range 4 W., W.M.  
North

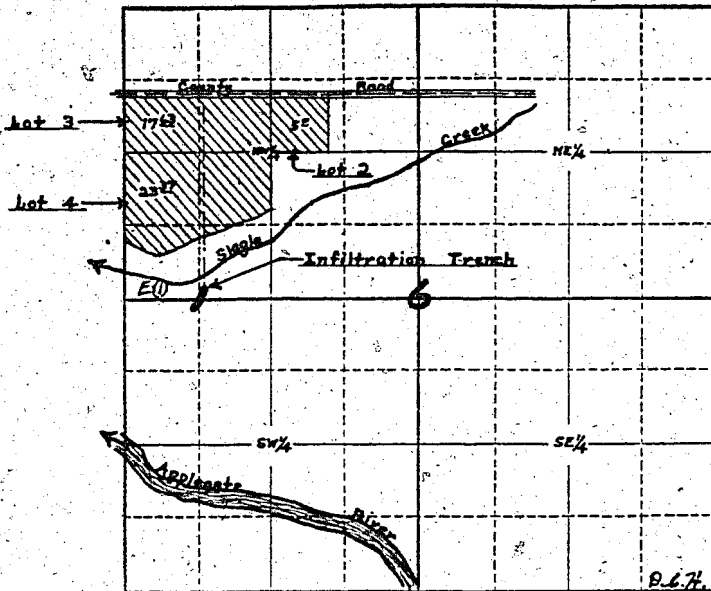

Locate well and acreage of irrigated land on plat.  
Scale: 4" = 1 Mile

STATE OF OREGON

County of Jackson } ss.

I, Arnis H. Smith, being first duly sworn, do hereby certify that I have read the foregoing Registration Statement and that all of the items therein contained are true to the best of my knowledge and belief.

Arnis H. Smith  
(Signature of Registrant)

Subscribed and sworn to before me this 15<sup>th</sup> day of August, 19 57

My commission expires Nov. 23-1960

Lyndal Neil  
(Notary Public) for Oregon

(SEAL)

**CERTIFICATE OF REGISTRATION**

STATE OF OREGON

County of Marion } ss.

This is to certify that the foregoing Registration Statement was received in the office of the State Engineer on the 23rd day of August, 19 57, at 1:00 o'clock P.M. and has been duly recorded in said office in Book No. 4 of Registration Statements on page GR-559-C.

Witness my hand this 27th day of November, 19 57.

LEWIS A. STANLEY  
(State Engineer)

By [Signature]  
(Deputy)

GR-559 C

\$17.40