

Registration Statement

OF CLAIMANT OF RIGHT TO APPROPRIATE GROUND WATER

TO THE STATE ENGINEER OF OREGON:

I, Louis Hillecke

of Route 4, Hillsboro County of Washington

(Mailing address)

State of Oregon, do hereby make application for a certificate of registration as evidence of a right to appropriate ground water.

1. Source from which water is withdrawn is pump well

(Flowing well, pump well, infiltration trench, or tunnel)

2. Location is: Approximately 2 1/2 miles south and 1 mile east of Hillsboro, Oregon.

(Approximate distance and direction from nearest city or town)

and is more particularly described as follows:

(a) S. 71° 45' W. 1465 feet from the northeast corner of Section 19,

(Give distance and bearing to corner of section or other legal subdivision)

being within NW 1/4 of NE 1/4 of Sec. 19, Twp. 1 S., Rge. 2 W.

(Smallest legal subdivision)

(N. or S.)

(E. or W.)

or (b) within limits of recorded platted property, town or city:

in Lot _____, Block _____ of _____

(Name of plat or addition)

County of Washington

(If within city or town, give name)

* 3. Construction Work was begun on Summer of 1950; was completed on Summer of 1953

(Date)

(Date)

and the ground water claimed was first used for the purposes set out below on Fall of 1950

(Date)

since which time the water has been used intermittently

(Continuously or intermittently)

from May 1 to September 1

(Date)

(Date)

4. Quantity of water claimed and used is 17 gallons per minute; 3 acre feet per year.

5. Purpose or Purposes for which water is used irrigation

(Domestic, irrigation, municipal, manufacturing, industrial, etc.)

6. Description of Well: Depth 900 feet. Type drilled

10" for 260'

(Dug or drilled)

diameter then 4 inches. Elevation of ground at well site 127 feet, mean sea level.

(As near as known)

Depth to water table 20 feet.

7. Capacity of Well: 100 g.p.m. with 160 feet drawdown.

_____ g.p.m. with _____ feet drawdown.

Date of test September, 1950

If Flowing Well: Measured discharge _____ g.p.m. on _____

(Date)

Shut-in pressure at ground surface _____ lbs. per sq. in. on _____

(Date)

Water is controlled by _____

(Cap, valve, etc.)

*Driller went down about 600 feet in 1950. Well deepened in 1953. Irrigation in meantime from tapped vein.

8. Casing: (Give diameter, commercial specifications and depth below ground surface of each casing size.)

10 inch diameter from Surface to 260 feet
 4 inch diameter (inside 6" pipe to about 600') from 260 to 840 feet
 inch diameter from to feet
 inch diameter from to feet

Describe and show depth of shoe, plug, adapter, liner or other details: None.

Depth of pump, 250 feet.

9. Perforated Casings or Screens:

40 feet of 8" casing, with 1/8" x 12" torch from to
 (Number per foot and size of perforations, or describe screen)
 perforations, 4 per foot from 220' to 260'
 from to
 from to

10. Log of Well: (Describe each stratum or formation clearly, indicate if water bearing, and give thickness and depth as indicated.)

MATERIAL	Thickness (Feet)	Depth to Bottom (Feet)
Brown clay	15	15
Sandy clay	10	25
Quicksand	35	60
Blue mud	30	90
Blue clay and sand	28	118
Sand	20	138
Blue clay and boulders	5	143
Yellow clay and gravel	26	169
Blue clay and gravel	91	260
Water-bearing sand and gravel	7	267
Varicolored clay	426	693
Red clay	71	764
Yellow clay	28	792
Varicolored clay	26	818
Decomposed rock	14	832
Gray sand and clay	9	841
Decomposed rock	23	864
Gray rock	9	873
Brown rock	30	903

Township 15 Range 2W, W.M.
North

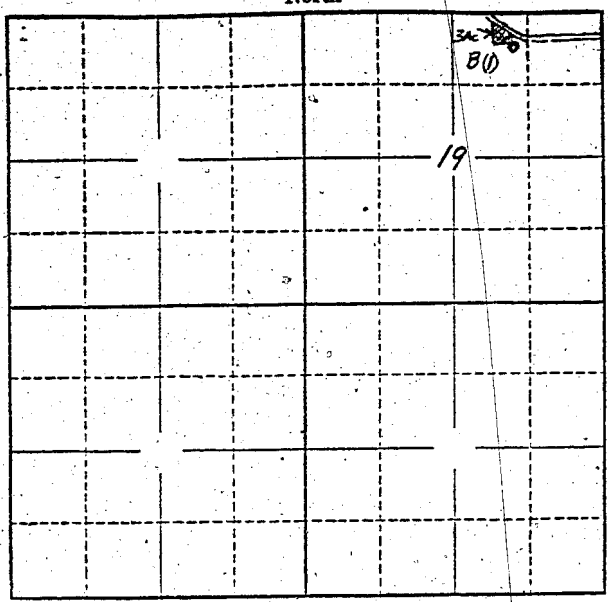

Locate well and acreage of irrigated land on plat.
Scale: 2" = 1 Mile

STATE OF OREGON }
County of Washington } ss.

I, Louis Hillecke, being first duly sworn, do hereby certify that I have read the foregoing Registration Statement and that all of the items therein contained are true to the best of my knowledge and belief.

Louis Hillecke
(Signature of Registrant)

Subscribed and sworn to before me this 15th day of August, 19 57

My commission expires April 3, 1959 Shirley Sullivan
(Notary Public)

(SEAL)

CERTIFICATE OF REGISTRATION

STATE OF OREGON }
County of Marion } ss.

This is to certify that the foregoing Registration Statement was received in the office of the State Engineer on the 26th day of August, 19 57, at 8:00 o'clock A. M. and has been duly recorded in said office in Book No. 4 of Registration Statements on page GR-561 C.

Witness my hand this 13th day of September, 19 57

Lewis A. Blaney
(State Engineer)

#1500

By _____
(Deputy)