

Registration Statement

OF CLAIMANT OF RIGHT TO APPROPRIATE GROUND WATER

TO THE STATE ENGINEER OF OREGON:

I, Jack J. Koop Or Frances Koop or survivor
Route 1, Box 69
of Rogue River, Oregon County of Jackson
(Mailing address)

State of Oregon, do hereby make application for a certificate of registration as evidence of a right to appropriate ground water.

1. Source from which water is withdrawn is pump well
(Flowing-well, pump well, infiltration trench, or tunnel)
2. Location is: at Wimer, Oregon.
(Approximate distance and direction from nearest city or town)

and is more particularly described as follows:

(a) 1060' S. and 380' E. from the W¹ corner of Section 11
(Give distance and bearing to corner of section or other legal subdivision)
being within NW¹, SW¹ of Sec. 11, Twp. 35 S., Rge. 11 W.
(Smallest legal subdivision) (N. or S.) (E. or W.)
or (b) within limits of recorded platted property, town or city:
in Lot _____, Block _____ of _____
(Name of plat or addition)

County of _____
(If within city or town, give name)

3. Construction Work was begun on March - 1953; was completed on May - 1953
(Date) (Date)
and the ground water claimed was first used for the purposes set out below on May - 1953,
(Date)
since which time the water has been used intermittently
(Continuously or intermittently)
from March - 1953 to July - 1957
(Date) (Date)

4. Quantity of water claimed and used is 90 gallons per minute; 23 acre feet per year.

5. Purpose or Purposes for which water is used irrigation
(Domestic, irrigation, municipal, manufacturing, industrial, etc.)

6. Description of Well: Depth 9 feet. Type dug
(Dug or drilled)
diameter 6' x 8' ~~radius~~ Elevation of ground at well site 1154 feet, mean sea level.
(As near as known)
Depth to water table 6 feet.

7. Capacity of Well: 90 g.p.m. with 2 feet drawdown,
_____ g.p.m. with _____ feet drawdown.
Date of test May - 1953

If Flowing Well: Measured discharge _____ g.p.m. on _____
(Date)

Shut-in pressure at ground surface _____ lbs. per sq. in. on _____
(Date)

Water is controlled by _____
(Cap, valve, etc.)

Township 35 S. Range 4 W., W.M.
North

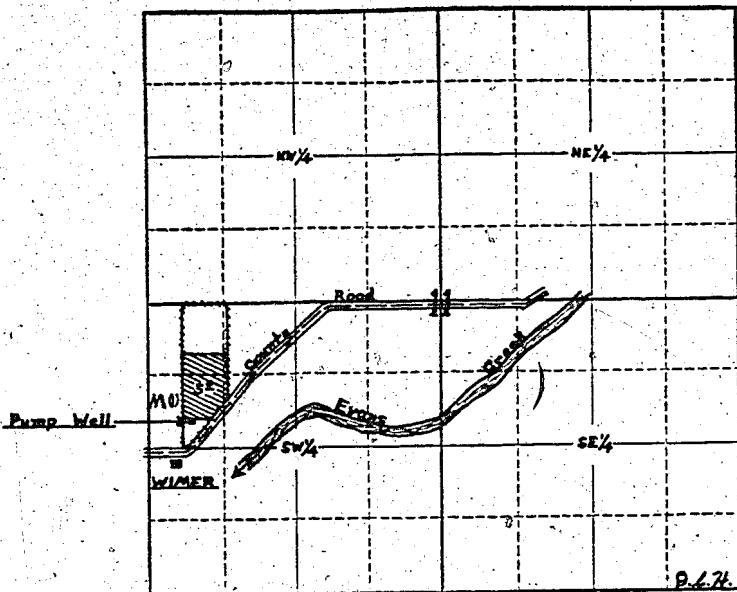

Locate well and acreage of irrigated land on plat.

Scale: 4" = 1 Mile

STATE OF OREGON

County of Jackson } ss.

we Jack J. Koop & Frances Koop, being first duly sworn, do hereby certify that I have read the foregoing Registration Statement and that all of the items therein contained are true to the best of my knowledge and belief.

Frances Koop
(Signature of Registrant)

Subscribed and sworn to before me this 27th day of August, 1957.

My commission expires Apr 3rd 1958 D M Stanzinger
(Notary Public)

(SEAL)

CERTIFICATE OF REGISTRATION

STATE OF OREGON

County of Marion } ss.

This is to certify that the foregoing Registration Statement was received in the office of the State Engineer on the 28th day of August, 1957 at 1:00 o'clock P.M. and has been duly recorded in said office in Book No. 4 of Registration Statements on page GR-568 C.

Witness my hand this 16th day of September, 1957.

Lewis A. Stanley
(State Engineer)

By _____
(Deputy)

GR - 568 C

\$15.00