

RECEIVED

SEP 2 1955  
STATE ENGINEER  
SALEM, OREGON

REGISTRATION NO. GR-6  
CERTIFICATE NO. GR-5

### Registration Statement

#### OF CLAIMANT OF RIGHT TO APPROPRIATE GROUND WATER

(Under Chapter 708, Oregon Laws 1955.)

TO THE STATE ENGINEER OF OREGON:

I, J. Paul Peyralans

of Rt. 1, Box 278, Gresham, Ore. County of Multnomah

State of Oregon, do hereby make application for a certificate of registration as evidence of a right to appropriate ground water.

1. Source from which water is withdrawn is pump well  
(Flowing well, pump well, infiltration trench, or tunnel)

2. Location is: 2 miles southwest of Gresham, Oregon  
(Approximate distance and direction from nearest city or town)

and is more particularly described as follows:

(a) Well is located 1320 ft. north of the section corner 17, 16, 20 & 21  
(Give distance and bearing to corner of section or other legal subdivision)

being within on the section line between Sec. 17 & 16, Twp. 1 S., Rge. 1 E.  
(Smallest legal subdivision) (N. or S.) (E. or W.)

or (b) within limits of recorded platted property, town or city:

in Lot \_\_\_\_\_, Block \_\_\_\_\_ of \_\_\_\_\_  
(Name of plat or addition)

County of \_\_\_\_\_  
(If within city or town, give name)

3. Construction Work was begun on 1934, was completed on 1934  
(Date) (Date)

and the ground water claimed was first used for the purposes set out below on July 1934  
(Date)

since which time the water has been used continuously  
(Continuously or intermittently)

from Jan. 1 to Dec. 31  
(Date) (Date)

4. Quantity of water claimed and used is 100 gallons per minute; 2 acre feet per year.

5. Purpose or Purposes for which water is used to sprinkle greenhouses and home garden.

(approximately 18000 sq. ft. of greenhouse)  
(Domestic, irrigation, municipal, manufacturing, industrial, etc.)

6. Description of Well: Depth 175 feet. Type drilled  
(Dug or drilled)

diameter 6 inches. Elevation of ground at well site 100 feet, mean sea level.  
(As near as known)

Depth to water table 150 feet.

7. Capacity of Well: \_\_\_\_\_ g.p.m. with \_\_\_\_\_ feet drawdown.

\_\_\_\_\_ g.p.m. with \_\_\_\_\_ feet drawdown.

Date of test never tested.

If Flowing Well: Measured discharge \_\_\_\_\_ g.p.m. on \_\_\_\_\_  
(Date)

Shut-in pressure at ground surface \_\_\_\_\_ lbs. per sq. in. on \_\_\_\_\_  
(Date)

Water is controlled by \_\_\_\_\_  
(Cap, valve, etc.)





Township 18 Range 3E, W.M.  
North

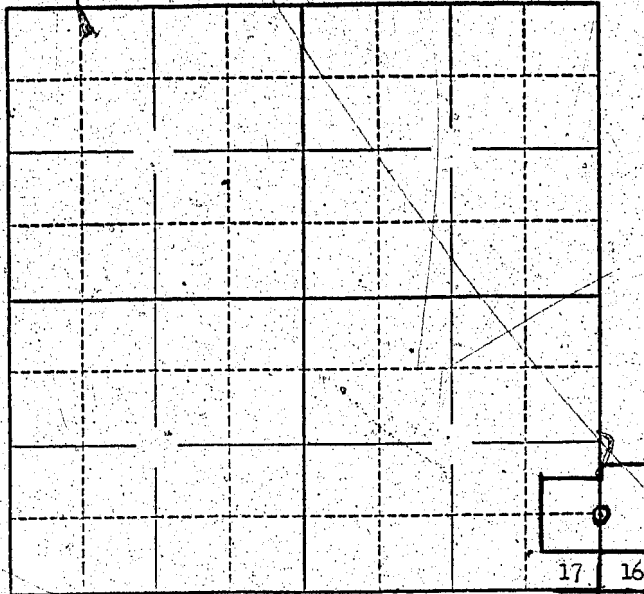

Location of well.

Locate well and acreage of irrigated land on plat. 20 21  
Scale: 2" = 1 Mile

STATE OF OREGON }  
County of Washington } ss.

I, J. Paul Reynolds, being first duly sworn, do hereby certify that I have read the foregoing Registration Statement and that all of the items therein contained are true to the best of my knowledge and belief.

J. Paul Reynolds  
(Signature of Registrant)

Subscribed and sworn to before me this 4 day of September, 1955

My commission expires February 26, 1956  
W. C. Jones  
(Notary Public)

(SEAL)

**CERTIFICATE OF REGISTRATION**

STATE OF OREGON }  
County of Marion } ss.

This is to certify that the foregoing Registration Statement was received in the office of the State Engineer on the 2nd day of September, 1955, at 8:00 o'clock A. M. and has been duly recorded in said office in Book No. 1 of Registration Statements on page 5

Construction shall be completed by 15 19 and the water is completely applied to beneficial use by 19

Witness my hand this 24th day of February, 1956.

Lewis A. Stanley  
(State Engineer)

By \_\_\_\_\_  
(Deputy)