

Registration Statement

OF CLAIMANT OF RIGHT TO APPROPRIATE GROUND WATER

TO THE STATE ENGINEER OF OREGON:

I, S. O. Griffith
of Rt. 1, Tangent County of Linn
(Mailing address)

State of Oregon do hereby make application for a certificate of registration as evidence of a right to appropriate ground water.

1. Source from which water is withdrawn is Pump Well
(Flowing well, pump well, infiltration trench, or tunnel)

2. Location is: 4 miles south of Albany, Oregon
(Approximate distance and direction from nearest city or town)

and is more particularly described as follows:

(a) N. 73° 45' E. 2.75 chains from SW corner of NW 1/4 S. 21, T. 11 S, R. 3 W.
(Give distance and bearing to corner of section or other legal subdivision)

being within SW 1/4 of NW 1/4 of Sec. 31, Twp. 11 S, Rge. 3 W
(Smallest legal subdivision) (N. or S.) (E. or W.)

or (b) within limits of recorded platted property, town or city:

in Lot _____, Block _____ of _____
(Name of plat or addition)

County of Linn
(If within city or town, give name)

3. Construction Work was begun on April 1951; was completed on May 1951
(Date) (Date)

and the ground water claimed was first used for the purposes set out below on Aug. 1951
(Date)

since which time the water has been used continuously
(Continuously or intermittently)

from Aug. 1951 to present time
(Date) (Date)

4. Quantity of water claimed and used is 100 gallons per minute; 71.25 acre feet per year.

5. Purpose or Purposes for which water is used Irrigation

(Domestic, irrigation, municipal, manufacturing, industrial, etc.)

6. Description of Well: Depth 65 feet. Type Drilled
(Dug or drilled)

diameter 6 inches. Elevation of ground at well site 235 feet, mean sea level.
(As near as known)

Depth to water table 15 feet.

7. Capacity of Well: 96 g.p.m. with 30 feet drawdown.

_____ g.p.m. with _____ feet drawdown.

_____ Not tested - estimated.

Well: Measured discharge _____ g.p.m. on _____
(Date)

_____ Pressure at ground surface _____ lbs. per sq. in. on _____
(Date)

Water is controlled by _____
(Cap, valve, etc.)

Township 11 S Range 3 & 4 W., W.M.
North

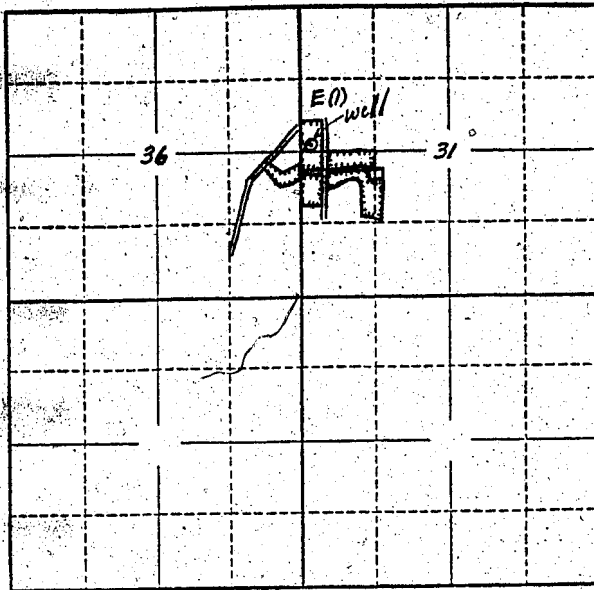

Locate well and acreage of irrigated land on plat.
Scale: 2" = 1 Mile

STATE OF OREGON }
County of LINN } ss.

I, S. O. Griffith, being first duly sworn, do hereby certify that I have read the foregoing Registration Statement and that all of the items therein contained are true to the best of my knowledge and belief.

S. O. Griffith
(Signature of Registrant)

Subscribed and sworn to before me this 24 day of September, 1957.

My commission expires 11-28-59 Edna H. Granger
(Notary Public)

(SEAL)

CERTIFICATE OF REGISTRATION

STATE OF OREGON }
County of Marion } ss.

This is to certify that the foregoing Registration Statement was received in the office of the State Engineer on the 6th day of September, 1957, at 8:00 o'clock A. M. and has been duly recorded in said office in Book No. 4 of Registration Statements on page GR-576 C.

Witness my hand this 16th day of October, 1957.
Lewis A. Stanley
(State Engineer)

By _____
(Deputy)

GR-576 C