

Registration Statement

OF CLAIMANT OF RIGHT TO APPROPRIATE GROUND WATER

(Under Chapter 708, Oregon Laws 1955.)

Well No. 1

TO THE STATE ENGINEER OF OREGON:

I, Frank G. Chooling

of *Forest Grove* City, County of *Clatsop*

State of *Oregon*, do hereby make application for a certificate of registration as evidence of a right to appropriate ground water.

1. Source from which water is withdrawn is *Pump well*
(Flowing well, pump well, infiltration trench, or tunnel)

2. Location is: *3 mi. north of Forest Grove, Or.*
(Approximate distance and direction from nearest city or town)

and is more particularly described as follows:

(a) *B. 1073 etc. to a point and 64 ft. West S. 1/4 Sec. 17*
(Give distance and bearing to corner of section or other legal subdivision)

being within *S. 1/4 Sec. 17* of Sec. *17*, Twp. *15 S.*, Rge. *4 W.*
(Smallest legal subdivision) (N. or S.) (E. or W.)

or (b) within limits of recorded platted property, town or city:

in Lot _____, Block _____ of _____
(Name of plat or addition)

County of _____
(If within city or town, give name)

3. Construction Work was begun on *1942* _____; was completed on _____
(Date) (Date)

and the ground water claimed was first used for the purposes set out below on *July 1 - 1942*
(Date)

since which time the water has been used *continuously*
(Continuously or intermittently)

from *July 1* to *Sept. 10*
(Date) (Date)

4. Quantity of water claimed and used is *250* gallons per minute; *2 ft.* acre feet per year.

5. Purpose or Purposes for which water is used *irrigation and pasture*
(Domestic, irrigation, municipal, manufacturing, industrial, etc.)

6. Description of Well: Depth *approx 30* feet. Type *dug*
(Dug or drilled)

diameter *4* inches. Elevation of ground at well site *620* feet mean sea level.
(As near as known)

Depth to water table *15* feet.

7. Capacity of Well: *250* g.p.m. with *4* feet drawdown.

I have tried about the same drawdown.
_____ g.p.m. with _____ feet drawdown.

Date of test *July 27, 1954*

If Flowing-Well: Measured discharge _____ g.p.m. on _____
(Date)

Shut-in pressure at ground surface _____ lbs. per sq. in. on _____
(Date)

Water is controlled by _____
(Cap, valve, etc.)

8. **Casing:** (Give diameter, commercial specifications and depth below ground surface of each casing size.)

..... inch diameter from to feet
 inch diameter from to feet
 inch diameter from to feet
 inch diameter from to feet

Describe and show depth of shoe, plug, adapter, liner or other details:

9. **Perforated Casings or Screens:**

(Number per foot and size of perforations, or describe screen)
 from to
 from to
 from to
 from to

10. **Log of Well:** (Describe each stratum or formation clearly, indicate if water bearing, and give thickness and depth as indicated.)

MATERIAL	Thickness (Feet)	Depth to Bottom (Feet)
<i>In my territory there is an average of 16 ft of water bearing gravel and sand in the soil.</i>		

If log of well is not available, give name and address of driller.

11. Infiltration Trench: Covered or open

Dimensions: Length ft. Minimum depth ft. Maximum depth ft.

Bottom width ft. Discharge g.p.m. Date of test

12. Tunnel: Type of lining

Dimensions: (Length, course, and cross sectional size)

Position of water bearing stratum with reference to portal of tunnel

Log of tunnel: (Preceding table for log of well may be used, if desired. Give footage from portal and character of materials, as pertinent.)

13. Pumping Equipment: *Horizontal*

(a) Pump *Franklin Electric Motor* 10 HP Electric Capacity *250* g.p.m.
(Make, type and size)

(b) Motor *Franklin Electric Motor*
(Type and horsepower)

14. Location of area irrigated or to be irrigated, or place of use if for purposes other than irrigation.

Township North or South	Range E. or W. of Willamette Meridian	Section	Forty-acre Tract	Number Acres To Be Irrigated	Date of Reclamation
<i>15 S</i>	<i>4 W</i>	<i>17</i>	<i>S. 10. 1/4 Sec. 20. 1/4</i>	<i>6 1/2</i>	<i>1942</i>

15. If the ground water supply is supplemental to an existing water supply, identification of any application for a permit, permit, certificate or adjudicated right to appropriate water made or held by the registrant:

Township 15S Range 4W W.M.
North

I am verifying the amount of irrigated land as shown on the plat.

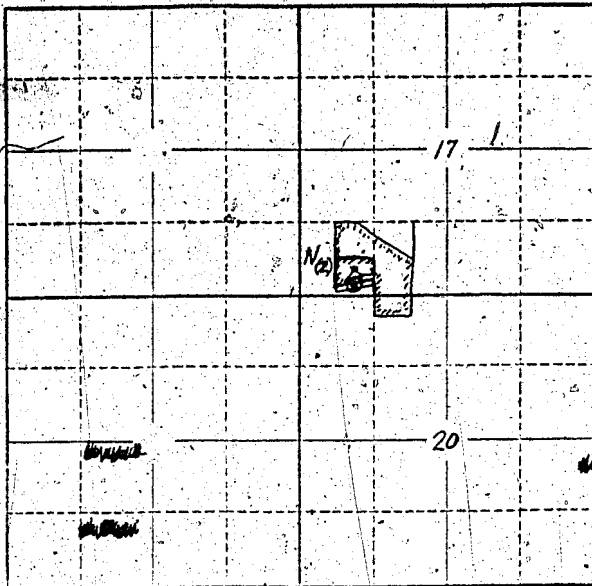

Locate well and acreage of irrigated land on plat.

Scale: 2" = 1 Mile

STATE OF OREGON

County of Lane

ss.

I, Cyril Schindler, being first duly sworn, do hereby certify that I have read the foregoing Registration Statement and that all of the items therein contained are true to the best of my knowledge and belief.

Cyril Schindler
(Signature of Registrar)

Subscribed and sworn to before me this 6th day of September, 1957.

My commission expires April 11, 1960

Elmer Stuebner
(Notary Public)

(SEAL)

CERTIFICATE OF REGISTRATION

STATE OF OREGON

County of Marion

ss.

This is to certify that the foregoing Registration Statement was received in the office of the State Engineer on the 11 day of September, 1957, at 8:00 o'clock A. M. and has been duly recorded in said office in Book No. of Registration Statements on page GR 764-C

~~Construction shall be completed by and the record thereon applied to beneficial use by~~

Witness my hand this 4th day of February, 1957

Laura A. Stanley
(State Engineer)

By
(Deputy)

GR-761C