

Registration Statement

OF CLAIMANT OF RIGHT TO APPROPRIATE GROUND WATER

(Under Chapter 708, Oregon Laws 1955.)

TO THE STATE ENGINEER OF OREGON:

I, Richard and F.C. Foltzof Aumsville Road County of MarionState of Oregon, do hereby make application for a certificate of registration as evidence of a right to appropriate ground water.1. Source from which water is withdrawn is Infiltration Trench

(Flowing well, pump well, infiltration trench, or tunnel)

2. Location is: 2 Miles N. West of Stayton, Oregon

(Approximate distance and direction from nearest city or town)

and is more particularly described as follows:

(a) North 61° 27' West 1425' from the S.E. Cor. of Sec. 5 T9S R1 W.W.M.

(Give distance and bearing to corner of section or other legal subdivision)

being within the S.E. 1/4 of S.E. 1/4 of Sec. 5, Twp. 9S, Rge. 1W

(Smallest legal subdivision)

(N. or S.)

(E. or W.)

or (b) within limits of recorded platted property, town or city:

in Lot _____, Block _____ of _____

(Name of plat or addition)

County of _____

(If within city or town, give name)

3. Construction Work was begun on April 1954, was completed on April 1954

(Date)

(Date)

and the ground water claimed was first used for the purposes set out below on June 1954

(Date)

since which time the water has been used Continuously during May - Sept.

(Continuously or intermittently)

from May to Sept. 30

(Date)

(Date)

4. Quantity of water claimed and used is 320 gallons per minute; _____ acre feet per year.5. Purpose or Purposes for which water is used Irrigation

(Domestic, irrigation, municipal, manufacturing, industrial, etc.)

6. Description of Well: Depth 9 feet. Type Excavated

(Dug or drilled)

diameter 16 x 50' inches. Elevation of ground at well site 488 feet, mean sea level.

(As near as known)

Depth to water table 1 1/2 feet.7. Capacity of Well: 320 g.p.m. with 6 feet drawdown.

_____ g.p.m. with _____ feet drawdown.

Date of test Anytime during Irrigation

If Flowing Well: Measured discharge _____ g.p.m. on _____

(Date)

Shut-in pressure at ground surface _____ lbs. per sq. in. on _____

(Date)

Water is controlled by _____

(Cap, valve, etc.)

8. Casing: (Give diameter, commercial specifications and depth below ground surface of each casing size.)

7 1/2" apple core
 inch diameter from to feet
 inch diameter from to feet
 inch diameter from to feet
 inch diameter from to feet

Describe and show depth of shoe, plug, adapter, liner or other details:

9. Perforated Casings or Screens:

..... from to
 (Number per foot and size of perforations, or describe screen)
 from to
 from to
 from to

10. Log of Well: (Describe each stratum or formation clearly, indicate if water bearing, and give thickness and depth as indicated.)

MATERIAL	Thickness (Feet)	Depth to Bottom (Feet)
Gravel Soil	9	9
Large river gravel	-	-

If log of well is not available, give name and address of driller.

11. Infiltration Trench: Covered or open open
 Dimensions: Length 50 ft. Minimum depth 4 ft. Maximum depth 9 ft.
 Bottom width 16 ft. Discharge 320 g.p.m. Date of test May to Oct.

12. Tunnel: Type of lining
 Dimensions:
 (Length, course, and cross sectional size)
 Position of water bearing stratum with reference to portal of tunnel

Log of tunnel: (Preceding table for log of well may be used, if desired. Give footage from portal and character of materials, as pertinent.)

13. Pumping Equipment:
 (a) Pump intake 2 1/2" discharge 3" Capacity 320+ g.p.m.
 (Make, type and size)
 (b) Motor 32 H.P. Gea motor (Wiscams)
 (Type and horsepower)

14. Location of area irrigated or to be irrigated, or place of use if for purposes other than irrigation.

Township North or South	Range E. or W. of Willamette Meridian	Section	Forty-acre Tract	Number Acres To Be Irrigated	Date of Reclamation
<u>9S</u>	<u>1W</u>	<u>5</u>	<u>NE of SE</u>	<u>3</u>	
			<u>SE of SE</u>	<u>25</u>	
				<u>28</u>	

15. If the ground water supply is supplemental to an existing water supply, identification of any application for a permit, permit, certificate or adjudicated right to appropriate water made or held by the registrant.

Township 2 S Range 1 W, W.M.
North

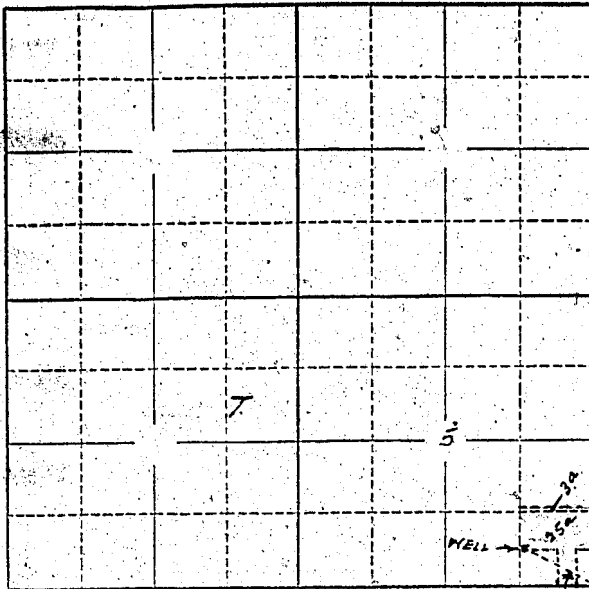

Locate well and acreage of irrigated land on plat.
Scale: 2" = 1 Mile

N15°27'W
142.5 Feet

STATE OF OREGON }
County of Marion } ss.

I, Richard Foltz - F.C. Foltz being first duly sworn, do hereby certify that I have read the foregoing Registration Statement and that all of the items therein contained are true to the best of my knowledge and belief.

Richard Jerome Foltz
F.C. Foltz
(Signature of Registrant)

Subscribed and sworn to before me this 9th day of Sept, 1957

My commission expires _____
Edw. S. ...
(Notary Public)

(SEAL)

CERTIFICATE OF REGISTRATION

STATE OF OREGON }
County of Marion } ss.

This is to certify that the foregoing Registration Statement was received in the office of the State Engineer on the 12th day of September, 1957, at 8:00 o'clock A. M. and has been duly recorded in said office in Book No. 4 of Registration Statements on page GR-580 C.

~~X~~ Construction shall be completed by ~~x-x-x-x-x-x-x-x-x-x-x-x-x-x~~ and the water completely applied to beneficial use by ~~x-x-x-x-x-x-x-x-x-x-x-x-x-x~~

Witness my hand this 16th day of October, 1957

Lewis A. Standley
(State Engineer)

2
\$1500

By _____
(Deputy)

GR-580 C