

Registration Statement

OF CLAIMANT OF RIGHT TO APPROPRIATE GROUND WATER # 1

(Under Chapter 708, Oregon Laws 1955.)

TO THE STATE ENGINEER OF OREGON:

I, ALBERT LYONS

of Turner ^{Ret 1} County of Marion

State of Oregon, do hereby make application for a certificate of registration as evidence of a right to appropriate ground water.

1. Source from which water is withdrawn is Pump Well #1
(Flowing well, pump well, infiltration trench, or tunnel)

2. Location is: 4 1/2 Miles Southwest of Stayton, Oregon
(Approximate distance and direction from nearest city or town)

and is more particularly described as follows:

(a) North 7° 35' East 2508.9 feet to NE corner of Sec. 26 T./
(Give distance and bearing to corner of section or other legal subdivision)

being within SE 1/4 of NE 1/4 of Sec. 26, Twp. 9 S., Rge. 2 W.
(Smallest legal subdivision) (N. or S.) (E. or W.)

or (b) within limits of recorded platted property, town or city:

in Lot _____, Block _____ of _____
(Name of plat or addition)

County of _____
(If within city or town, give name)

3. Construction Work was begun on 1947; was completed on 1947
(Date) (Date)

and the ground water claimed was first used for the purposes set out below on _____
(Date)

since which time the water has been used Continuously
(Continuously or Intermittently)

from May 15 to Oct. 1
(Date) (Date)

4. Quantity of water claimed and used is 200 gallons per minute; 30-40 acre feet per year.

5. Purpose or Purposes for which water is used Irrigation

(Domestic, irrigation, municipal, manufacturing, industrial, etc.)

6. Description of Well: Depth 26 feet. Type Drilled
(Dug or drilled)

diameter 8 inches. Elevation of ground at well site 338 feet, mean sea level.
(As near as known)

Depth to water table 13 feet.

7. Capacity of Well: 200 g.p.m. with 5-8 feet drawdown. High and low River affects.
_____ g.p.m. with _____ feet drawdown.

Date of test Any time during irrigation

If Flowing Well: Measured discharge _____ g.p.m. on _____
(Date)

Shut-in pressure at ground surface _____ lbs. per sq. in. on _____
(Date)

Water is controlled by _____
(Cap, valve, etc.)

8. Casing: (Give diameter, commercial specifications and depth below ground surface of each casing size.)

8 inch diameter from 0 to 26 feet
 inch diameter from to feet
 inch diameter from to feet
 inch diameter from to feet

Describe and show depth of shoe, plug, adapter, liner or other details:

9. Perforated Casings or Screens:

10'-10" slots 1/4" from 16 to 26
(Number per foot and size of perforations, or describe screen)

..... from to
 from to
 from to

10. Log of Well: (Describe each stratum or formation clearly, indicate if water bearing, and give thickness and depth as indicated.)

	MATERIAL	Thickness (Feet)	Depth to Bottom (Feet)
	Silt Soil	8'	8
	River gravel	18	26

If log of well is not available, give name and address of driller.

11. Infiltration Trench: Covered or open

Dimensions: Length _____ ft. Minimum depth _____ ft. Maximum depth _____ ft.

Bottom width _____ ft. Discharge _____ g.p.m. Date of test _____

12. Tunnel: Type of lining

Dimensions: _____
(Length, course, and cross sectional size)

Position of water bearing stratum with reference to portal of tunnel

Log of tunnel: (Preceding table for log of well may be used, if desired. Give footage from portal and character of materials, as pertinent.)

13. Pumping Equipment:

(a) Pump Horizontal Centrifugal Capacity 200 g.p.m.
(Make, type and size)

(b) Motor 10 H. P. Electric 3 Phase
(Type and horsepower)

14. Location of area irrigated or to be irrigated, or place of use if for purposes other than irrigation.

Township North or South	Range E. or W. of Willamette Meridian	Section	Forty-acre Tract	Number Acres To Be Irrigated	Date of Reclamation
9 S.	2 W.	26	SE $\frac{1}{4}$ of NE $\frac{1}{4}$	16.16	1947

15. If the ground water supply is supplemental to an existing water supply, identification of any application for a permit, permit, certificate or adjudicated right to appropriate water made or held by the registrant.

Township 9 S Range 2 W W.M.
North

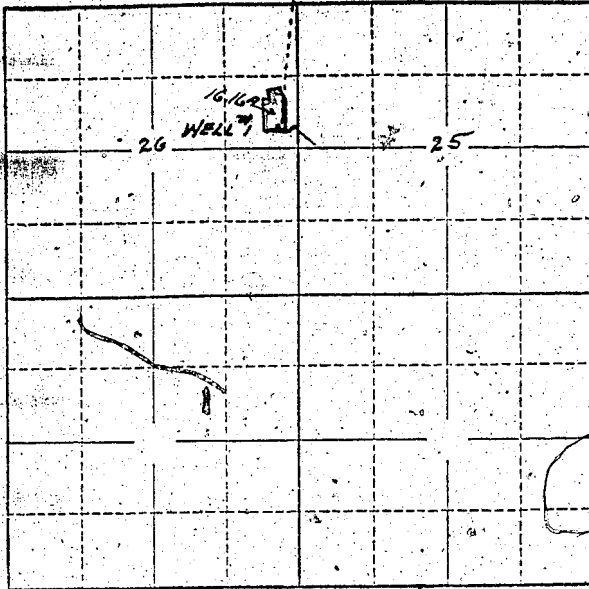

Locate well and acreage of irrigated land on plat.

Scale: 2" = 1 Mile

STATE OF OREGON

County of Marion } ss.

I, Albert Lyons, being first duly sworn, do hereby certify that I have read the foregoing Registration Statement and that all of the items therein contained are true to the best of my knowledge and belief.

Albert Lyons
(Signature of Registrant)

Subscribed and sworn to before me this 9 day of Sept, 1957.

My commission expires 8/21/58 Walter H. Bee
(Notary Public)

(SEAL)

CERTIFICATE OF REGISTRATION

STATE OF OREGON } ss.
County of Marion

This is to certify that the foregoing Registration Statement was received in the office of the State Engineer on the 11th day of September, 1957, at 8:00 o'clock A. M. and has been duly recorded in said office in Book No. 4 of Registration Statements on page GR-581 C.

~~Construction shall be completed by 12-31-58 and the water completely applied to beneficial use by 12-31-58.~~

Witness my hand this 16th day of October, 1957.

Lewis A. Stanley
(State Engineer)

By _____ (Deputy)

GR-581 C

#15-22