

RECEIVED
STATE ENGINEER
JACKSON

Registration No. GR. 613

Certificate No. GR. 583

Registration Statement

OF CLAIMANT OF RIGHT TO APPROPRIATE GROUND WATER

TO THE STATE ENGINEER OF OREGON:

I, David B. Winningham

of Route 2, Box 53-A, Jacksonville, County of Jackson

(Mailing address)

State of Oregon, do hereby make application for a certificate of registration as evidence of a right to appropriate ground water.

1. Source from which water is withdrawn is Infiltration trench

(Flowing well, pump well, infiltration trench, or tunnel)

2. Location is: 17 miles southwest of Jacksonville, Oregon

(Approximate distance and direction from nearest city or town)

and is more particularly described as follows:

(a) 850 feet East and 185 feet North from SW corner of Section 33,

(Give distance and bearing to corner of section or other legal subdivision)

being within SW $\frac{1}{4}$ SW $\frac{1}{4}$ of Sec. 33, Twp. 39 S. Rge. 3 W.

(Smallest legal subdivision)

(N. or S.)

(E. or W.)

or (b) within limits of recorded platted property, town or city:

in Lot _____, Block _____ of _____

(Name of plat or addition)

_____ County of _____

(If within city or town, give name)

3. Construction Work was begun on Jan. 3, 1950; was completed on Feb. 15, 1950

(Date)

(Date)

and the ground water claimed was first used for the purposes set out below on April - 1950

(Date)

since which time the water has been used continuously during irrigation season

(Continuously or intermittently)

from April - 1950 to date

(Date)

(Date)

4. Quantity of water claimed and used is 700 gallons per minute; 4 $\frac{1}{2}$ acre feet per year, per acre.

5. Purpose or Purposes for which water is used irrigation

(Domestic, irrigation, municipal, manufacturing, industrial, etc.)

See Item 11 6. Description of Well: Depth 16 feet, Type dug

(Dug or drilled)

diameter 50' x 320' inches. Elevation of ground at well site 1623 feet, mean sea level.

(As near as known)

Depth to water table 4 (est.) feet.

7. Capacity of Well: _____ g.p.m. with _____ feet drawdown.

_____ g.p.m. with _____ feet drawdown.

Date of test _____

If Flowing Well: Measured discharge _____ g.p.m. on _____

(Date)

Shut-in pressure at ground surface _____ lbs. per sq. in. on _____

(Date)

Water is controlled by _____

(Cap, valve, etc.)

Township 39 S. Range 3 W., W.M.
North

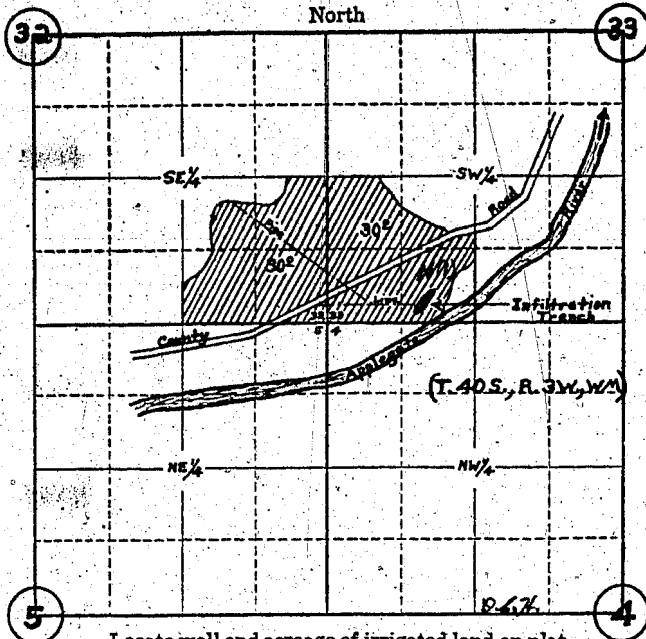

Locate well and acreage of irrigated land on plat.

Scale: 4' = 1 Mile

STATE OF OREGON

County of Jackson } ss.

I, David B. Wimsingham, being first duly sworn, do hereby certify that I have read the foregoing Registration Statement and that all of the items therein contained are true to the best of my knowledge and belief.

David B. Wimsingham
(Signature of Registrant)

Subscribed and sworn to before me this 29th day of August, 1957.

My commission expires August 25, 1958.

Walter C. Kumbacher
(Notary Public)

(SEAL)

CERTIFICATE OF REGISTRATION

STATE OF OREGON

County of Marion } ss.

This is to certify that the foregoing Registration Statement was received in the office of the State Engineer on the 12th day of September, 1957, at 1:00 o'clock P. M. and has been duly recorded in said office in Book No. 4 of Registration Statements on page GR-583 C.

Witness my hand this 16th day of October, 1957.

#1950

Leuro A. Stanley
(State Engineer)

By _____ (Deputy)