

Registration Statement

REGISTRATION NO. GR-62

CERTIFICATE NO. GR-81

OF CLAIMANT OF RIGHT TO APPROPRIATE GROUND WATER

(Under Chapter 708, Oregon Laws 1955.)

TO THE STATE ENGINEER OF OREGON:

I, Ambrose J. Allen Rf 1 Box 74 of WOODBURN County of MARION

State of OREGON, do hereby make application for a certificate of registration as evidence of a right to appropriate ground water.

1. Source from which water is withdrawn is PUMP WELL (Flowing well, pump well, infiltration trench, or tunnel)

2. Location is: 3 miles N.E. of WOODBURN (Approximate distance and direction from nearest city or town)

and is more particularly described as follows: 58 chains west of southeast corner of John PURVINE D.L.G. No 60 in SECT 37 5 38 1W and 400 feet NORTH of ROAD (a) 50 chains west from the southeast corner of donation land claim of John M. PURVINE & WIFE No 60 (Give distance and bearing to corner of section or other legal subdivision)

being within SE 1/4 of NE 1/4 of NW 1/4 of Sec. 37, Twp. 5 south, Rge. 1 W (Smallest legal subdivision) (N. or S.) (E. or W.)

or (b) within limits of recorded platted property, town or city: WILLAMETTE MEADDAIM

in Lot, Block of (Name of plat or addition)

County of MARION (If within city or town, give name)

3. Construction Work was begun on July 15 1953 (Date); was completed on August 3 1953 (Date)

and the ground water claimed was first used for the purposes set out below on August 12 1953 (Date)

since which time the water has been used Intermittently (Continuously or intermittently)

from August 1953 (Date) to 1955 (Date)

4. Quantity of water claimed and used is 100 gallons per minute; 1 acre feet per year.

5. Purpose or Purposes for which water is used Irrigation (Domestic, irrigation, municipal, manufacturing, industrial, etc.)

6. Description of Well: Depth 140 feet. Type DRILLED (Dug or drilled)

diameter 8 inches. Elevation of ground at well site 80 feet, mean sea level (As near as known)

Depth to water table 20 feet.

7. Capacity of Well: 260 g.p.m. with 100 feet drawdown.

g.p.m. with 90 feet drawdown.

Date of test August 6 1953

If Flowing Well: Measured discharge g.p.m. on (Date)

Shut-in pressure at ground surface lbs. per sq. in. on (Date)

Water is controlled by (Cap, valve, etc.)

8. Casing: (Give diameter, commercial specifications and depth below ground surface of each casing size.)

8 inch diameter STEEL CASING from 0 to 140 feet
 inch diameter from 0 to feet
 inch diameter from to feet
 inch diameter from to feet

Describe and show depth of shoe, plug, adapter, liner or other details:

9. Perforated Casings or Screens:

(Number per foot and size of perforations, or describe screen) from 130 to 138
 from to
 from to
 from to

10. Log of Well: (Describe each stratum or formation clearly, indicate if water bearing, and give thickness and depth as indicated.)

MATERIAL	Thickness (Feet)	Depth to Bottom (Feet)
20 20 feet clay & sand		
40 " grey clay		
35 " BLUE clay		
45 " SAND & GRAVEL		

If log of well is not available, give name and address of driller.

11. Infiltration Trench: Covered or open _____

Dimensions: Length _____ ft. Minimum depth _____ ft. Maximum depth _____ ft.

Bottom width _____ ft. Discharge _____ g.p.m. Date of test _____

12. Tunnel: Type of lining _____

Dimensions: _____
(Length, course, and cross sectional size)

Position of water bearing stratum with reference to portal of tunnel _____

Log of tunnel: (Preceding table for log of well may be used, if desired. Give footage from portal and character of materials, as pertinent.)

13. Pumping Equipment:

(a) Pump *lineshaft TURBINE PUMP* Capacity *100* g.p.m.
(Make, type and size)

(b) Motor *Jacuzzi* *15*
(Type and horsepower)

14. Location of area irrigated or to be irrigated, or place of use if for purposes other than irrigation.

Township North or South	Range E. or W. of Willamette Meridian	Section	Forty-acre Tract	Number Acres To Be Irrigated	Date of Reclamation
5 S	7 W	3	NW $\frac{1}{4}$ SW $\frac{1}{4}$	32 acres Total	8-14-53
"	"	"	NW $\frac{1}{4}$ of SW $\frac{1}{4}$	30 "	" " "
"	"	"	NE $\frac{1}{4}$ of SW $\frac{1}{4}$	2 "	" " "
				32 Total	

15. If the ground water supply is supplemental to an existing water supply, identification of any application for a permit, permit, certificate or adjudicated right to appropriate water made or held by the registrant.

Township 5 South Range 1 West, W.M.
North

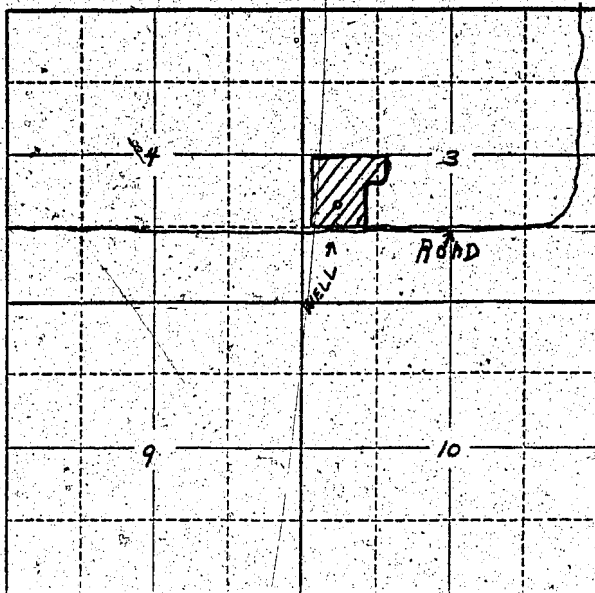

Locate well and acreage of irrigated land on plat.

Scale: 2" = 1 Mile

STATE OF OREGON

County of Marion } ss.

I, Ambrose J. Hee, being first duly sworn, do hereby certify that I have read the foregoing Registration Statement and that all of the items therein contained are true to the best of my knowledge and belief.

Ambrose J. Hee
(Signature of Registrant)

Subscribed and sworn to before me this 2 day of February, 1956

My commission expires 9/27/58
Jeanette Baxter
(Notary Public)

(SEAL)

CERTIFICATE OF REGISTRATION

STATE OF OREGON

County of Marion } ss.

This is to certify that the foregoing Registration Statement was received in the office of the State Engineer on the 12th day of December, 1955, at 10:30 o'clock A. M. and has been duly recorded in said office in Book No. 1 of Registration Statements on page GR-81C.

Construction shall be completed by 1956, and the water, completely applied to beneficial use by 1956.

Witness my hand this 12th day of April, 1956.
Lewis A. Atterley
(State Engineer)

By _____
(Deputy)