

Registration No. GR - 624

Certificate No. GR - 592

# Registration Statement

## OF CLAIMANT OF RIGHT TO APPROPRIATE GROUND WATER

TO THE STATE ENGINEER OF OREGON:

I, AMUL B. SLABY AND HELEN G. SLABY

of ROUTE 1, BOX 539, CANBY County of CLACKAMAS

State of OREGON do hereby make application for a certificate of registration as evidence of a right to appropriate ground water.

1. Source from which water is withdrawn is PUMP WELL  
(Flowing well, pump well, infiltration trench, or tunnel)

2. Location is: 2 1/2 MILES NORTHEAST OF CANBY  
(Approximate distance and direction from nearest city or town)

~~corner of the Job~~  
and is more particularly described as follows: 1180 feet north of the southwest corner of the Joseph Parrott DLC. along the west boundary of

(a) said DLC, thence east 1,277 feet  
(Give distance and bearing to corner of section or other legal subdivision)

being within SW 1/4 of NW 1/4 of Sec. 26, Twp. 3 S, Rge. 1 E  
(Smallest legal subdivision) (N. or S.) (E. or W.)

or (b) within limits of recorded platted property, town or city:

in Lot \_\_\_\_\_, Block \_\_\_\_\_ of \_\_\_\_\_  
(Name of plat or addition)

County of \_\_\_\_\_  
(If within city or town, give name)

3. Construction Work was begun on APRIL 1, 1955; was completed on APRIL 10, 1955  
(Date) (Date)

and the ground water claimed was first used for the purposes set out below on JUNE 23, 1955  
(Date)

since which time the water has been used CONTINUOUSLY  
(Continuously or Intermittently)

from JUNE 23, 1955 to PRESENT  
(Date) (Date)

4. Quantity of water claimed and used is 52 gallons per minute; \_\_\_\_\_ acre feet per year.

5. Purpose or Purposes for which water is used IRRIGATION AND DOMESTIC  
(Domestic, irrigation, municipal, manufacturing, industrial, etc.)

6. Description of Well: Depth 230 feet. Type DRILLED  
(Dig or drilled)

diameter 6 inches. Elevation of ground at well site 190 feet, mean sea level.  
(As near as known)

Depth to water table 99 feet.

7. Capacity of Well: 76 g.p.m. with 37 feet drawdown. 5 1/2 hours test

200 g.p.m. with 100 feet drawdown.

Date of test APRIL 10, 1955

If Flowing Well: Measured discharge \_\_\_\_\_ g.p.m. on \_\_\_\_\_  
(Date)

Shut-in pressure at ground surface \_\_\_\_\_ lbs. per sq. in. on \_\_\_\_\_  
(Date)

Water is controlled by \_\_\_\_\_  
(Cap, valve, etc.)

8. Casing: (Give diameter, commercial specifications and depth below ground surface of each casing size.)

6 inch diameter STANDARD from 0 to 173 feet  
 inch diameter from to feet  
 inch diameter from to feet  
 inch diameter from to feet

Describe and show depth of shoe, plug, adapter, liner or other details:

9. Perforated Casings or Screens:

NONE from to  
 (Number per foot and size of perforations, or describe screen)  
 from to  
 from to  
 from to

10. Log of Well: (Describe each stratum or formation clearly, indicate if water bearing, and give thickness and depth as indicated.)

MATERIAL	Thickness (Feet)	Depth to Bottom (Feet)
SOIL AND SAND	23	23
SAND, GRAVEL AND CLAY	67	90
FINE SAND AND SILT	1	91
CLAY	63	154
WEATHERED ROCK	15	169
BROKEN BASALT	4	173
BASALT ROCK	43	216
WEATHERED AND ROTTEN ROCK (WATER BEARING)	12	228
BLACK BASALT	2	230

If log of well is not available, give name and address of driller. ....

11. Infiltration Trench: Covered or open .....

Dimensions: Length ..... ft. Minimum depth ..... ft. Maximum depth ..... ft.

Bottom width ..... ft. Discharge ..... g.p.m. Date of test .....

12. Tunnel: Type of lining .....

Dimensions: .....  
(Length, course, and cross sectional size)

Position of water bearing stratum with reference to portal of tunnel .....

Log of tunnel: (Preceding table for log of well may be used, if desired. Give footage from portal and character of materials, as pertinent.)

13. Pumping Equipment:

- (a) Pump SUMO SUBMERSIBLE <sup>TYPE 7 CL5</sup> 4.7 H.P. Capacity 52 g.p.m.  
(Make, type and size)
- (b) Motor 3 PHASE, 210 VOLT, 60 CYCLE, 4.7 H.P.  
(Type and horsepower)

14. Location of area irrigated or to be irrigated, or place of use if for purposes other than irrigation.

Township North or South	Range E. or W. of Willamette Meridian	Section	Forty-acre Tract	Number Acres To Be Irrigated	Date of Reclamation
3.S	1.E	26	SW 1/4 of NW 1/4	11 ACRES	JUNE 23, 1955

15. If the ground water supply is supplemental to an existing water supply, identification of any application for a permit, permit, certificate or adjudicated right to appropriate water made or held by the registrant.

Township 35 Range 1E, W.M.  
North

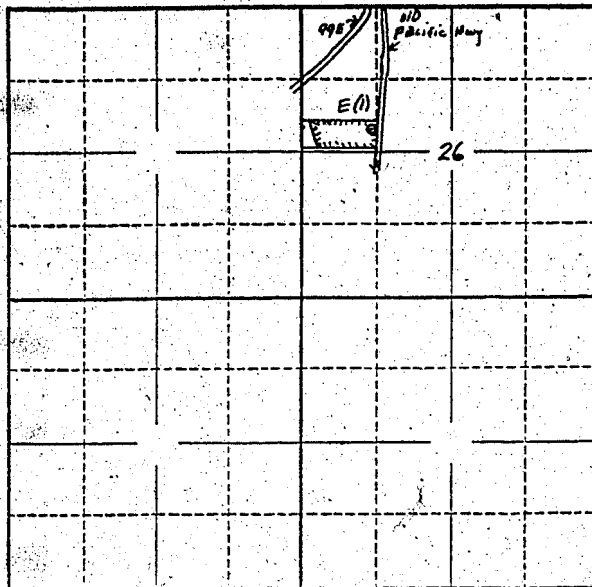

Locate well and acreage of irrigated land on plat.  
Scale: 2" = 1 Mile

STATE OF OREGON

County of CLACKAMAS } ss.

I, AMIL R. SLABY  
HELEN G. SLABY, being first duly sworn, do hereby certify that I have read the foregoing Registration Statement and that all of the items therein contained are true to the best of my knowledge and belief.

*Amil R. Slaby*  
*Helen G. Slaby*  
(Signature of Registrant)

Subscribed and sworn to before me this 21<sup>st</sup> day of September, 1957

My commission expires April 12<sup>th</sup> 1958 Wm. A. Hawthorth  
(Notary Public)

(SEAL)

**CERTIFICATE OF REGISTRATION**

STATE OF OREGON }  
County of Marion } ss.

This is to certify that the foregoing Registration Statement was received in the office of the State Engineer on the 23rd day of September, 1957, at 1:00 o'clock P. M. and has been duly recorded in said office in Book No. 4 of Registration Statements on page GR-592 C.

Witness my hand this 16th day of October, 1957.

\$15.00

*Lewis A. Stanley*  
(State Engineer)  
By \_\_\_\_\_  
(Deputy)