

Registration Statement CERTIFICATE NO. GR-599

OF CLAIMANT OF RIGHT TO APPROPRIATE GROUND WATER

(Under Chapter 708, Oregon Laws 1955.)

TO THE STATE ENGINEER OF OREGON:

I, Vincent J. Court  
of Alt. Box 319 Hoodlum County of Mason  
State of Oregon do hereby make application for a certificate of registration as evidence  
of a right to appropriate ground water.

1. Source from which water is withdrawn is pump well  
(Flowing well, pump well, infiltration trench, or tunnel)

2. Location is: 6 miles North West of Hoodlum  
(Approximate distance and direction from nearest city or town)

and is more particularly described as follows:

(a) 36 Chains S. of 1 Chain West from NE Corner Section 34  
(Give distance and bearing to corner of section or other legal subdivision)

being within SE 1/4 NE 1/4 of Sec. 34, Twp. 45, Rge. 2 W  
(Smallest legal subdivision) (N. or S.) (E. or W.)

or (b) within limits of recorded platted property, town or city:

in Lot \_\_\_\_\_, Block \_\_\_\_\_ of \_\_\_\_\_  
(Name of plat or addition)

\_\_\_\_\_ County of \_\_\_\_\_  
(If within city or town, give name)

3. Construction Work was begun on March 20 - 1952; was completed on April 4 - 1952  
(Date) (Date)

and the ground water claimed was first used for the purposes set out below on April 20 - 1952  
(Date)

since which time the water has been used Continuously during season  
(Continuously or Intermittently)

from April 20 - 1952 to Oct 5 - 1952  
(Date) (Date)

4. Quantity of water claimed and used is 150 gallons per minute; \_\_\_\_\_ acre  
feet per year.

5. Purpose or Purposes for which water is used Irrigation

(Domestic, irrigation, municipal, manufacturing, industrial, etc.)

6. Description of Well: Depth 80 feet. Type Drilled  
(Dug or drilled)

diameter 8 inches. Elevation of ground at well site \_\_\_\_\_ feet, mean sea level.  
(As near as known)

Depth to water table \_\_\_\_\_ feet.

7. Capacity of Well: 350 g.p.m. with 40 feet drawdown.

\_\_\_\_\_ g.p.m. with \_\_\_\_\_ feet drawdown.

Date of test April 17 - 1952

If Flowing Well: Measured discharge \_\_\_\_\_ g.p.m. on \_\_\_\_\_  
(Date)

Shut-in pressure at ground surface \_\_\_\_\_ lbs. per sq. in. on \_\_\_\_\_  
(Date)

Water is controlled by \_\_\_\_\_  
(Cap, valve, etc.)

8. Casing: (Give diameter, commercial specifications and depth below ground surface of each casing size.)

8 inch diameter ..... from ~~surface~~ to 78'-1" feet  
..... inch diameter ..... from ..... to ..... feet  
..... inch diameter ..... from ..... to ..... feet  
..... inch diameter ..... from ..... to ..... feet

Describe and show depth of shoe, plug, adapter, liner or other details: .....

*U.S. K. M. W. N.*

9. Perforated Casings or Screens:

..... from ..... to .....  
(Number per foot and size of perforations, or describe screen)  
..... from ..... to .....  
..... from ..... to .....  
..... from ..... to .....

10. Log of Well: (Describe each stratum or formation clearly, indicate if water bearing, and give thickness and depth as indicated.)

MATERIAL	Thickness (Feet)	Depth to Bottom (Feet)
Surface	14	14
Surface Sand muddy	4	18
Yellow Clay	32	48
Black Sand	1	49
Blue Clay	30	79
Black Sand	1	80

If log of well is not available, give name and address of driller. J. T. MILLER

11. Infiltration Trench: Covered or open                       
 Dimensions: Length                      ft. Minimum depth                      ft. Maximum depth                      ft.  
 Bottom width                      ft. Discharge                      g.p.m. Date of test                     

12. Tunnel: Type of lining                       
 Dimensions:                       
(Length, course, and cross sectional size)  
 Position of water bearing stratum with reference to portal of tunnel                     

Log of tunnel: (Preceding table for log of well may be used, if desired. Give footage from portal and character of materials, as pertinent.)

13. Pumping Equipment:  
 (a) Pump Pacific (Make, type and size) Capacity 100 g.p.m.  
 (b) Motor General Electric (Type and horsepower) 7 1/2 H.P.

14. Location of area irrigated or to be irrigated, or place of use if for purposes other than irrigation.

Township North or South	Range E. or W. of Willamette Meridian	Section	Forty-acre Tract	Number Acres To Be Irrigated	Date of Reclamation
T 4 S	2 W	34	SE 1/4 NE 1/4	2	4-20-52
"	"	34	NE 1/4 SE 1/4	2	"
"	"	35	SW 1/4 NW 1/4	16	"
"	"	35	NW 1/4 SW 1/4	9	"
				<u>27</u>	

15. If the ground water supply is supplemental to an existing water supply, identification of any application for a permit, permit, certificate or adjudicated right to appropriate water made or held by the registrant?

Township 45 Range 2W, W.M.

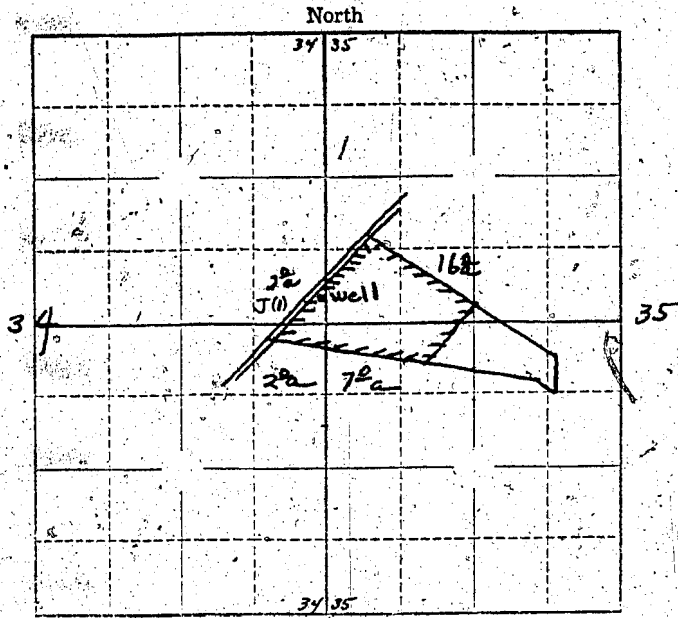

Locate well and acreage of irrigated land on plat.

Scale:  $\frac{1}{4}$ " = 1 Mile

STATE OF OREGON

County of Marion

I, Vincent H. Enock, being first duly sworn, do hereby certify that I have read the foregoing Registration Statement and that all of the items therein contained are true to the best of my knowledge and belief.

Vincent H. Enock  
(Signature of Registrant)

Subscribed and sworn to before me this 26th day of September 19 57

My commission expires June 12th 1961

Wm. S. Bartholomew  
(Notary Public)

(SEAL)

**CERTIFICATE OF REGISTRATION**

STATE OF OREGON

County of Marion

This is to certify that the foregoing Registration Statement was received in the office of the State Engineer on the 26th day of September, 19 57 at 8:00 o'clock A. M. and has been duly recorded in said office in Book No. 4 of Registration Statements on page GR-599 C.

~~Construction shall be completed by~~ ~~beneficial use by~~

Witness my hand this 16th day of October 19 57

Lewis A. Shirley  
(State Engineer)

By \_\_\_\_\_ (Deputy)

GR-599 C