

Registration Statement

OF CLAIMANT OF RIGHT TO APPROPRIATE GROUND WATER

TO THE STATE ENGINEER OF OREGON:

I, C. H. and Emma Morse

of Rt. 3, Box 1021, Albany County of Linn
(Mailing address)

State of Oregon do hereby make application for a certificate of registration as evidence of a right to appropriate ground water.

1. Source from which water is withdrawn is pump well
(Flowing well, pump well, infiltration trench, or tunnel)

2. Location is: 2 1/2 miles south of Albany, Oregon
(Approximate distance and direction from nearest city or town)

and is more particularly described as follows:

(a) 198' N. and 792' W. of SE corner S. 24, T. 11 S., R. 4 W.
(Give distance and bearing to corner of section or other legal subdivision)

being within SE 1/4 of SE 1/4 of Sec. 24, Twp. 11 S. Rge. 4 W.
(Smallest legal subdivision) (N. or S.) (E. or W.)

or (b) within limits of recorded platted property, town or city:

in Lot 3, Block of
(Name of plat or addition)

County of Linn
(If within city or town, give name)

3. Construction Work was begun on August 12, 1951; was completed on August 15, 1951
(Date) (Date)

and the ground water claimed was first used for the purposes set out below on July 10, 1952
(Date)

since which time the water has been used continuously
(Continuously or intermittently)

from July 10, 1952 to present time
(Date) (Date)

4. Quantity of water claimed and used is 56 gallons per minute; 21 acre feet per year.

5. Purpose or Purposes for which water is used Irrigation

(Domestic, irrigation, municipal, manufacturing, industrial, etc.)

6. Description of Well: Depth 52 feet. Type Drilled

(Dug or drilled)

diameter 6 inches. Elevation of ground at well site 215 225 feet, mean sea level.
(As near as known)

Depth to water table 20 feet.

7. Capacity of Well: 125 g.p.m. with 15 feet drawdown.

 g.p.m. with feet drawdown.

Date of test Not tested - estimated

If Flowing Well: Measured discharge g.p.m. on

(Date)

Shut-in pressure at ground surface lbs. per sq. in. on

(Date)

Water is controlled by

(Cap, valve, etc.)

8. Casing: (Give diameter, commercial specifications and depth below ground surface of each casing size.)

6 inch diameter steel casing from 0 to 52 feet
 inch diameter from to feet
 inch diameter from to feet
 inch diameter from to feet

Describe and show depth of shoe, plug, adapter, liner or other details:

9. Perforated Casings or Screens:

Slot perforations from 40 to 52
(Number per foot and size of perforations, or describe screen)
 from to
 from to
 from to

10. Log of Well: (Describe each stratum or formation clearly, indicate if water bearing, and give thickness and depth as indicated.)

MATERIAL	Thickness (Feet)	Depth to Bottom (Feet)
Not available		

If log of well is not available, give name and address of driller. Bill Hamilton Well Drilling Co.,
638 E. 3rd Ave., Albany, Oregon

11. Infiltration Trench: Covered or open
 Dimensions: Length ft. Minimum depth ft. Maximum depth ft.
 Bottom width ft. Discharge g.p.m. Date of test

12. Tunnel: Type of lining
 Dimensions:
(Length, course, and cross sectional size)
 Position of water bearing stratum with reference to portal of tunnel

Log of tunnel: (Preceding table for log of well may be used, if desired. Give footage from portal and character of materials, as pertinent.)

13. Pumping Equipment:
 (a) Pump Juccuzzi Deep Well Jet Capacity 100 g.p.m.
(Make, type and size)
 (b) Motor 2 H. P. electric
(Type and horsepower)

14. Location of area irrigated or to be irrigated, or place of use if for purposes other than irrigation.

Township North or South	Range E. or W. of Willamette Meridian	Section	Forty-acre Tract	Number Acres To Be Irrigated	Date of Reclamation
11 S	4 W.	24	SE $\frac{1}{4}$ of SE $\frac{1}{4}$	8.4	July 10, 1952

15. If the ground water supply is supplemental to an existing water supply, identification of any application for a permit, permit, certificate or adjudicated right to appropriate water made or held by the registrant.

Township 11 S Range 4 W W.M. 9
North

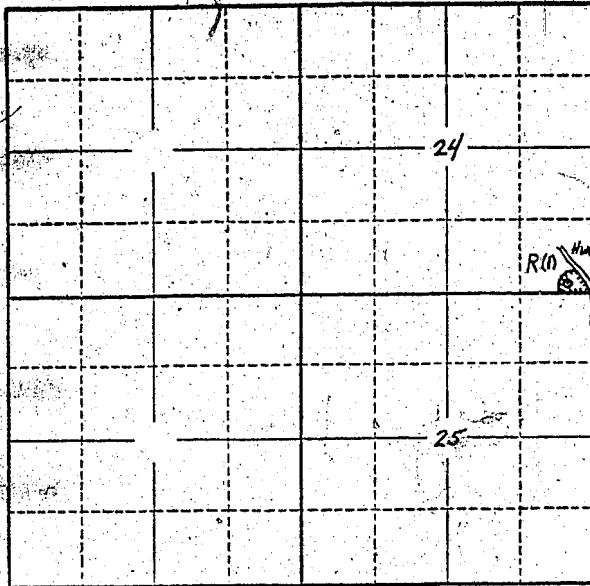

Locate well and acreage of irrigated land on plat.
Scale: 2" = 1 Mile

STATE OF OREGON }
County of Linn } ss.

I, C. H. and Emma Morse, being first duly sworn, do hereby certify that I have read the foregoing Registration Statement and that all of the items therein contained are true to the best of my knowledge and belief.

C. H. and Emma Morse
Emma Morse

(Signature of Registrant)

Subscribed and sworn to before me this 24 day of Sept, 1957

My commission expires 1/18/58

Robert L. Jupp
(Notary Public)

(SEAL)

CERTIFICATE OF REGISTRATION

STATE OF OREGON }
County of Marion } ss.

This is to certify that the foregoing Registration Statement was received in the office of the State Engineer on the 27th day of September, 1957, at 8:00 o'clock A. M. and has been duly recorded in said office in Book No. 4 of Registration Statements on page GR-597 C.

Witness my hand this 16th day of October, 1957

Lewis A. Stanley
(State Engineer)

By _____ (Deputy)

GR - 597 C

\$15.00