

Registration No. GR: 644

Certificate No. GR. 609

Registration Statement

OF CLAIMANT OF RIGHT TO APPROPRIATE GROUND WATER

TO THE STATE ENGINEER OF OREGON:

I, J. R. Dant
of 3825 S.W. Barnes Road, Portland County of Washington
(Mailing address)

State of Oregon, do hereby make application for a certificate of registration as evidence of a right to appropriate ground water.

- Source from which water is withdrawn is Pump Well
(Flowing well, pump well, infiltration trench, or tunnel)
- Location is: 5 miles West of Portland
(Approximate distance and direction from nearest city or town)

and is more particularly described as follows:

(a) 850 feet South and 880 feet West of 1/2 Corner on East Line, Section 2
(Give distance and bearing to corner of section or other legal subdivision)
being within Northeast 1/2 of Southeast 1/2 of Sec. 2, Twp. 1 S., Rge. 1 W.
(Smallest legal subdivision) (N. or S.) (E. or W.)

(b) within limits of recorded platted property, town or city:
in Lot _____, Block _____ of _____
(Name of plat or addition)
County of Washington
(If within city or town, give name)

3. Construction Work was begun on October 29, 1941; was completed on April 10, 1942
(Date) (Date)
and the ground water claimed was first used for the purposes set out below on December 1952
(Date)
since which time the water has been used Intermittently
(Continuously or Intermittently)
from December 1952 to Present (August, 1957)
(Date) (Date)

4. Quantity of water claimed and used is 50 gallons per minute; _____ acre feet per year.

5. Purpose or Purposes for which water is used Farm Irrigation
(Domestic, irrigation, municipal, manufacturing, industrial, etc.)

6. Description of Well: Depth 907 feet. Type Drilled
(Dug or drilled)
diameter 8 inches. Elevation of ground at well site 490 (Approx.) feet, mean sea level.
(As near as known)
Depth to water table 322 feet.

7. Capacity of Well: 50 g.p.m. with 60 feet drawdown.
(Est.) 100 g.p.m. with 120 feet drawdown.

Date of test April 10, 1942

If Flowing Well: Measured discharge _____ g.p.m. on _____
(Date)

Shut-in pressure at ground surface _____ lbs. per sq. in. on _____
(Date)

Water is controlled by _____
(Cap, valve, etc.)

Township 1 S Range 1 W, W.M.

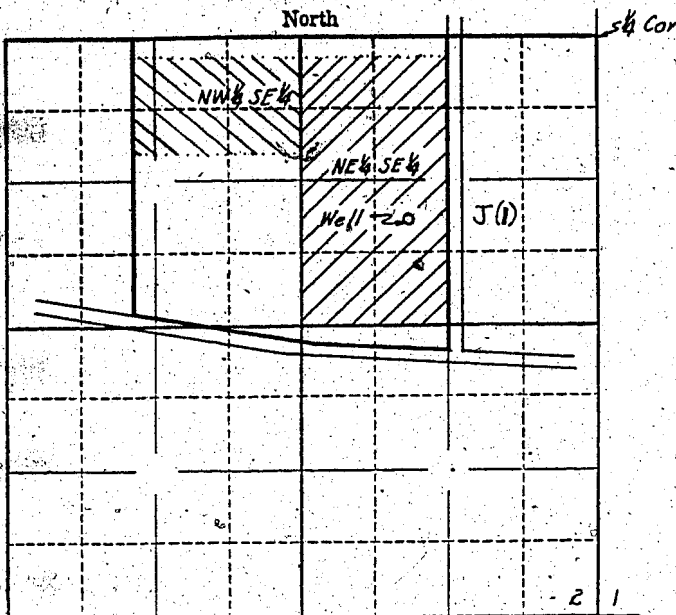

Locate well and acreage of irrigated land on plat. 11 12

Scale: 1/8" = 1 Mile

STATE OF OREGON

County of Washington

ss.

I, J. R. Dant, being first duly sworn, do hereby certify that I have read the foregoing Registration Statement and that all of the items therein contained are true to the best of my knowledge and belief.

J. R. Dant

(Signature of Registrant)

Subscribed and sworn to before me this 10 day of September, 1957.

My commission expires 6/10/59

John D. Mason

(Notary Public)

(SEAL)

CERTIFICATE OF REGISTRATION

STATE OF OREGON

County of Marion

ss.

This is to certify that the foregoing Registration Statement was received in the office of the State Engineer on the 4th day of October, 1957, at 8:00 o'clock A. M. and has been duly recorded in said office in Book No. 4 of Registration Statements on page GR-609 C.

Witness my hand this 16th day of October, 1957.

Lewis A. Stanley

(State Engineer)

By

(Deputy)

\$15.00

GR - 609 C