

Registration No. GR 649

Certificate No. GR 632

# Registration Statement

## OF CLAIMANT OF RIGHT TO APPROPRIATE GROUND WATER

TO THE STATE ENGINEER OF OREGON:

I, Ernest J. Richards

of Rt. 1, Box 258, Albany County of Linn  
(Mailing address)

State of Oregon, do hereby make application for a certificate of registration as evidence of a right to appropriate ground water.

1. Source from which water is withdrawn is Pump well  
(Flowing well, pump well, infiltration trench, or tunnel)

2. Location is: 6 miles east of Albany, Oregon  
(Approximate distance and direction from nearest city or town)

and is more particularly described as follows:

(a) S. 87° 40' W. 22.5 chains from NE corner of S. 8, T. 11 S., R. 2 W.  
(Give distance and bearing to corner of section or other legal subdivision)  
being within NW 1/4 of NE 1/4 of Sec. 8, Twp. 11 S, Rge. 2 W.  
(Smallest legal subdivision) (N. or S.) (E. or W.)

or (b) within limits of recorded platted property, town or city:

in Lot \_\_\_\_\_, Block \_\_\_\_\_ of \_\_\_\_\_  
(Name of plat or addition)  
County of Linn  
(If within city or town, give name)

3. Construction Work was begun on August 1946; was completed on August 1946  
(Date) (Date)

and the ground water claimed was first used for the purposes set out below on April 1947  
(Date)

since which time the water has been used continuously  
(Continuously or intermittently)

from April 1947 to present time  
(Date) (Date)

4. Quantity of water claimed and used is 225 gallons per minute; 55 acre feet per year.

5. Purpose or Purposes for which water is used Irrigation

(Domestic, irrigation, municipal, manufacturing, industrial, etc.)

6. Description of Well: Depth 30 feet. Type Drilled  
(Dug or drilled)

diameter 12 inches. Elevation of ground at well site 260 feet, mean sea level.  
(As near as known)

Depth to water table 90 feet.

7. Capacity of Well: 350 g.p.m. with 13 feet drawdown.

\_\_\_\_\_ g.p.m. with \_\_\_\_\_ feet drawdown.

Date of test Not tested - estimated

If Flowing Well: Measured discharge \_\_\_\_\_ g.p.m. on \_\_\_\_\_  
(Date)

Shut-in pressure at ground surface \_\_\_\_\_ lbs. per sq. in. on \_\_\_\_\_  
(Date)

Water is controlled by \_\_\_\_\_  
(Cap, valve, etc.)

8. Casing: (Give diameter, commercial specifications and depth below ground surface of each casing size.)

12 inch diameter **steel casing** from 0 to 30 feet  
 inch diameter from to feet  
 inch diameter from to feet  
 inch diameter from to feet

Describe and show depth of shoe, plug, adapter, liner or other details:  
 .....  
 .....

9. Perforated Casings or Screens:

**Slot perforations** from 11 to 30  
 (Number per foot and size of perforations, or describe screen)  
 from to  
 from to  
 from to

10. Log of Well: (Describe each stratum or formation clearly, indicate if water bearing, and give thickness and depth as indicated.)

MATERIAL	Thickness (Feet)	Depth to Bottom (Feet)
Not available		

If log of well is not available, give name and address of driller. **Bill Hamilton Drilling Co.,**  
**838 E. 3rd Ave., Albany, Oregon.**

11. Infiltration Trench: Covered or open \_\_\_\_\_  
Dimensions: Length \_\_\_\_\_ ft. Minimum depth \_\_\_\_\_ ft. Maximum depth \_\_\_\_\_ ft.

Bottom width \_\_\_\_\_ ft. Discharge \_\_\_\_\_ g.p.m. Date of test \_\_\_\_\_

12. Tunnel: Type of lining \_\_\_\_\_

Dimensions: \_\_\_\_\_  
(Length, course, and cross sectional size)

Position of water bearing stratum with reference to portal of tunnel \_\_\_\_\_

Log of tunnel: (Preceding table for log of well may be used, if desired. Give footage from portal and character of materials, as pertinent.)

13. Pumping Equipment:

(a) Pump **2<sup>nd</sup> Pacific centrifugal** Capacity **225** g.p.m.  
(Make, type and size)

(b) Motor **10 H. P. electric**  
(Type and horsepower)

14. Location of area irrigated or to be irrigated, or place of use if for purposes other than irrigation.

Township North or South	Range E. or W. of Willamette Meridian	Section	Forty-acre Tract	Number Acres To Be Irrigated	Date of Reclamation
11 S	2 W	8	NW $\frac{1}{4}$ of NE $\frac{1}{4}$	11.0	April 1947
11 S	2 W	8	NE $\frac{1}{4}$ of NE $\frac{1}{4}$	11.0	April 1947
				<u>22.0</u>	

15. If the ground water supply is supplemental to an existing water supply, identification of any application for a permit, permit, certificate or adjudicated right to appropriate water made or held by the registrant.

Township 11 S Range 2 W, W.M.  
North

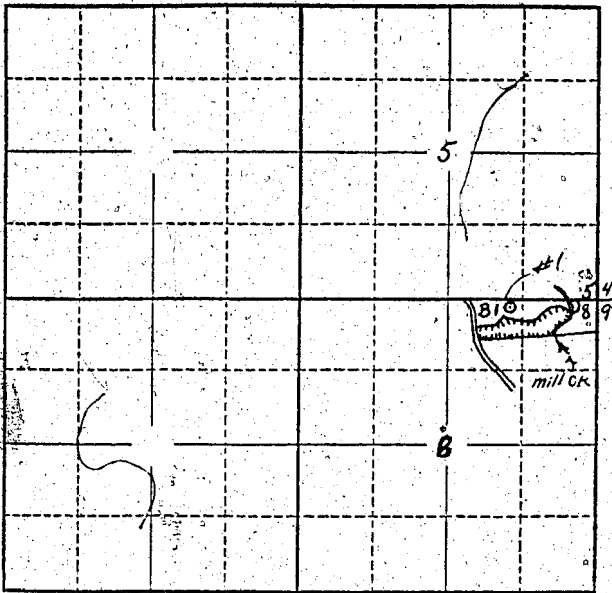

So. Santiam R.

Locate well and acreage of irrigated land on plat.

Scale: 2" = 1 Mile

STATE OF OREGON

County of Linn

ss.

I, Ernest J. Richards, being first duly sworn, do hereby certify that I have read the foregoing Registration Statement and that all of the items therein contained are true to the best of my knowledge and belief.

Ernest J. Richards  
(Signature of Registrant)

Subscribed and sworn to before me this 3rd day of October, 1957

My commission expires

James H. Hahn  
(Notary Public)

(SEAL)

### CERTIFICATE OF REGISTRATION

STATE OF OREGON

County of Marion

ss.

This is to certify that the foregoing Registration Statement was received in the office of the State Engineer on the 14th day of October, 1957, at 8:00 o'clock A. M. and has been duly recorded in said office in Book No. 4 of Registration Statements on page GR-632 C

Witness my hand this 27th day of November, 1957

LEWIS A. STANLEY  
(State Engineer)

By N. G. P. Rogers  
(Deputy)

\$15.00

GR - 632 C