

RECEIVED
DEC 27 1955

STATE ENGINEER
SALEM, OREGON

REGIS:

GR-68

CERTIFICATE NO.

GR-75

Registration Statement

OF CLAIMANT OF RIGHT TO APPROPRIATE GROUND WATER

(Under Chapter 708, Oregon Laws 1955.)

TO THE STATE ENGINEER OF OREGON:

I, Charles K. Fulton and Helen C. Fulton

of Rt. 3 Box 642, Salem County of Marion

State of Oregon, do hereby make application for a certificate of registration as evidence of a right to appropriate ground water.

1. Source from which water is withdrawn is Pump well
(Flowing well, pump well, infiltration trench, or tunnel)

2. Location is: 3 miles south & west of Salem on the
Crocker creek road approx. 70 miles up creek from the
and is more particularly described as follows: South 70 river road.

(a) See attached legal description of location plat
(Give distance and bearing to corner of section or other legal subdivision)

being within S. E 1/4 of SE 1/4 of Sec. 5, Twp. 8, Rge. 3W
(Smallest legal subdivision) (N. or S.) (E. or W.)

or (b) within limits of recorded platted property, town or city: _____

in Lot _____, Block _____ of _____
(Name of plat or addition)

County of _____
(If within city or town, give name)

3. Construction Work was begun on Feb. 1951; was completed on Feb. 1951
(Date) (Date)

and the ground water claimed was first used for the purposes set out below on May 1951
(Date)

since which time the water has been used continuously
(Continuously or intermittently)

from May 1951 to Oct. 1955
(Date) (Date)

4. Quantity of water claimed and used is 150 gallons per minute; 7 acre
feet per year.

5. Purpose or Purposes for which water is used irrigation
(Domestic, irrigation, municipal, manufacturing, industrial, etc.)

6. Description of Well: Depth 67 feet. Type Drilled
(Dug or drilled)

diameter 8 inches. Elevation of ground at well site 200 feet, mean sea level.
(As near as known)

Depth to water table 67 feet.
Bailer test

7. Capacity of Well: 125 g.p.m. with 25' feet drawdown. only test made and
left g.p.m. with _____ feet drawdown. was all the water
Bailer could make.

Date of test Feb. 1951

If Flowing Well: Measured discharge _____ g.p.m. on _____
(Date)

Shut-in pressure at ground surface _____ lbs. per sq. in. on _____
(Date)

Water is controlled by _____
(Cap, valve, etc.)

8. Casing: (Give diameter, commercial specifications and depth below ground surface of each casing size.)

2. inch diameter from 1 to 49 feet
 inch diameter from to feet
 inch diameter from to feet
 inch diameter from to feet

Describe and show depth of shoe, plug, adapter, liner or other details:

See Log. attached

9. Perforated Casings or Screens:

none from to
 (Number per foot and size of perforations, or describe screen)

..... from to
 from to
 from to

10. Log of Well: (Describe each stratum or formation clearly, indicate if water bearing, and give thickness and depth as indicated.)

See attached Log of Driller.

MATERIAL	Thickness (Feet)	Depth to Bottom (Feet)
<i>Also two attached logs for wells of domestic use which I wish put on record only.</i>		

If log of well is not available, give name and address of driller.

See attached Log

11. Infiltration Trench: Covered or open _____
 Dimensions: Length _____ ft. Minimum depth _____ ft. Maximum depth _____ ft.
 Bottom width _____ ft. Discharge _____ g.p.m. Date of test _____
12. Tunnel: Type of lining _____
 Dimensions: _____
(Length, course, and cross sectional size)
 Position of water bearing stratum with reference to portal of tunnel _____

Log of tunnel: (Preceding table for log of well may be used, if desired. Give footage from portal and character of materials, as pertinent.)

13. Pumping Equipment:
- (a) Pump _____ *1 1/2 H.P.* Capacity *65 gal per M. @ 50 ft.*
(Make, type and size)
- (b) Motor *Electric* _____
(Type and horsepower)

14. Location of area irrigated or to be irrigated, or place of use if for purposes other than irrigation.

Township North or South	Range E. or W. of Willamette Meridian	Section	Forty-acre Tract	Number Acres To Be Irrigated	Date of Reclamation
<i>85</i>	<i>BW</i>	<i>5</i>	<i>SE 1/4</i> <i>SE 1/4 of SE 1/4</i>	<i>7 +</i>	<i>1952</i>

Begin at a point N. 70° 45' E
 18.38 chains from S.E. corner Henry
 Croisent D. L. C. #48, then N. 70° 45' E.
 1.788 chains to a point, then N. 82°
 15' W. 192 feet to a point, then S.
 70° 45' W. 27 feet to well.

15. If the ground water supply is supplemental to an existing water supply, identification of any application for a permit, permit, certificate or adjudicated right to appropriate water made or held by the registrant.

Township 85 North Range 3 West W.M.
North Sec 5 - Henry Crosscut

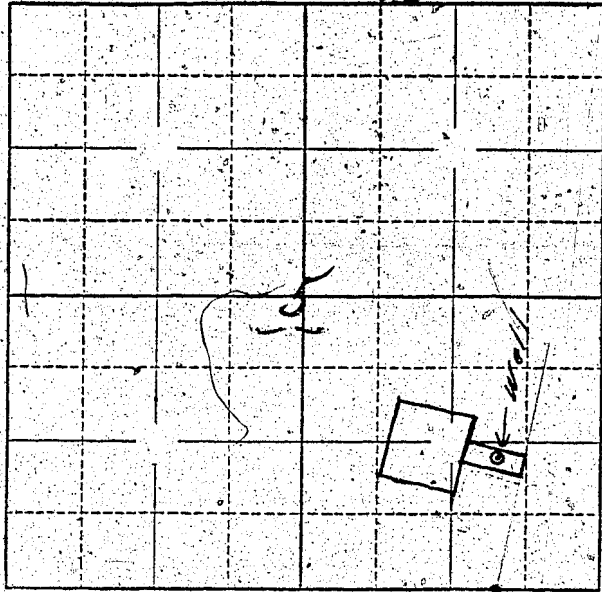

Locate well and acreage of irrigated land on plat.

Scale: 1/4 - 1 Mile

STATE OF OREGON

County of Marion

SS.

I, Charles K. Fulton, being first duly sworn, do hereby certify that I have read the foregoing Registration Statement and that all of the items therein contained are true to the best of my knowledge and belief.

Charles K. Fulton
(Signature of Registrant)

Subscribed and sworn to before me this 23rd day of Dec, 1955.

My commission expires 9/25/57

John P. Power
(Notary Public)

(SEAL)

CERTIFICATE OF REGISTRATION

STATE OF OREGON

County of Marion

SS.

This is to certify that the foregoing Registration Statement was received in the office of the State Engineer on the 28th day of December, 1955, at 1:00 o'clock P.M. and has been duly recorded in said office in Book No. 1 of Registration Statements on page 75.

Construction shall be completed by 10, and the water completely applied to beneficial use by 19.

Witness my hand this 24th day of February, 1956.

Lewis A. Stanley
(State Engineer)

By

(Deputy)