

Registration Statement

OF CLAIMANT OF RIGHT TO APPROPRIATE GROUND WATER

(Under Chapter 708, Oregon Laws 1955.)

TO THE STATE ENGINEER OF OREGON:

I, RUDOLPH PAVLINAC

of RT. 1, Box 690 - ORG. City, County of CLACKAMAS

State of OREGON, do hereby make application for a certificate of registration as evidence of a right to appropriate ground water.

1. Source from which water is withdrawn is Pump Well #1
(Flowing well, pump well, infiltration trench, or tunnel)

2. Location is: 1 1/4 miles South of Oregon City
(Approximate distance and direction from nearest city or town)

and is more particularly described as follows:

(a) S 59° E, 1405 feet from NW corner of Sec 8
(Give distance and bearing to corner of section or other legal subdivision)

being within SE 1/4 NW 1/4 NW 1/4 of Sec. 8, Twp. 3S, Rge. 2E
(Smallest legal subdivision) (N. or S.) (E. or W.)

or (b) within limits of recorded platted property, town or city:

in Lot _____, Block _____ of _____
(Name of plat or addition)

County of _____
(If within city or town, give name)

3. Construction Work was begun on Dec. 1952; was completed on Feb. 15, 1953
(Date) (Date)

and the ground water claimed was first used for the purposes set out below on MAY 1, 1956
(Date)

since which time the water has been used Continuously
(Continuously or intermittently)

from MAY 1, 1956 to Present
(Date) (Date)

4. Quantity of water claimed and used is 225 gallons per minute; _____ acre feet per year.

5. Purpose or Purposes for which water is used IRRIGATION

(Domestic, irrigation, municipal, manufacturing, industrial, etc.)

6. Description of Well: Depth 405 feet. Type DRILLED
(Dug or drilled)

diameter 8 inches. Elevation of ground at well site 425 feet, mean sea level.
(As near as known)

Depth to water table 260 feet.

7. Capacity of Well: 300 g.p.m. with 30 feet drawdown.

_____ g.p.m. with _____ feet drawdown.

Date of test MAY 1956

If Flowing Well: Measured discharge _____ g.p.m. on _____
(Date)

Shut-in pressure at ground surface _____ lbs. per sq. in. on _____
(Date)

Water is controlled by _____
(Cap, valve, etc.)

8. Casing: (Give diameter, commercial specifications and depth below ground surface of each casing size.)

8 inch diameter from ^{GROUND} Level to 405 feet
 inch diameter from to feet
 inch diameter from to feet
 inch diameter from to feet

Describe and show depth of shoe, plug, adapter, liner or other details: Driving Shoe at 405 foot level.

9. Perforated Casings or Screens:

$\frac{1}{2}$ " wide x $\frac{1}{4}$ " long - 6 per (Number per foot and size of perforations, or describe screen) from 90 to 95
 " " " " from 240 to 270
 " " " " from 362 to 390
 from to

10. Log of Well: (Describe each stratum or formation clearly, indicate if water bearing, and give thickness and depth as indicated.)

MATERIAL	Thickness (Feet)	Depth to Bottom (Feet)
Top soil	11	394
Rock, basalt	9	385
Shale, blue, brown, some sand ^{wood at 380 ft.}	385	405

If log of well is not available, give name and address of driller. Steinett

11. Infiltration Trench: Covered or open _____

Dimensions: Length _____ ft. Minimum depth _____ ft. Maximum depth _____ ft.

Bottom width _____ ft. Discharge _____ g.p.m. Date of test _____

12. Tunnel: Type of lining _____

Dimensions: _____
(Length, course, and cross sectional size)

Position of water bearing stratum with reference to portal of tunnel _____

Log of tunnel: (Preceding table for log of well may be used, if desired. Give footage from portal and character of materials, as pertinent.)

13. Pumping Equipment:

(a) Pump Berkley Turbine - 5" column Capacity 225 g.p.m.
(Make, type and size)

(b) Motor Eaton - 30 H.P.
(Type and horsepower)

14. Location of area irrigated or to be irrigated, or place of use if for purposes other than irrigation.

Township North or South	Range E. or W. of Willamette Meridian	Section	Forty-acre Tract	Number Acres To Be Irrigated	Date of Reclamation
3S	2E	8	NW ¹ / ₄ NW ¹ / ₄	22.0	May 1, 1956
3S	2E	8	NW ¹ / ₄ SW ¹ / ₄	14.5	" "
3S	2E	8	NE ¹ / ₄ NW ¹ / ₄	9.0	" "
3S	2E	8	SW ¹ / ₄ NW ¹ / ₄	19.5	" "
3S	2E	8	SE ¹ / ₄ NW ¹ / ₄	4.0	" "
3S	2E	8	NE ¹ / ₄ SW ¹ / ₄	1.5	" "
3S	2E	8	SW ¹ / ₄ SW ¹ / ₄	4.0	" "
				<u>74.5</u>	

15. If the ground water supply is supplemental to an existing water supply, identification of any application for a permit, permit, certificate or adjudicated right to appropriate water made or held by the registrant.

GR-699 B

Township 35 Range 25 W.M.
North

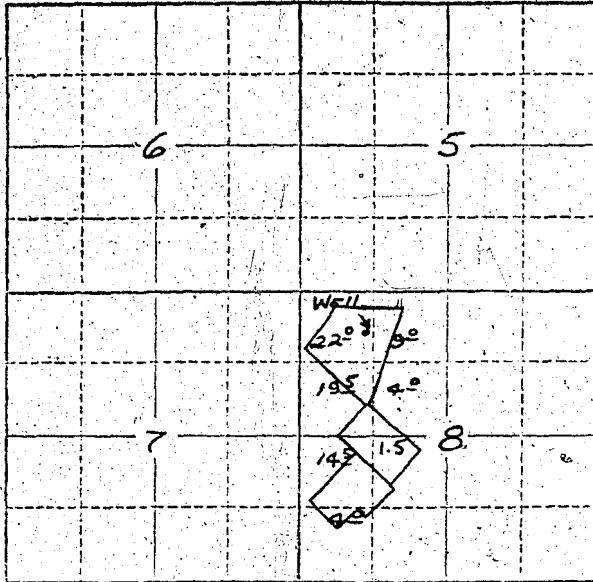

Locate well and acreage of irrigated land on plat.
Scale: 2" = 1 Mile

STATE OF OREGON

County of _____ } ss.

I, Rudolph Paulman being first duly sworn, do hereby certify that I have read the foregoing Registration Statement and that all of the items therein contained are true to the best of my knowledge and belief.

Rudolph Paulman
(Signature of Registrant)

Subscribed and sworn to before me this 18th day of November, 1957.

My commission expires June 12th 1961 Wm. S. Bartholomew
(Notary Public)

(SEAL)

CERTIFICATE OF REGISTRATION

STATE OF OREGON

County of Marion } ss.

This is to certify that the foregoing Registration Statement was received in the office of the State Engineer on the 18th day of November, 1957, at 8:00 o'clock A. M. and has been duly recorded in said office in Book No. 4 of Registration Statements on page GR-699 C.

~~Construction shall be completed by _____ 19____, and the water completely applied to beneficial use by _____ 19____.~~

Witness my hand this 24th day of January, 1958.

Lewis A. Atterley
(State Engineer)

By _____
(Deputy)

GR-699 C